

AQUAECO

WASHROOM AND PLUMBING SOLUTIONS

Installation Guide

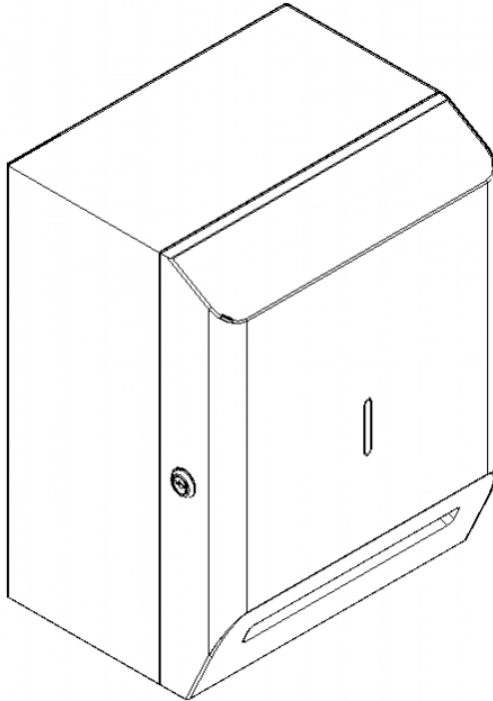

AQA-IX3-I730-XX

IX304 WALL MOUNTED TOUCHLESS ROLL PAPER TOWEL DISPENSER

A member of SANIPEXGROUP

AUTO ROLL TOWEL DISPENSER USER MANUAL

Thank you for purchasing this auto roll towel dispenser, which adopts type 304 stainless steel with stain finish, and is controlled by CPU with infrared sensor. It is steady, sensitive, and saves power. It is an ideal choice for restaurant, hotel, etc.

Features:

- ※ With stainless steel cover, it is durable, steady and easy to clean;
- ※ Adjustable length dispensed with 200mm, 250mm, and 300mm;
- ※ Accept the roll with 195–200mm wide and 200mm diameter;
- ※ Touch free, a new paper towel is dispensed as soon as the previous one is removed;
- ※ Lockable;
- ※ 1 second interval between two dispenses, avoid paper waste;
- ※ DC or AC & DC powered.

Components:

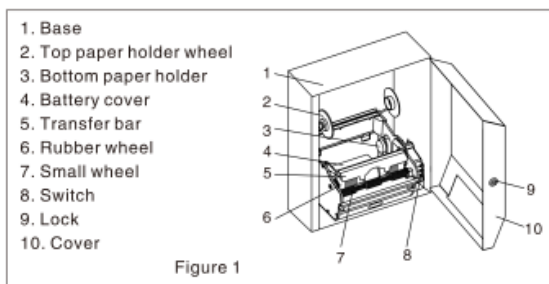

Installation:

※ Surface Installation:

Unlock the cover by the key attached, drill 4 holes of 8mm diameter as shown in Figure2, and fix the dispenser on the wall with plugs and screws attached.

※ Built-in Installation:

This product is a built-in design. Drill a space 395 × 295 × 165mm (151/2" × 113/5" × 61/2") in the wall. As shown in (Figure2), drill the holes on the wall, use the screws to fix the whole unit first, and make sure the frame of the unit is fit to the wall.

Battery Installation:

1. Open the cover of the battery box, and put 4 × LR20 batteries correctly according “+” “-”, and put back the cover.
2. If there is a roll of paper towel in the dispenser, remove it before install the batteries.
3. Remove the roll: use one hand to press down the small wheel slightly, and remove it from the rubber wheel; the other hand roll back the paper towel, and remove it.

Notes: 1.The dispenser will not work if install the batteries improperly.

2.To avoid breaking the dispenser, do not mix different kind of batteries to use.

3. When the dispenser is low battery, the indicator will flash one time per second; the dispenser can still work, but should replace the batteries. When the indicator flashes twice per second, it will stop working, have to replace the batteries.

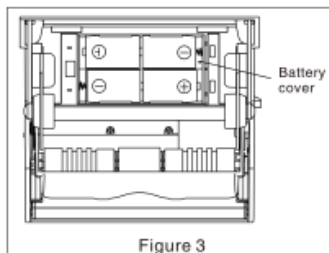
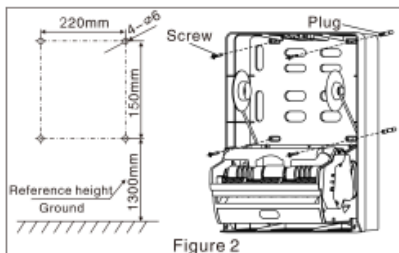

Installation of roll paper towel:

Follow Step 1 and 2 in Figure 2 to install the roll paper towel;

1. Pull the paper holder wheels from both sides slightly, and put a new roll of paper towel into it.



2. One hand lifts up the transfer bar, the other one pulls the paper towel out between the transfer bar and the rubber wheel (the distance from paper margin to rubber wheel is about 30mm), put down the transfer bar, and close the cover.

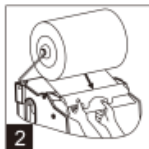

When the diameter of roll is $\leq 10\text{mm}$, follow the Step 3 and 4 to change a new roll.

3. Remove the remaining roll from the paper holder wheels



4. Put the remaining roll between the roll holders. Then follow Step 1 and 2 to install a new roll of paper towel.

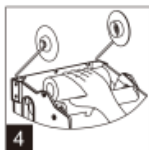

Length regulation:

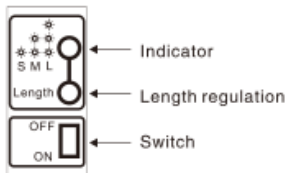

Switch on the power, use the "Length Regulation" button to adjust, there are 3 kinds of length can be chose. Every time press the button, show different length in different ways. As follows:

Dispense length	State of indicator
200mm(7 $\frac{7}{8}$ ")-S	flash one time
250mm(9 $\frac{7}{8}$ ")-M	flash two times continuously
300mm(11 $\frac{7}{8}$ ")-L	flash three times continuously

Note: When the batteries' power is in different condition, the length of paper towel dispensed will be a little bit different.

Application:

After finish the installation, switch on the power, and the auto paper towel dispenser will dispense paper towel out automatically. Then toss the paper towel from left or right, a new paper towel is dispensed as soon as the previous one is removed.

Malfunction Exclusion:

If the roll towel dispenser does not work normally, please check:

1. If the batteries are installed correctly, and if the batteries are power enough;
2. If there is something blocking the paper towel outlet;
3. If the roll is turning freely.

If the dispenser is still not working after check the 3 situations above, please contact our company or the dealers, or find a qualified electrician.

Specification:

Power: DC transformer :Input: AC 110V~/120V~/220V~/230V~/240V-
Output: DC 6V $\geq 3\text{VA}$

Battery:DC 4 \times 1.5V R20S

Paper delivering length: 200mm,250mm,300mm(7 $\frac{7}{8}$ " ,9 $\frac{7}{8}$ " ,11 $\frac{7}{8}$ ")

Accepted roll towel dimension: width $\leq 195\text{mm}-200\text{mm}$ (7 $\frac{5}{8}$ "-7 $\frac{7}{8}$ "), dia $\leq 200\text{mm}$ (7 $\frac{7}{8}$ ").

Package:

- One set of roll towel dispenser;
- One copy of user manual;
- One pack of 4pcs of $\varnothing 6\text{mm}$ plugs, 4pcs of 4 \times 25 self - thread screws, 2pcs of keys.

