

BAGNODESIGN

EXPERTLY CRAFTED BATHROOMS

Installation Guide

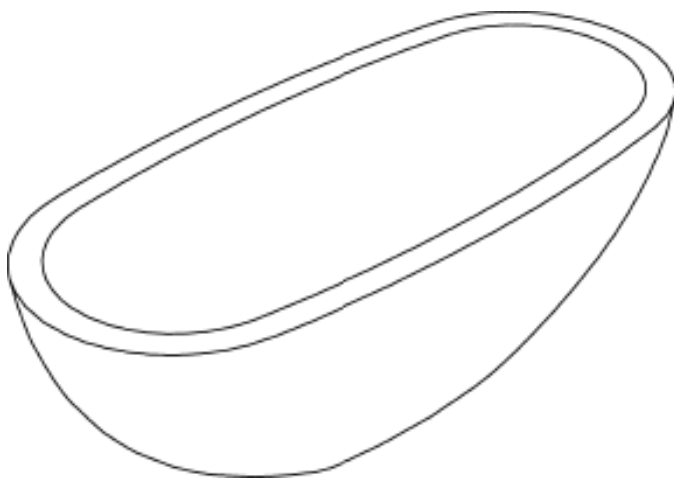

BDB-KOY-879-A-MB
KOY FREESTANDING BATHTUB 1730X850MM WITH OVERFLOW

A member of **SANIPEXGROUP**
www.sanipexgroup.com

IMPORTANT PLEASE READ

All products manufactured and supplied by BAGNODESIGN are fit for purpose as long as they are Installed, used correctly, cleaned and receive regular maintenance in accordance with these instructions...

Remove all packaging and check the product for damage or missing parts before commencing with the installation.

Any alterations made to this product and its components may infringe product certification, infringe water regulations and invalidate the guarantee. The Installation must comply with all local/national water supply authority regulations/bylaws and building and plumbing regulations, therefore we strongly recommend that your product be installed by a reputable qualified trade's person.

PRODUCT LIFECYCLE

"The product LiveCyclele is the collective stages that a product goes through from its conception and design through to its ultimate disposal."

DISPOSAL GUIDANCE

The best way to ensure your Product has a long life is to follow the Care and Maintenance guides set by the Manufacture after purchase. This document can be found at www.sanipexgroup.com.

The life cycle of the product is not in correlation to the product Guarantee; the standards the products are manufactured or certified to (e.g. CE & WRAS) can exceed past the Guarantee duration. After the life cycle of the product is deemed complete by the end-user please follow the below to dispose of the items correctly...

CLEANING CARE GUIDE

Only use a mild soap and water for cleaning.
Rinse with water to remove the mild soap solution.
We recommend the product is dried using a soft cloth after every use.

Never use any abrasive or strong cleaning products containing, bleaches, acids (hydrochloric, formic, phosphorus, chlorine or acetic), strong detergents, limescale remover, alcohol or dyes etc.

Never use abrasive cleaning pads, wire wool or microfibre cloths.
Never use cleaning equipment that may have been pre-used and contaminated with the above substances.

Never apply the cleaning product directly onto the finished surface.

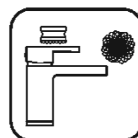

PACKAGE CONTENTS

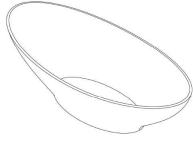

1x freestanding bath



1x Flex waste
connector Kit



1x Click -Clack

Carefully read through all instructions

- Each bath will come packed in a protective packaging bag (combi bag).
- Ensure to use the supplied straps to lift and move your product. Failure to do so may result in damage to your product, if not properly handled.
- Your product must be installed by a competent, qualified plumber.
- Carefully remove the bath from the box and the bag taking care not to drag or scratch any part of the bath's exposed surfaces.

Do not remove the protective packaging on the edge/rim of the bath until the
 installation is complete.

- Flexible waste connector kit. **NB.** The male and female ends must be siliconed onto the flexible hose by the plumber once the correct length has been established on site. This component is always supplied together with the bath

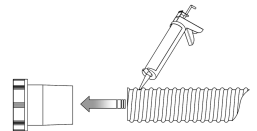

- Insert the waste “Click-Clack” through the aperture and seal in place using a silicon sealant. Be careful not to over tighten back nut.



Do not seal with window putty!

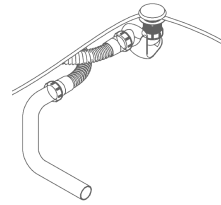
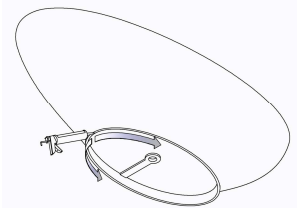

- Attach waste fittings and fix your bath using white/clear bath sealant which must be applied to bottom face of bath. Clean off any excess and be careful not to over silicone.
- Ensure the supplied flexible waste connector kit is securely connected to the bath and waste outflow system before positioning the bath.

NOTE



Do not drag the bath over any surface, but rather lift and place.

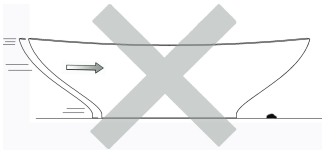

Do not drop your bath!

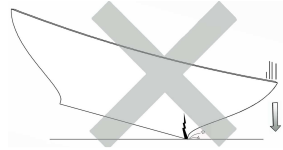

- Assembly order for optional plinth installation.

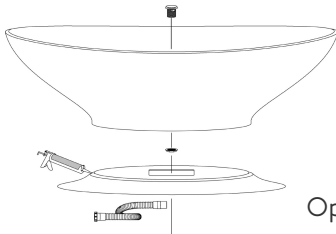

Optional Plinth

- Always protect the surface when handling or installing/assembling – cardboard provides adequate protection on the floor or an old blanket.
- Try and avoid getting cement, grit, sand or masonry products onto the surface. Prevention is better than cure.
- Always protect and cover the bath during the installation process and construction phase of your bathroom – other trades will damage the bath if no precautions are taken.
- Provide the bath to construction sites at the correct time as storage on site can lead to damages.
- Never use buff tape directly onto the surface. If inspection and repackaging is required remember to avoid taping directly onto the surface.

