

# AQUAECO

WASHROOM AND PLUMBING SOLUTIONS

---

## Installation Guide

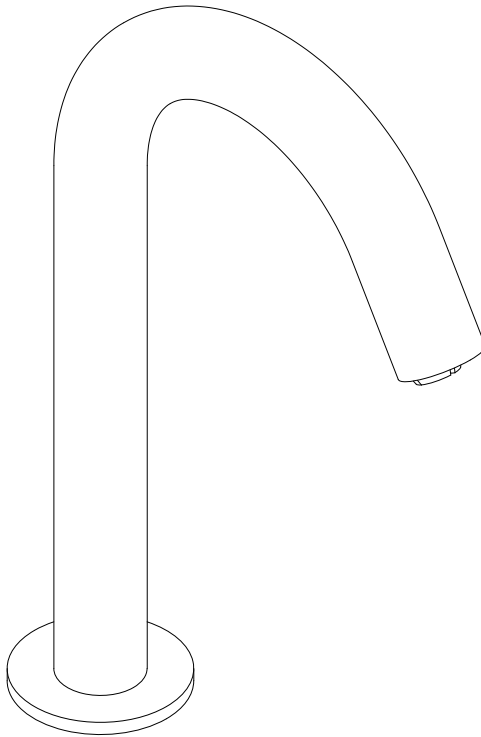

**AQE-ECO-I302-I302T-A**

AQUAECO DECK MOUNTED & DECK MOUNTED TALL  
TOUCHLESS TAP

A member of SANIPEXGROUP  
[www.sanipexgroup.com](http://www.sanipexgroup.com)

## IMPORTANT PLEASE READ

All products manufactured and supplied by AQUAECO are fit for purpose as long as they are Installed, used correctly, cleaned and receive regular maintenance in accordance with these instructions...

Remove all packaging and check the product for damage or missing parts before commencing with the installation.

Any alterations made to this product and its components may infringe product certification, infringe water regulations and invalidate the guarantee. The Installation must comply with all local/national water supply authority regulations/bylaws and building and plumbing regulations, therefore we strongly recommend that your product be installed by a reputable qualified trade's person.

## PRODUCT LIFECYCLE

*"The product LiveCyclele is the collective stages that a product goes through from its conception and design through to its ultimate disposal."*

## DISPOSAL GUIDANCE

The best way to ensure your Product has a long life is to follow the Care and Maintenance guides set by the Manufacture after purchase. This document can be found at [www.sanipexgroup.com](http://www.sanipexgroup.com).

The life cycle of the product is not in correlation to the product Guarantee; the standards the products are manufactured or certified to (e.g. CE & WRAS) can exceed past the Guarantee duration. After the life cycle of the product is deemed complete by the end-user please follow the below to dispose of the items correctly...

## CLEANING CARE GUIDE

Only use a mild soap and water for cleaning.  
Rinse with water to remove the mild soap solution.  
We recommend the product is dried using a soft cloth after every use.

**Never** use any abrasive or strong cleaning products containing, bleaches, acids (hydrochloric, formic, phosphorus, chlorine or acetic), strong detergents, limescale remover, alcohol or dyes etc.  
**Never** use abrasive cleaning pads, wire wool or microfibre cloths.  
**Never** use cleaning equipment that may have been pre-used and contaminated with the above substances.  
**Never** apply the cleaning product directly onto the finished surface.

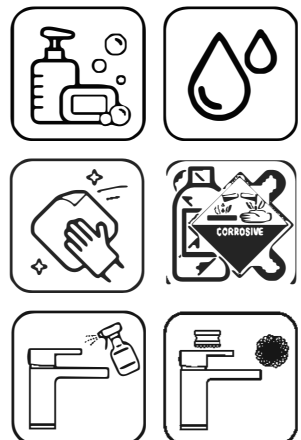

## Contents

Warnings .....	1
Specifications .....	1
Before usage .....	2
Confirm the spare parts .....	2
Name of spare parts .....	3
Installation position of the faucet .....	4
Installation of control box .....	5
Connection of spare parts .....	5
Installation or replacement of battery .....	6
Testing and usage .....	6
Care and cleaning .....	7
Clean the filtration system .....	7
Periodic maintenance .....	8
Long-term suspension of use .....	8
Product trouble .....	8
Trouble shooting .....	9

## Warnings

**For the safety and smooth operation, please pay attention on the following warnings.**

- Please DON'T disassemble, repair or refit the products, because it might lead to electricity shock
- or product breakdown, unless stated otherwise.
- Please DON'T install the products in humid place, especially in bathroom or Sauna room.
- Please DON'T strike the products, as this may damage the unit or cause water leakage.
- Please DON'T use the product in the place where freezing might be occurred.
- Please ensure that the power line separates from hot water line/tube
- Please keep the detecting scope clear to avoid interference.
- Please install the power socket/outlet in the place where water cannot be reached or sprayed.

## Specifications

	AC	DC
Power supply	AC 100~240V	4*1.5V Alkaline batteries
Sensor detection range	5~250mm base on 300*300mm white board	
Ambient temperature	1~55°C	
HumidMax.90RH	Humidity	
5~0.7MPa	Water pressure	
Product consumption	100~3800 cStandby: 2W Active:≤5WPs	
Flowrate	2L / Min	

## Common Tools needed

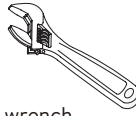

Adjustable wrench

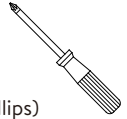

Screwdriver(Phillips)

## Before usage

1. Please read this instruction manual carefully and fix the products correctly.
2. We reserve the rights to upgrade products without a notice.
3. Flush the water supply pipes thoroughly to remove debris. Faucet is designed for tap water or potable water.
4. Please check whether the following spare parts completed or not.

## Confirm the spare parts

Spout for faucet

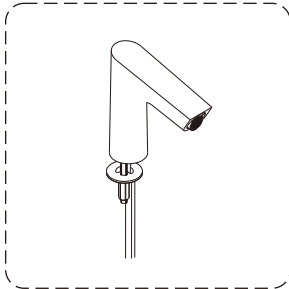

Control box

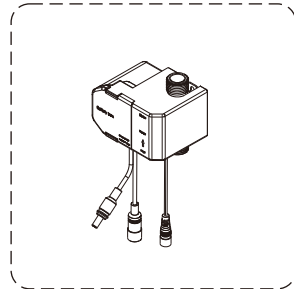

AC Adapter (AC)

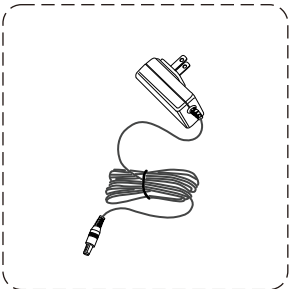

Screw part



Self-tapping  
Screw\*5pcs



Anchor\*5pcs

### Note :

1. As to the spare parts of power supply, please refer to the type of your purchased products.

## Name of spare parts

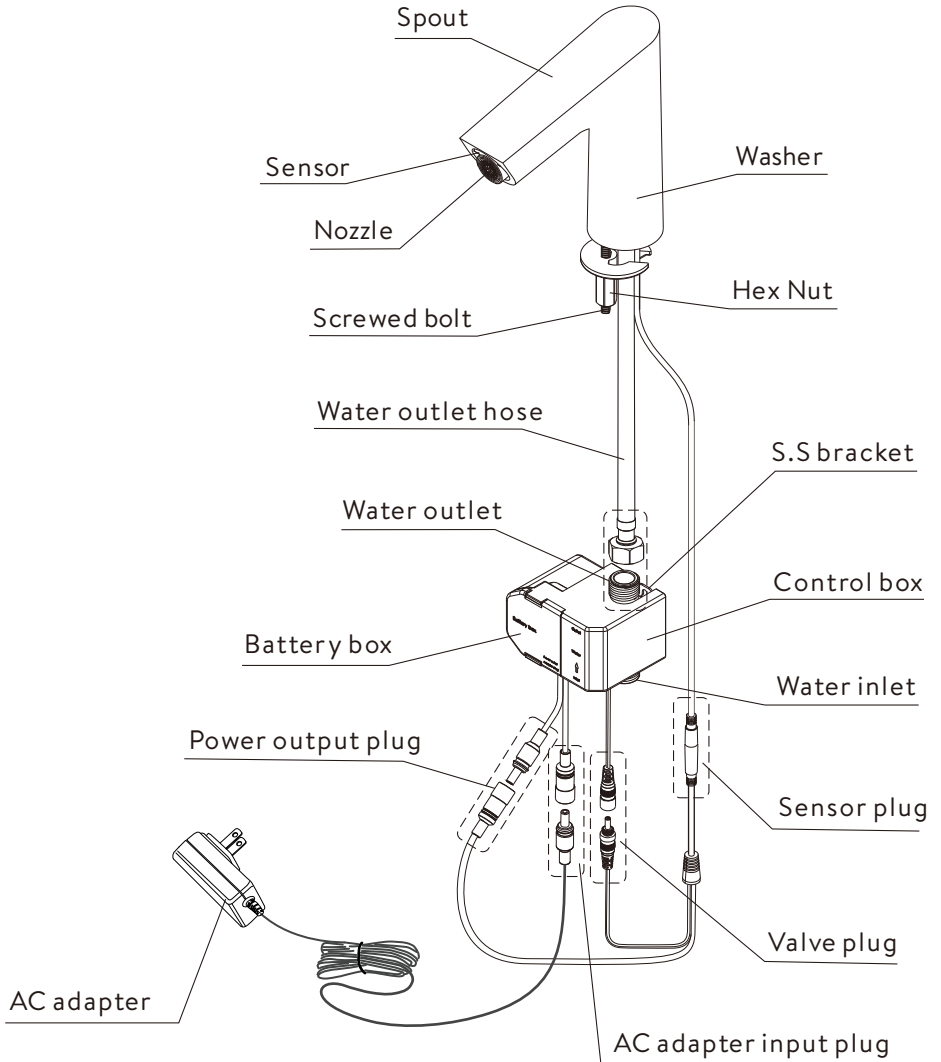

### Notes:

For the power adapter, please refer to the type you purchased.

# Installation position of the dispenser

※ Please take your purchased product as final, the outlook shown in the diagram might be different from the actual product.

(Diagram)  
(Single-Cold type)

## Tips:

1. Please make sure there is enough space for installation of control box of faucet.
2. The given dimensions shown on the diagram is for reference only, the actual size might be different than those indicated on the diagram.

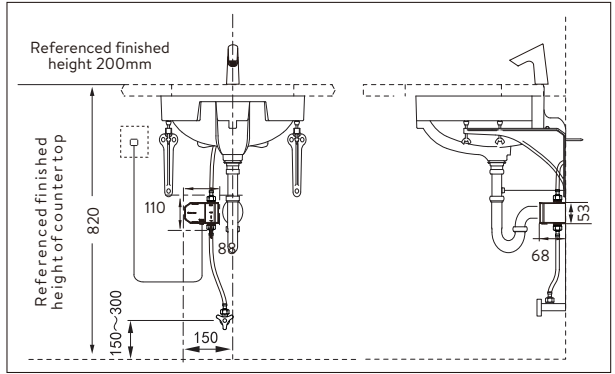

## Installation of water faucet

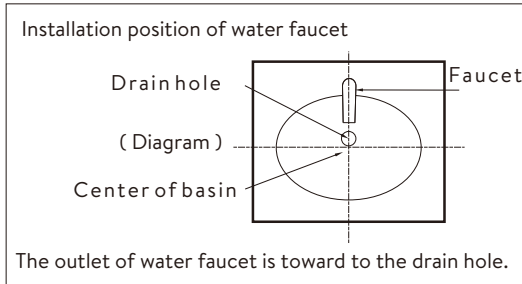

1. Take the mounting nut and washer from the water faucet then put the sensor cable, discharge pipe and the thread through the counter top in sequence, then place the washer and fasten the nut to fix the water faucet.
2. Adjust the direction of water faucet (adjusted the water faucet toward to the drain hole of basin) then fasten the nut to finish the installation of water faucet.

## Note:

Please make sure that the sensor cable and discharge pipe free of squeezing and binding during the installation.

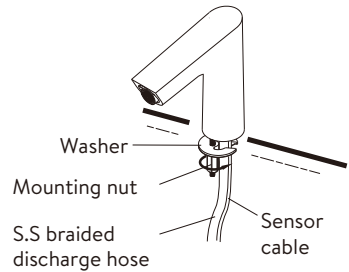

1. Fixed the water faucet temporarily.

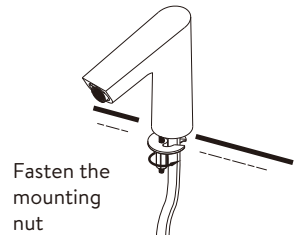

2. Fasten the mounting nut and fix the water faucet tightly.

# Installation of control box

## Installation of control box

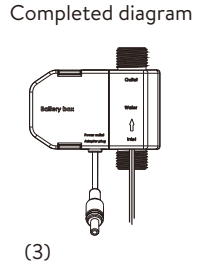
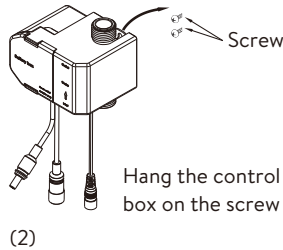
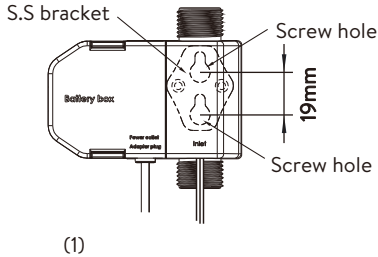

Drill 2 pcs 5mm holes on the proposed wall according to the dimension shown on the diagram ① and install the screws, then fix the control box onto the wall in accordance with diagram ② (fix the S.S bracket located on the back of the host on the pre-installed screws).

1. Connect the water incoming pipe into the inlet of control box according to the diagram then fasten it by wrench.
2. Connect the water outgoing pipe into the outlet of control box according to the diagram then tight it by wrench.
3. Connect the sensor cable of water faucet into the valve plug & power output plug of control box according to the marked direction.
4. Connect the AC adapter's output plug into the AC adapter input plug of control box.

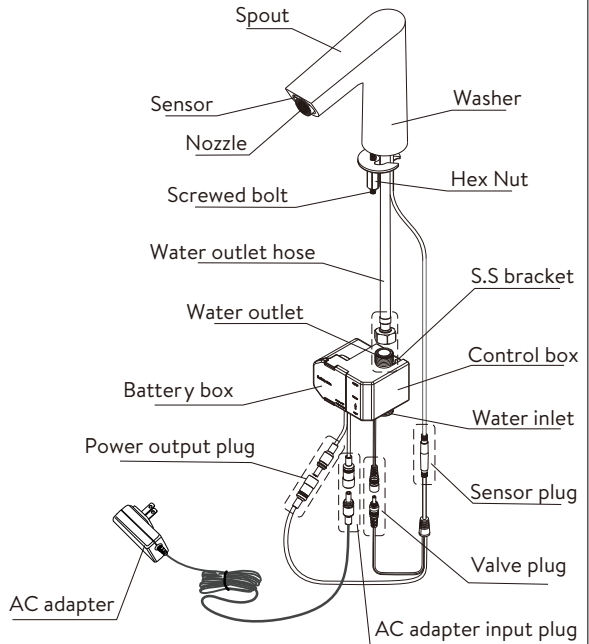

### Note:

Please ensure the incoming and outgoing water pipe are connected closely and comprehensively to avoid water leakage.

# Installation or replacement of battery

1. Open the battery cover of control box and take out the battery case according to the diagram ①.
2. install 4 pcs AA batteries correctly and put the battery case into the control box and fix its cover as per diagram ②.

**Note:**

This product is sold without battery.

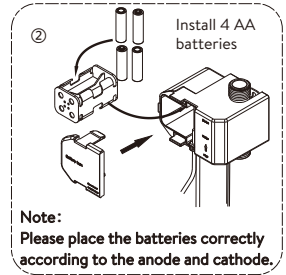
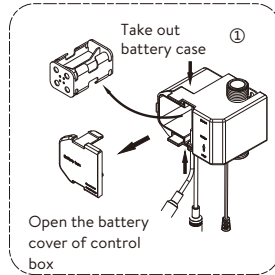

# Testing and using

## Testing and commissioning

After completion of installation, please test the product according to the following instructions:

### 1. Connect the power:

Connect the AC or DC power after the installation of device.

### 2. Confirm the sensor:

- ①. Please confirm the sensor inner light is stop flashing or not when there is no objects in front of sensor (after connecting the power, the inner light will flash and set the sensing distance automatically).
- ②. If the inner light is still flashing, please adjust the nozzle's direction slightly until the flash stop.
- ③. About 10 minutes passed after connecting the power, the sensor will finish the flash and sensing distance setting. If the direction of faucet nozzle is failed to set up after the sensor stops the flash, then please disconnect the sensor cable and repeat the above steps.

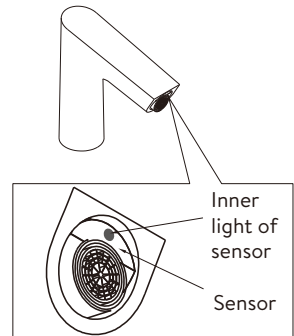

## Usage

Pease use the unit as below after the testing is done:

### 1. Water dispensing

Put your hands under the faucet (50-120mm from the nozzle) then the water will be dispensed automatically.

Note: Please do not block the nozzle by hands to avoid the water spraying).

### 2. Water stoppage

Remove your hands away then the water will be stopped automatically.

### Tips:

There is 60 seconds setting in this device, it will stop dispensing water automatically with 30 seconds even the hands are still under the device.

Put your hands under the nozzle of faucet.

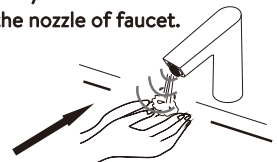

Move your hands away.





## Care & Cleaning

- **For light cleaning**

Please use the soft cloth soaked with water and drying it and then to wipe off the stain affixed on spout & sensor cabinet.

- **For heavy- dirt cleaning**

Please use the cloth soaked with right amount of neutral detergent to wipe off the stain and then clean by water.

Please be careful during cleaning surrounding of sensor cabinet to avoid the scratching.

Please do not use the detergent which might do harm to the spout such as acid detergent, chlorine decolorizer & alkali detergent. The following items are prohibited to adopt for cleaning the product. The detergents contained abrasive grain, such as polishing powder.

Solvent such as : Paint and the solvent covered benzene.

Abrasive such as : Nylon brush/steel wool,etc.

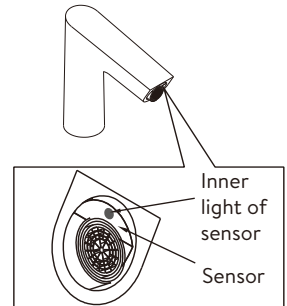
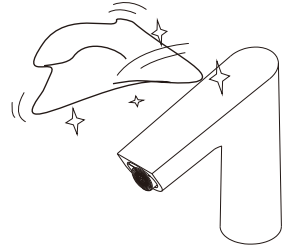

## Clean the filtration system

The control box is equipped with independent filtration system, but if the water quality is low inside the pipe and with the long-term usage, the water dispensing might be not good, in this case, please follow below instructions.

1. Turn off the angle valve placed on the water supply to avoid the water flow during the cleaning.
2. Unscrew the inlet pipe and take out the filter net from water inlet of control box then wash the blockage and finally fix the filter device.

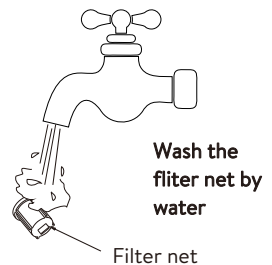
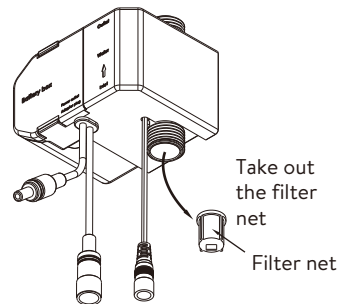

## Periodic maintenance

### Twice annually:

1. Please check all the connected parts to see whether there is leakage or not, and fasten or change the loosen or wear-out spare parts according to the real situation.
2. Please check the faucet and control to see whether they are loosen or not and fasten they if needed.

### Non periodic inspection:

1. Please clean the dirty when the sensing distance becomes short and the dirty is found on the sensor shell or case.
2. If the water is coming out for 2 seconds and the light of sensor flashes quickly in 2 seconds, it shows the batteries are in insufficient, please change the batteries (For the DC type).

## Long-term suspension of use

### Please follow below instructions when the unit is in long-term suspension of use

1. Turn off the incoming valve or main valve of water faucet.
2. Cut off the AC power and take out the batteries.

## Product trouble

### Please follow the below instructions in case product in trouble

1. Please check the Trouble Shooting table in case product in trouble to solve the problem.
2. Once there is water leakage occurred, please turn off the water valve then conduct the trouble shooting.
3. If the trouble shooting is failed even all the given instructions had been tried, then please contact the installer or the distributor.

## Trouble shooting

Some trouble symptoms can be identified by the indicator's flashing. Refer to "Note of the Indicator Flashing"

Symptoms	Probable Causes	Corrective Action
No water flow (Indicator not flashing)	No battery or wrongly connected No power supply or wrong connection Object in sensing range Dirt on the sensing window The connector does not connect well	Check the batteries Check the power supply and the connection Remove the object Clean the sensing window Check the connector
The indicator flashes once every 2 seconds and the water doesn't flow out.	Batteries are out of power Just power cut DC or AC connector of AC/DC transformer may not connect well	Replace batteries Check the power supply Reconnect the connector
No water flow while the indicator flashes	Just finishing installation The connector assemblies are closed Aerator is blocked The filter is blocked	Wait for 10 minutes Open the connector assemblies Clean the aerator Clean filter
Low water flow while the indicator does not flash	The connector assemblies are not open completely The filter is blocked Aerator is dirty The supply water pressure is lower	Turn counterclockwise the adjustment bolts on connector assemblies with the hex wrench Clean filter Clean the aerator Check the water supply system
Keep water out within 1 minute while indicator does not flash	Object in sensing range	Remove object

Please contact with distributor, if the trouble remains after above-mentioned actions are taken.  
Please do not disassembly the other parts of the faucet freely except installing and replacing batteries.

