

# BAGNODESIGN

EXPERTLY CRAFTED BATHROOMS

---

## General Installation Guide

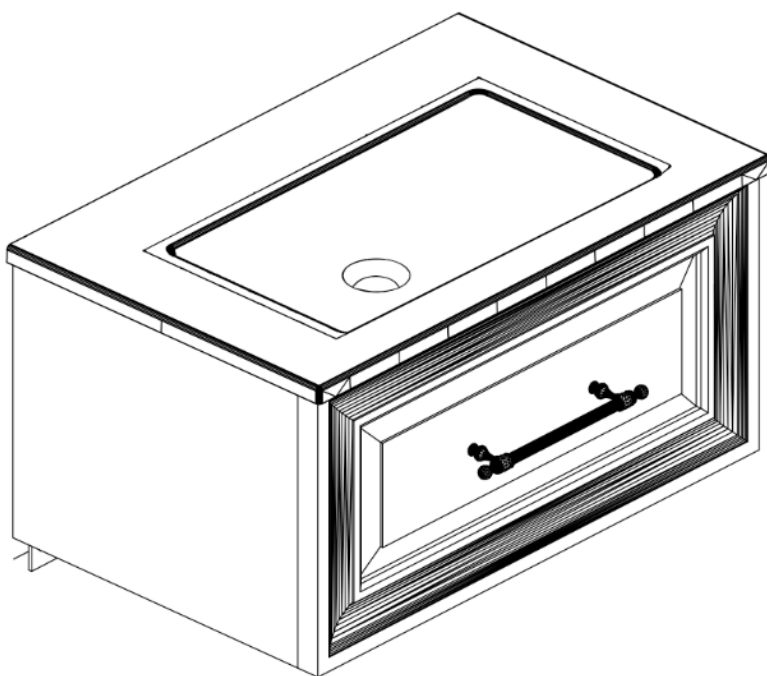

### BIARRITZ

WALL MOUNTED VANITY BASIN UNIT

NOTE: Wash basin not included, it is only used for illustrative purposes.

**A member of SANIPEXGROUP**

Please leave these instructions with the customer

## IMPORTANT PLEASE READ

Remove all packaging and check the product for missing parts or damage before starting installation.

Any alterations made to this product and fittings may infringe water regulations and invalidate the guarantee.

The Installation must comply with all Local/National Water Supply Authority Regulations/Byelaws and Building and Plumbing Regulations.

We strongly recommend that your product be installed by a reputable qualified trade's person.

### **General Installation**

**Please note this product can require 2 or more persons to lift and manoeuvre into position.**

To the installer: Please read and follow this instruction carefully, as the guarantee is only valid if the product is installed as directed.

Don't rush, read the instructions first and run through them before you begin. Keep fittings together to avoid loss. Do not over tighten screws or bolts.

If the unit is covered with polyethylene protective film, do not remove until installation is complete to grant maximum protection. However, remove film where any two surfaces will be in permanent contact.

Verify that all dimensions on the plan are the same as the ones of the product.

Please leave this installation manual with the end user once the product has been installed.

### **Product Aftercare:**

We recommend cleaning with a soft damp cloth and mild soap solution. Do not use cream cleaners or cleaners containing bleach.

Do not scrub or scour.

Do not use abrasive cleaning agents.

Do not use solvent based cleaners.

Do not allow pools of water to remain standing on the surfaces

## TOOLS REQUIRED (Not supplied)

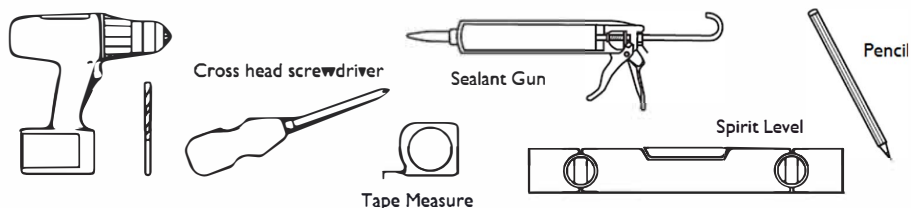

### Drill and drill bits

Required when securing the cabinet to a wall. Use an appropriate size bit to match the wall fixing chosen (wall screws and fixings not supplied).

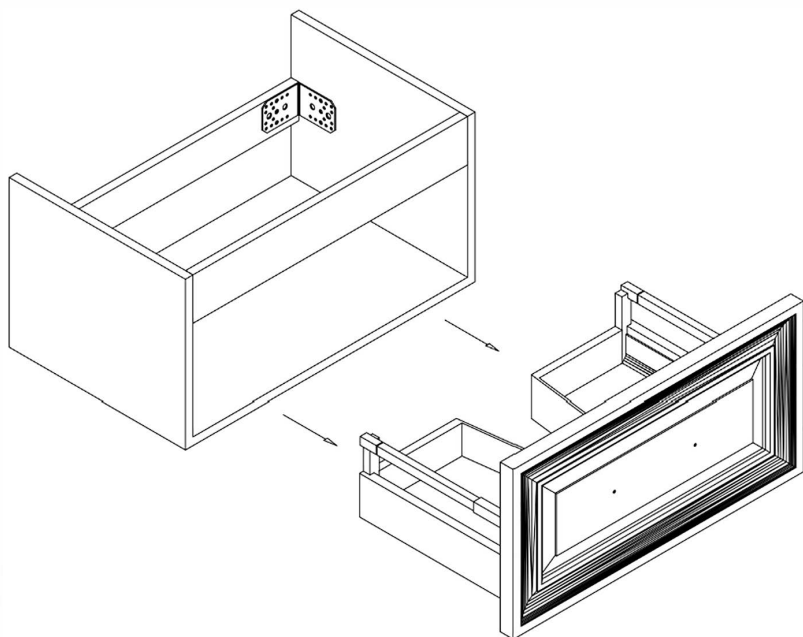

To make installation easier it is recommended that you remove the drawer from the cabinet. Pull the drawer out, with both hands at each side of the drawer reach under the base of the drawer sides at the front and feel for the release mechanisms.

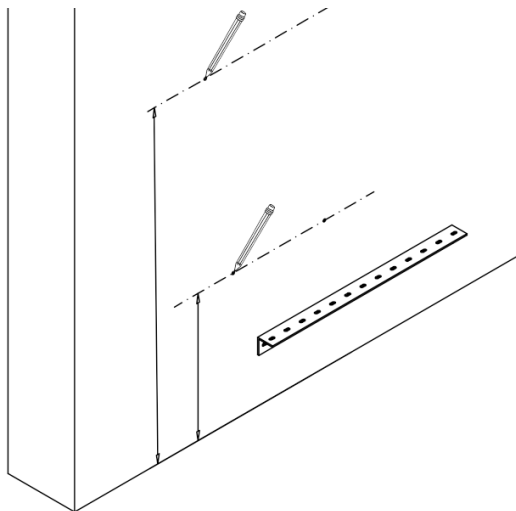

Once you have decided on a suitable position for your vanity unit, measure 850-900 from finished floor level, mark out the drilling positions on the wall. Then measure the distance between the fixing holes to the bottom of the vanity. Use this measurement to draw a horizontal line across to fix the support bracket.

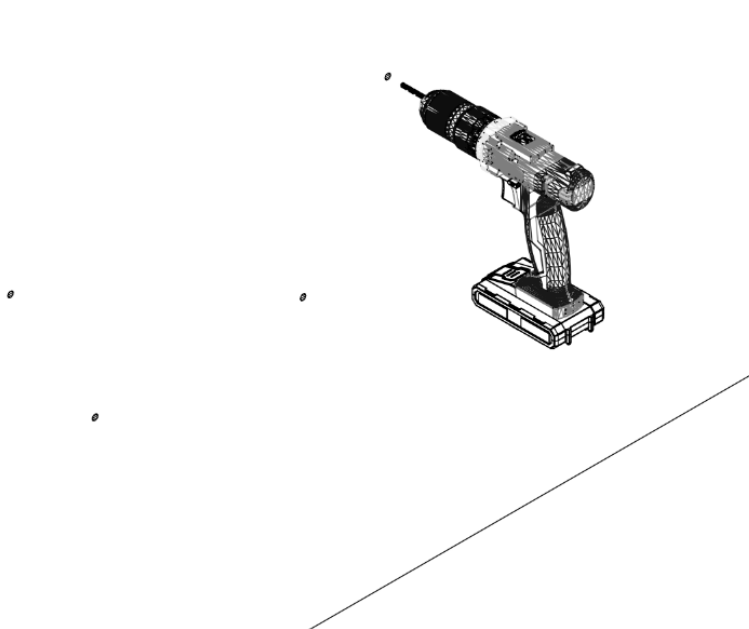

Drill the holes on the marking points .

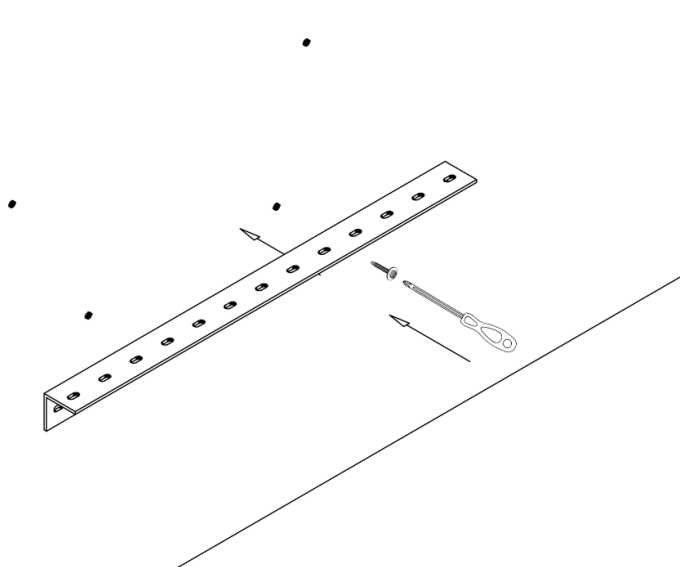

Fix the support bar on the wall

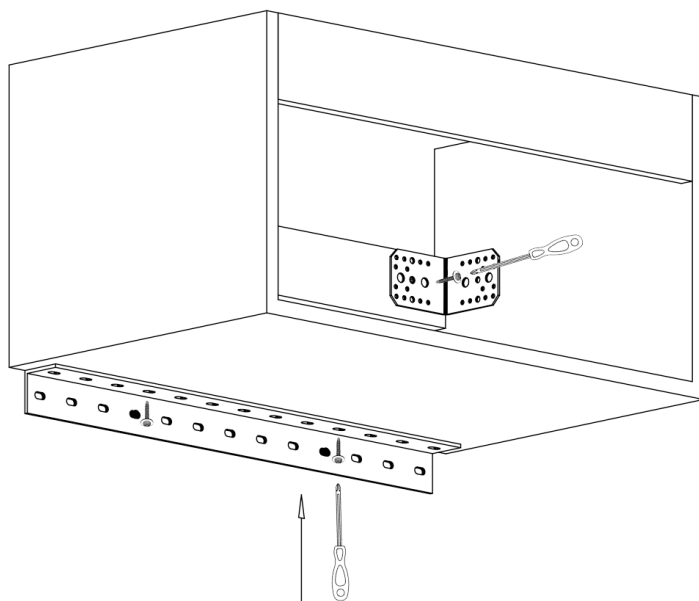

Gently lift the cabinet into position and place on the support bracket. Make sure that the cabinet is securely held in place before letting go. When you are happy with the position of the cabinet, using wall fixings, fix the cabinet through the angle brackets at the rear of the unit, and then secure the vanity to the support bar fixing screws from the bottom vanity.

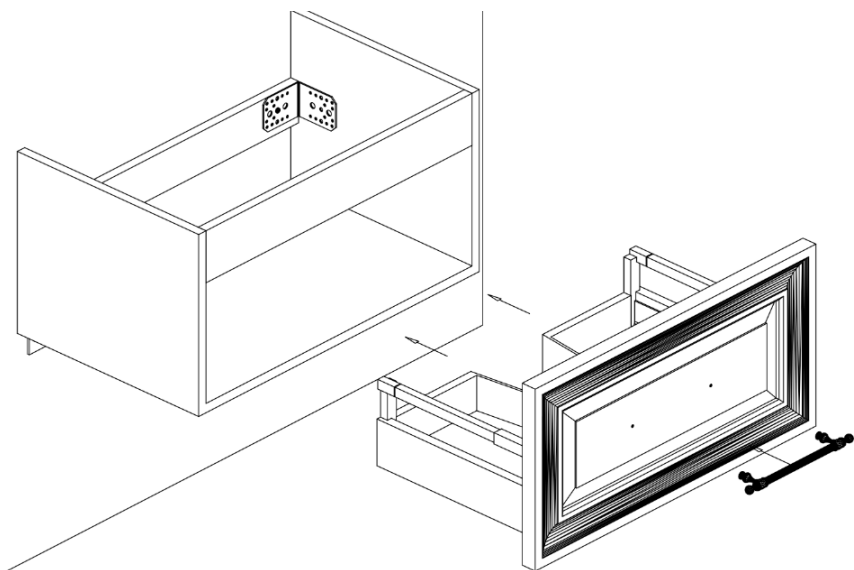

Put the drawer back into the unit. Fully extend the drawer runners and lower the drawer onto the runner pushing it closed, the drawer will click into place. Then fix the handles (Not included).

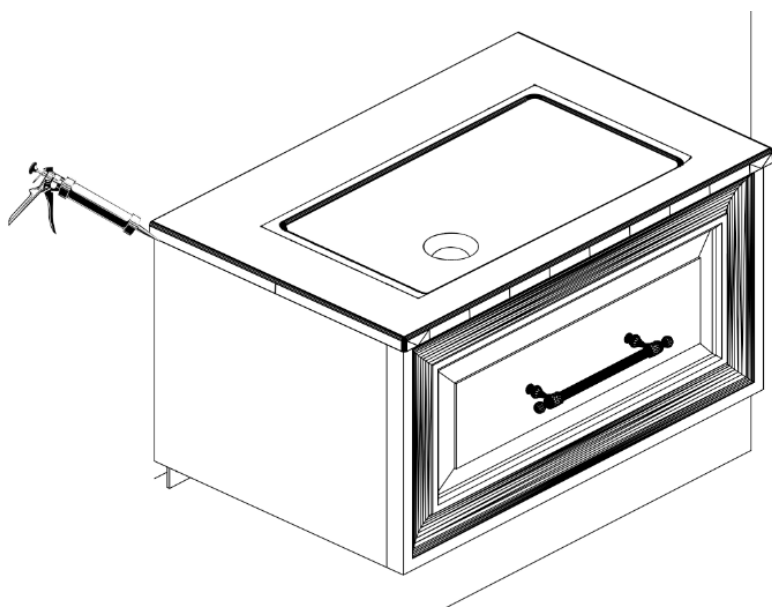

Install basin as per the basin installation, to finish please a bead of silicon around the top perimeter of the basin.

[illegible]

# BAGNODESIGN

EXPERTLY CRAFTED BATHROOMS

---

---

---

---

---

---

---

---

---

---

---

---

---

Oakwell Way, Birstall  
Leeds, England WF9 17LU

A member of  SANIPEXGROUP