

# BAGNODESIGN

EXPERTLY CRAFTED BATHROOMS

---

## Installation Guide

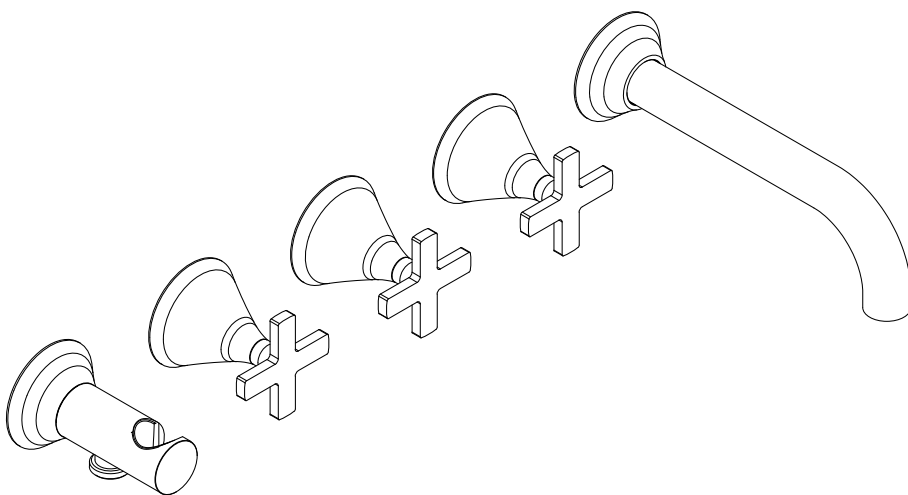

**BDM-BIS-447X-XX**

BRISTOL WALL MOUNTED 5 HOLE BATH SHOWER MIXER

A member of **SANIPEXGROUP**  
[www.sanipexgroup.com](http://www.sanipexgroup.com)

## IMPORTANT PLEASE READ

All products manufactured and supplied by BAGNODESIGN are fit for purpose as long as they are installed, used correctly, cleaned and receive regular maintenance in accordance with these instructions...

Remove all packaging and check the product for damage or missing parts before commencing with the installation.

Any alterations made to this product and its components may infringe product certification, infringe water regulations and invalidate the guarantee. The Installation must comply with all local/national water supply authority regulations/bylaws and building and plumbing regulations, therefore we strongly recommend that your product be installed by a reputable qualified trade's person.

### PRODUCT LIFECYCLE

*"The product LiveCyclele is the collective stages that a product goes through from its conception and design through to its ultimate disposal."*

### DISPOSAL GUIDANCE

The best way to ensure your Product has a long life is to follow the Care and Maintenance guides set by the Manufacture after purchase. This document can be found at [www.sanipexgroup.com](http://www.sanipexgroup.com).

The life cycle of the product is not in correlation to the product Guarantee; the standards the products are manufactured or certified to (e.g. CE & WRAS) can exceed past the Guarantee duration. After the life cycle of the product is deemed complete by the end-user please follow the below to dispose of the items correctly...

#### Mixers (Taps):

If the mixers are no longer accepted due to mechanical use or aesthetic style, these can be disposed of at a registered Local Authority waste recycling center where the individual components can be sorted.

### CLEANING CARE GUIDE

Only use a mild soap and water for cleaning.  
Rinse with water to remove the mild soap solution.  
We recommend the product is dried using a soft cloth after every use.

**Never** use any abrasive or strong cleaning products containing, bleaches, acids (hydrochloric, formic, phosphorus, chlorine or acetic), strong detergents, limescale remover, alcohol or dyes etc.

**Never** use abrasive cleaning pads, wire wool or microfibre cloths.  
**Never** use cleaning equipment that may have been pre-used and contaminated with the above substances.

**Never** apply the cleaning product directly onto the finished surface.

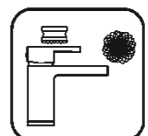

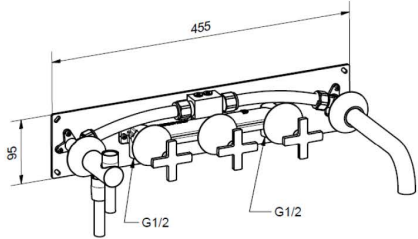
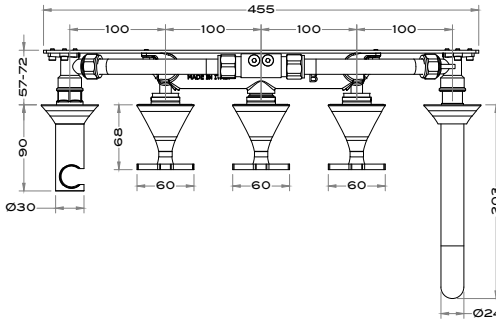
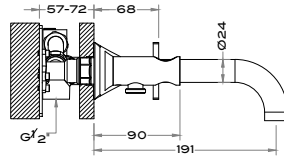
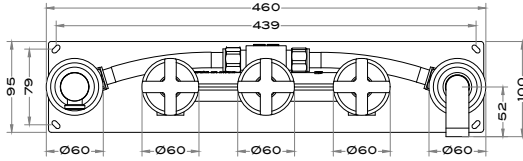

**1** REFERRING TO THE DIMENSIONS SHOWN IN PICTURE, EMBED THE BODY (1) INTO THE WALL, CHECKING THAT IT IS WELL ALIGNED

**2** MAKE THE CONNECTIONS AND CHECK THAT IS WATERTIGHT AND THERE ARE NO LEAKS. IMPORTANT: LEAVE THE PLASTIC PROTECTION MOUNTED UNTIL TILES ARE APPLIED AND PROPERLY CUT IN ORDER TO FOLLOW THE PROTECTION SHAPE.

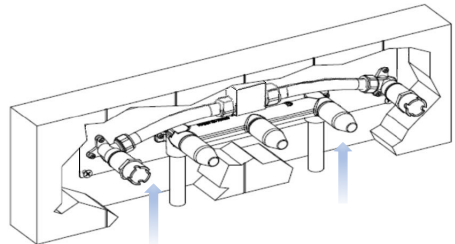
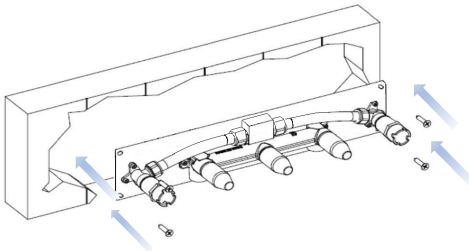

3

REMOVE THE PROTECTIONS, ASSEMBLE (AND CUT IF NECESSARY) 3 EXTENSIONS ACCORDING TO SCHEME 3A-3B

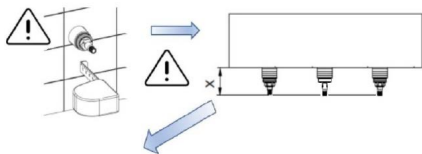
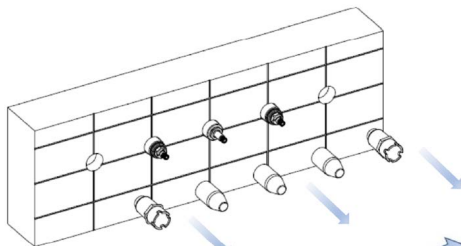

3a

X=49-42mm



3b

X=42-34mm

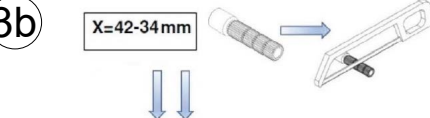

3b1) X=42-39mm



3b2) X=39-34mm

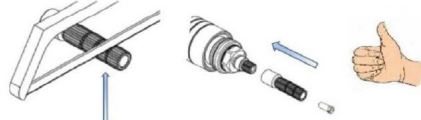

4

ASSEMBLE THE HANDLES

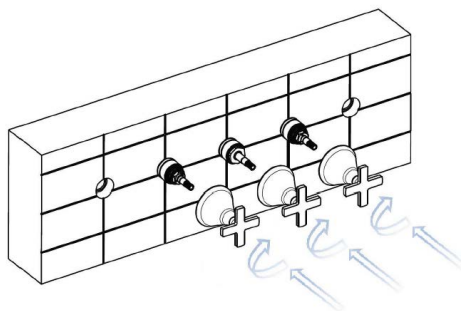

5

INSERT THE SPOUT IN THE PLATE (5A) AND SCREW IT TO THE DESIRED POSITION (5B) USING TEFLON OR HAMP

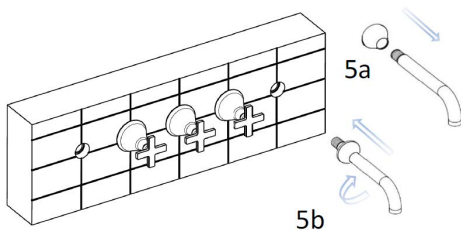

6

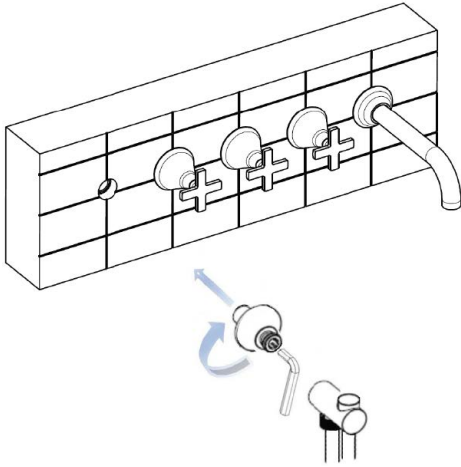

7

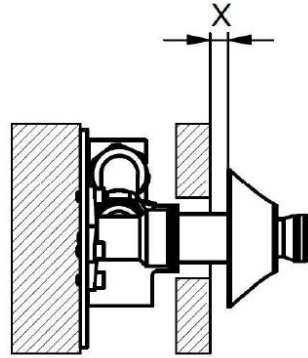

SCREW THE THREAD CONNECTION AND THE PLATE (6): CHECK IF IT IS NECESSARY TO USE THE EXTENSION SUPPLIED (7A), AND IF IT IS NECESSARY TO CUT IT ACCORDING WITH THE SCHEME (7B/7C)

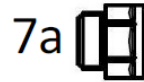

7b

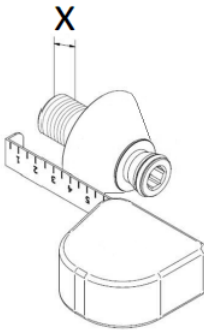

7c

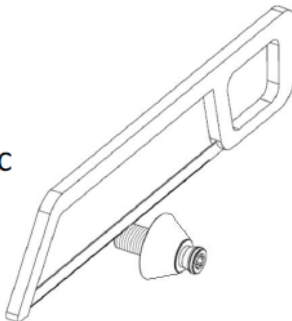

8

SCREW THE CONNECTION INTO HIS PLACE AND SECURE IT USING TEFLON OR HAMP

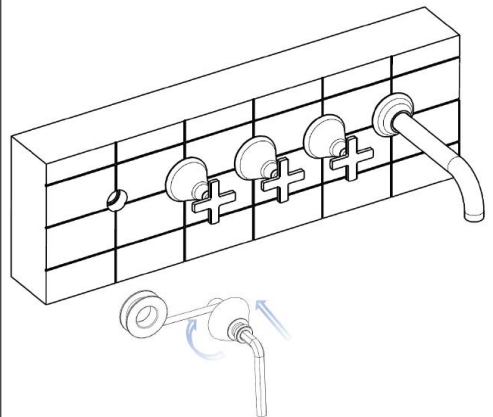

9

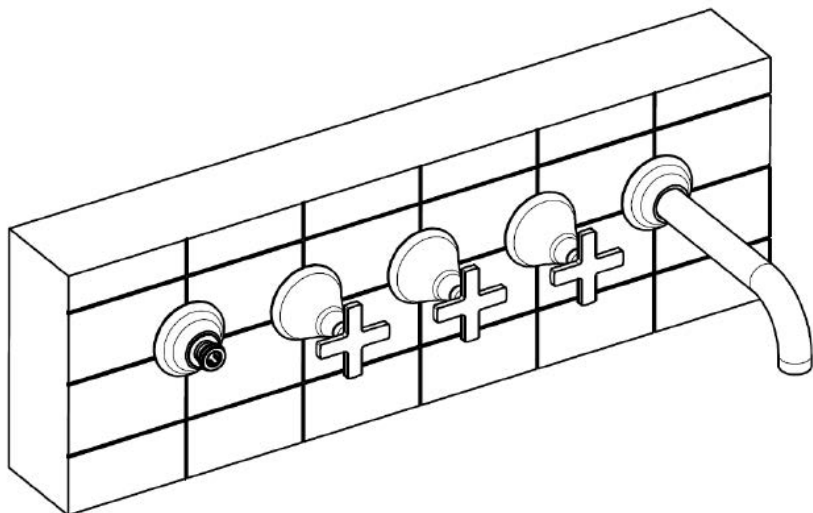

10

INSERT THE SHOWER HOOK AND FIX IT WITH THE GRUB SCREW

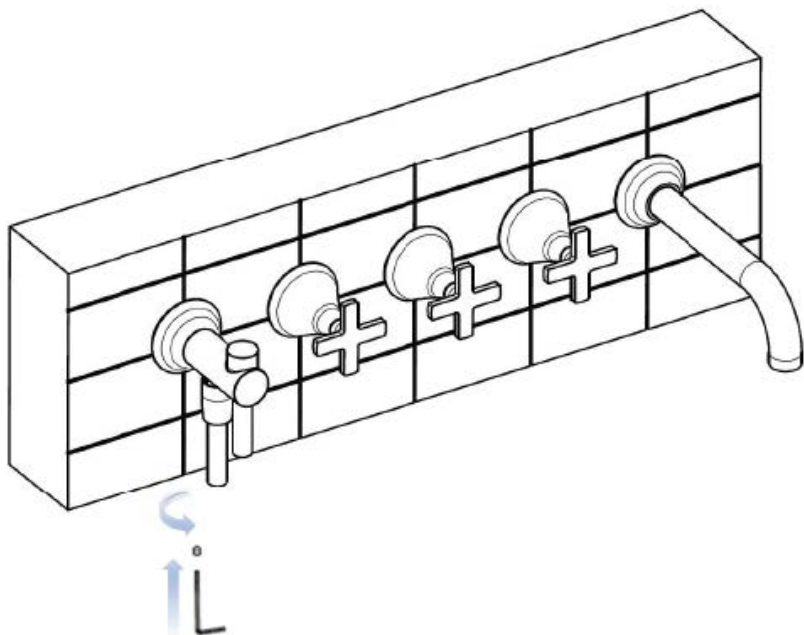



# BAGNODESIGN

EXPERTLY CRAFTED BATHROOMS

---

---

---

---

---

---

---

---

---

---

---

---

A member of SANIPEXGROUP  
[www.sanipexgroup.com](http://www.sanipexgroup.com)