

# AQUAZONE

QUALITY PLUMBING SOLUTIONS

---

## Installation Guide

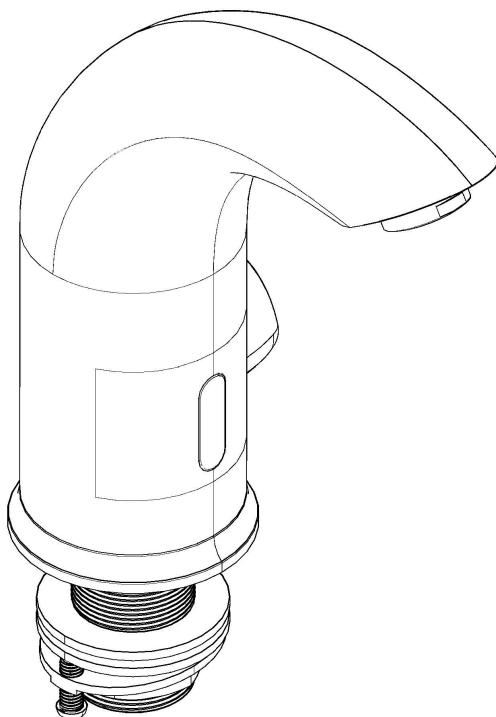

**AQE-ECO-1324-XX**  
AQUAECO MONO TOUCHLESS BASIN MIXER

A member of SANIPEXGROUP

**Features:****Water saving:**

water flows out when your hands approach & stops immediately once leaving, saving water dramatically.

**Hygienic:**

self-open and close to free hands from any touching, which can efficiently prevent you from bacteria mutual infections.

**Intelligent:**

with micro-computer controlling, the faucet can self-adjust the best detection zone as per the color and shape of lavatory, unnecessary to debug manually. To prevent water wasting from continuous error sensing by stumbling blocks, it has been default

set with the function of flowing-self-stopped over 60 seconds.

**Low power consumption:**

For DC flush kit, operates with 4AAA batteries(not including) with an average life of 2 years based on 200 cycles a day.

**Micro control circuit:**

The control circuit is minimized with solid state and integrated in the sensor window with moisture re-sistance and waterproof.

**Water temperature adjust:**

It is very convenient to adjust water temperature by handle and with much comfort while washing hands.

Water closed when the power is abnormal. The sensor will stop the water when less power.

Note: In order to avoid your free maintenance right, please keep the guarantee certification and invoice thank you for your kind support!!!

|                             |                                |  |
|-----------------------------|--------------------------------|--|
| Power & Voltage             | DC6V 4AA<br>Alkaline Batteries |  |
| Power Consumption in Static | ≤0.5mw                         |  |
| Detection Zone              | 12-18cm                        |  |
| Water Pressure              | 0.05-0.6Mpa                    |  |
| Ambient Temperature         | 0.1-45°C                       |  |
| Water Temperature Scope     | 0-80°C                         |  |
| Dia of Inlet/Outlet Pipe    | Dn15 (G1/2")                   |  |

## Faucet Parts:

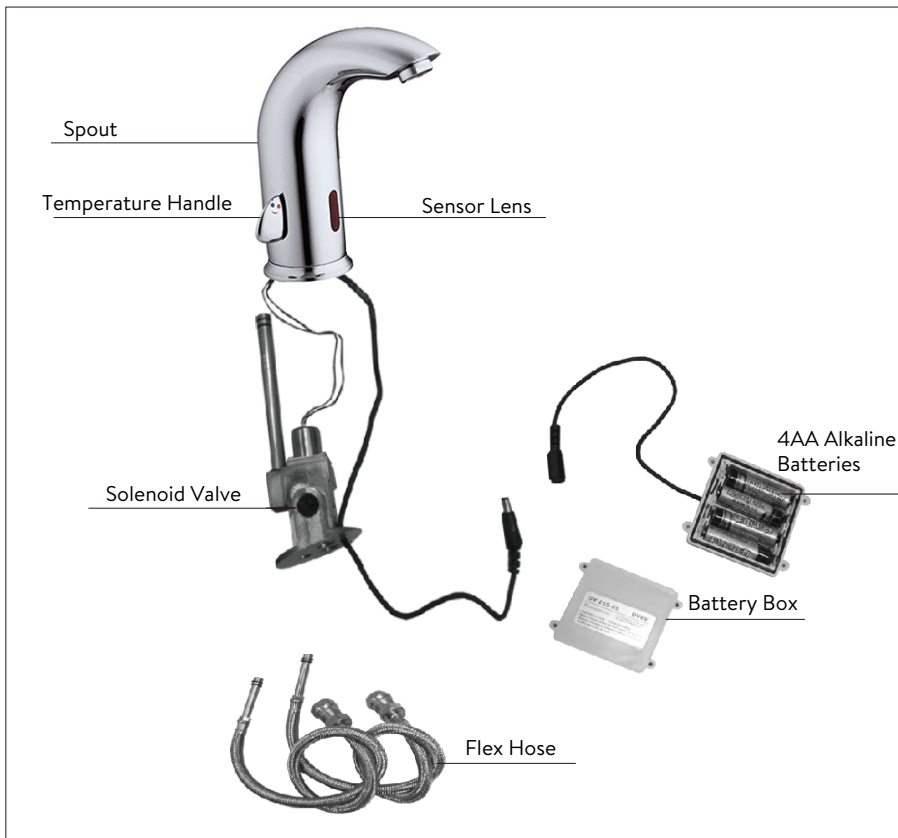

## Notice: Design & Installation Position Choice

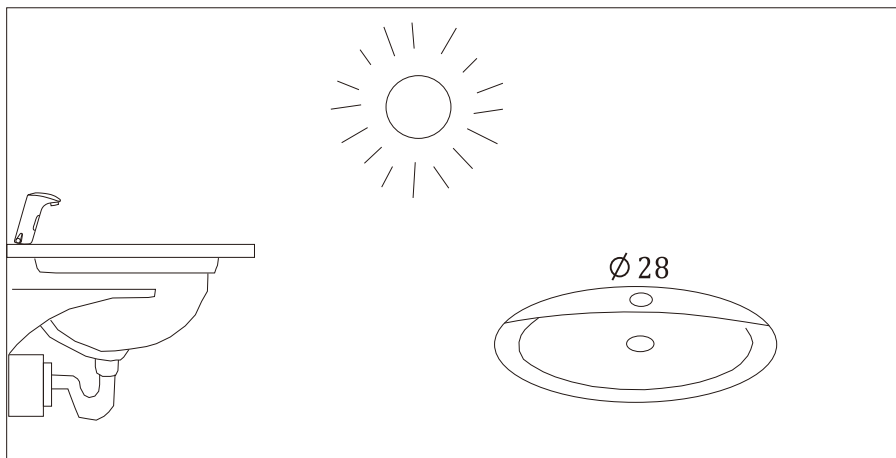

## Basin Choice:

Under application of design, you should choose single hole basin(hole diameter >28mm),otherwise it will probably pull apart and disconnect between fiber optic cable and sensor chip.

## Pipe Cleanness:

The water pipe must be cleaned before installation, otherwise it will work exceptionally because the sand and dirt in the pipe flows into the electromagnetic valve.

## Installation Diagram:

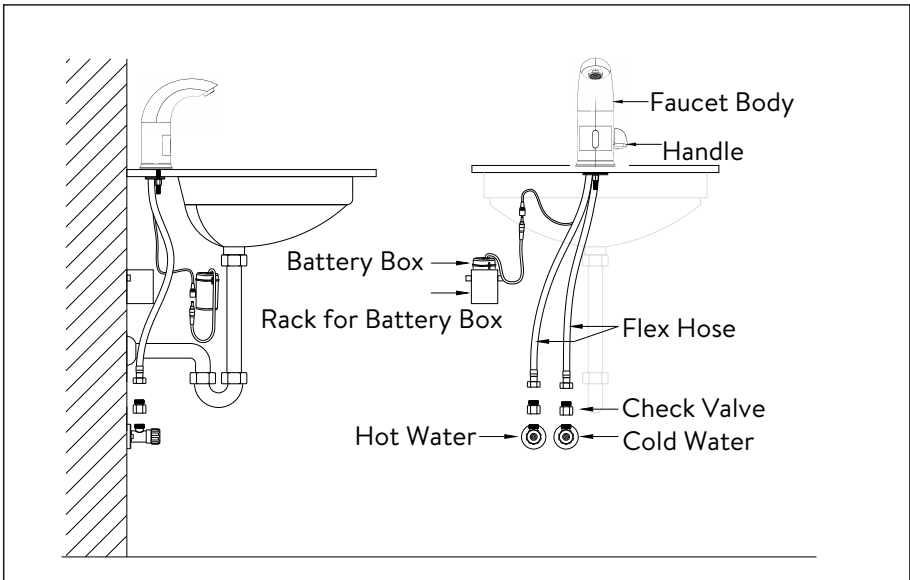

## Attention:

Please close the water when you do the installation

## USING METHOD

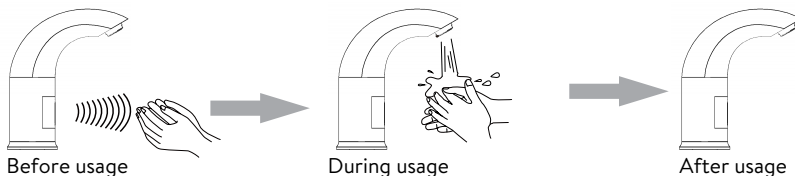

Note: When your hand enters the sensor the water flows, remove your hand from the field and it will stop automatically after flushing 30 seconds continuously, To flush again, leave your hand in the sensor field for 3 seconds.

## MAINTENANCE

Our products are finished to the highest standard and due care needs to be taken to ensure their looks are retained. We recommend cleaning all products with soft damp cloth **ONLY** and advise strongly against the use **ALL** cleaning products i.e. powders and liquids.

Please ensure the filter is cleaned every 6 months or if the water flow is reduced.

Don't use corrosive detergent.



Clean filter

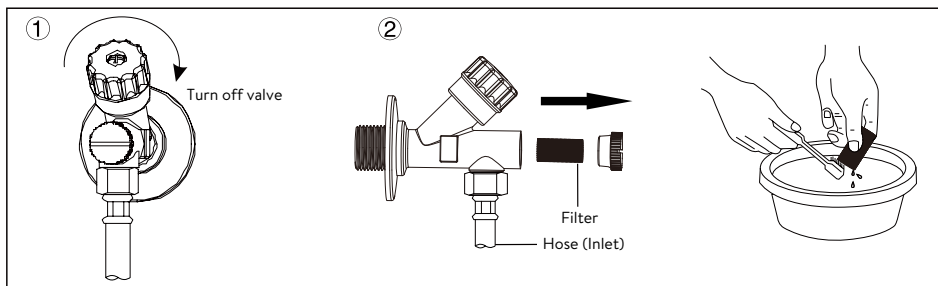

## Cleaning instruction

Dear Customers:

The electroplating on this product is finished to a high standard. To keep the product surface in pristine condition, clean with a soft damp cloth only. To avoid limescale / watermarks from building up, it is advisable to wipe the fitting dry each time it is used.

Damage to the surface caused by improper cleaning/maintenance will not be covered under guarantee.

On no account should any bathroom cleaner be used on this product as these can contain acids that are aggressive/corrosive on finished surfaces!



# AQUAZONE

QUALITY PLUMBING SOLUTIONS

---

---

---

---

---

---

---

---

---

---

---

---

Oakwell Way, Birstall  
Leeds, England WF9 17LU

A member of SANIPEXGROUP