

AQUAZONE

QUALITY PLUMBING SOLUTIONS

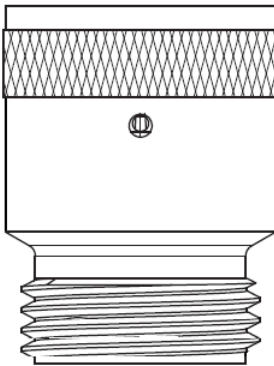

General Installation Guide



AQUAECO

1 bar pressure limiter

A member of  SANIPEXGROUP

Please leave these instructions with the customer

IMPORTANT PLEASE READ

Remove all packaging and check the product for missing parts or damage before starting installation.

Any alterations made to this product and fittings may infringe water regulations and invalidate the guarantee.

The Installation must comply with all Local/National Water Supply Authority Regulations/Byelaws and Building and Plumbing Regulations.

We strongly recommend that your product be installed by a reputable qualified trade's person.

General Installation:

To the Installer, please read and follow this instruction carefully, as the guarantee is only valid if the product is installed as directed.

Don't rush, read the instructions first and run through them before you begin. Keep fittings together to avoid loss. Do not over tighten screws or bolts.

If the product is covered with polyethylene protective film, do not remove until installation is complete to grant maximum protection. However, remove film where any two surfaces will be in permanent contact.

Before making any inlet pipe connections, all supply pipes **MUST** be thoroughly flushed to remove debris.

The fitting of an in-line filter is recommended, Failure to do this could result in damage to the components or poor performance from the pressure limiter.

The fitting of isolation/stop valves on the inlet feeds is advised for ease of maintenance.

Please leave this installation manual with the end user once the product has been installed.

Product Aftercare:

We recommend cleaning with a soft damp cloth and mild soap solution. Do not use cream cleaners or cleaners containing bleach.

Do not scrub or scour.

Do not use abrasive cleaning agents.

Do not use solvent based cleaners.

This installation guide is for reference only. In case there is a discrepancy between that of the instructions and that of the actual product, the latter should be taken as standard. The rights of modification are reserved.

WHAT IS THE PRESSURE LIMITER GOOD FOR?

Limits deformation or damage risks - caused by excessive pressure loads on pressure sensitive end-of-line applications.

Limits the dynamic downstream pressure on application to 1 bar, independent from supply pressure (dynamic = flow rate >0).

Limits the static downstream pressure on application to 2-4 bar (static = no flow).

Affixed downstream pressure of 1 bar provides a constant flow rate.

Various setups for markets with mixed pressure supply (gravity fed and boost pump installations) conceivable



POSSIBLE APPLICATIONS:

Shattaf Application:

Protection against overpressure and
“Water-Hammer”

May ease operation



Shower heads/ handles:

Protection against excess pressure
load due to clogged nozzles or high
line pressure

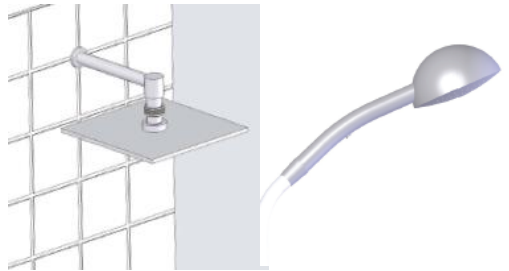

Other Applications:



STATIC MODE: BY EXAMPLE OF PRESSURE IN CLOSED SHATTAF:

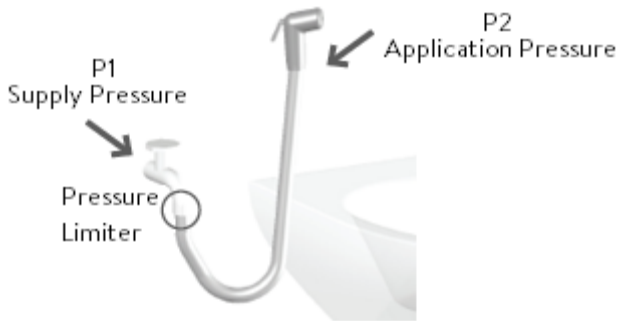

Shattaf Open = Dynamic Mode

Restriction of any line pressure to 1 bar during flow, provides comfortable water jet and easy operation of the Shattaf handle.

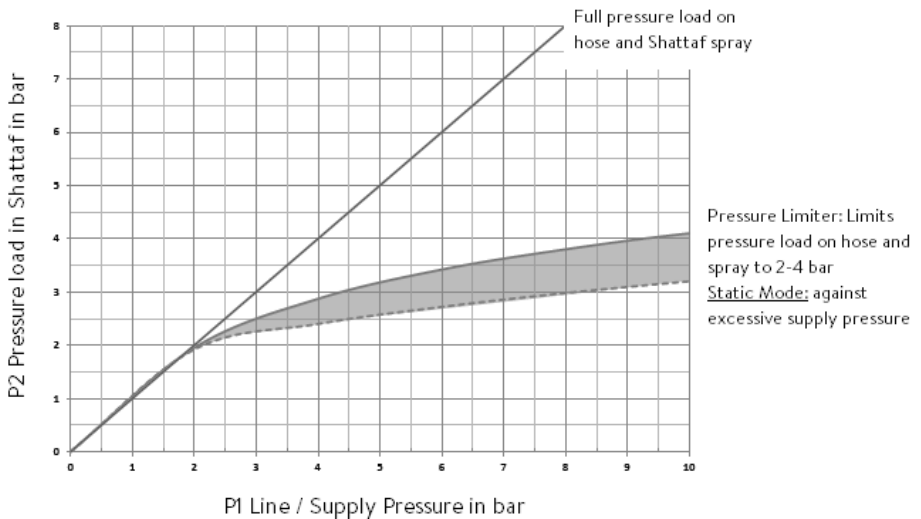

After shutting off the handle it limits the hose pressure to 2-4 bar.

DYNAMIC MODE: BY EXAMPLE OF PRESSURE IN SHOWER HEADS & HANDLES:

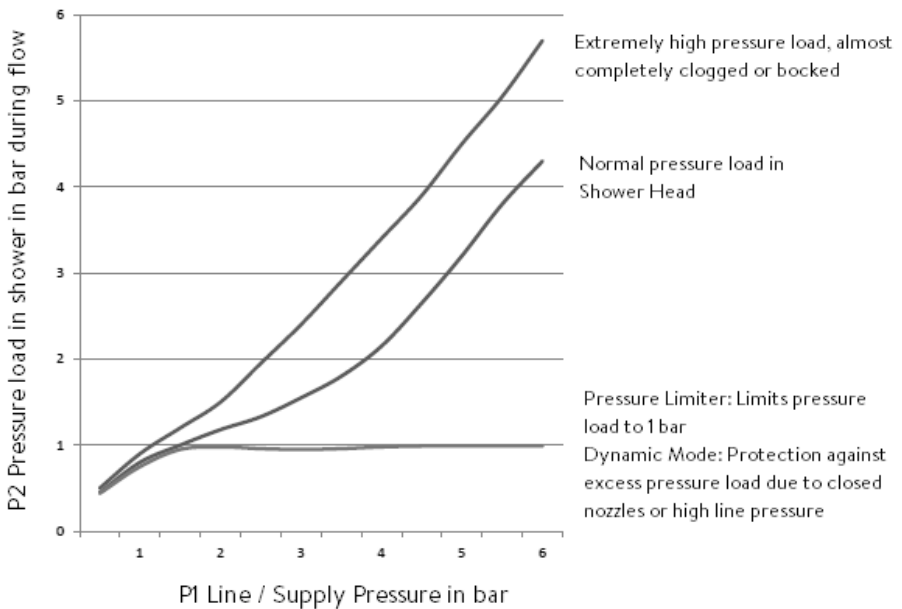
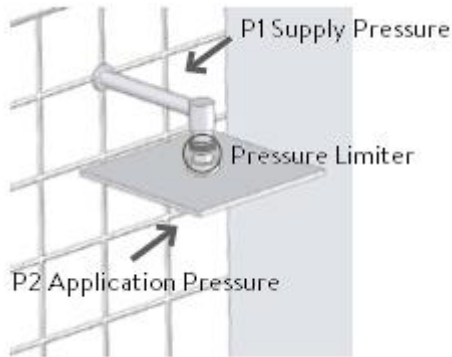

WORKING PRINCIPLE:

In case of downstream pressure above 1 bar, the Pressure Limiter reduces the water passage.

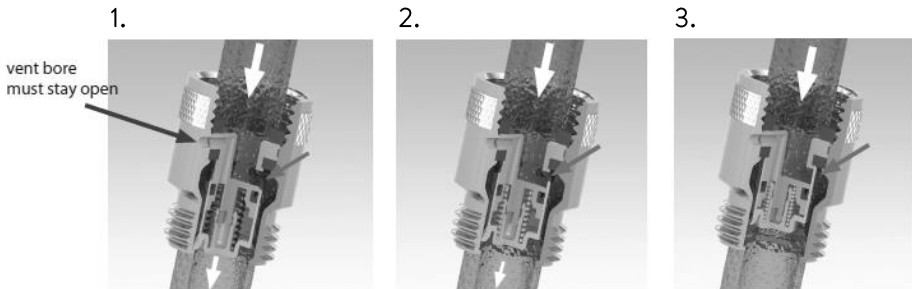

1. No backpressure: piston completely open.
2. Increasing backpressure: dynamic mode piston partly closed.
3. Closed position, static mode outlet clogged or blocked.

DRAWING:

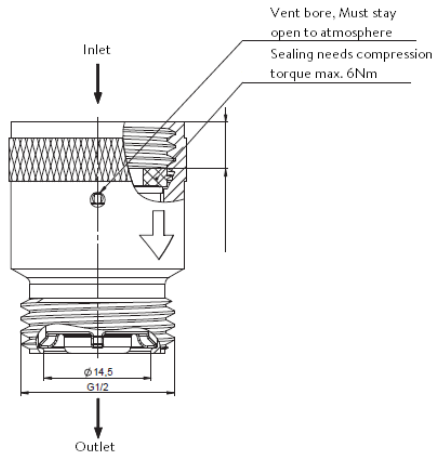

GOOD TO KNOW:

The Pressure Limiter is not an overpressure safety device and must not be specified as safety-relevant component.

Application should be designed to meet pressure resistance for appropriate Standards.

The Pressure Limiter is not an in wall installation component

