

AQUAECO

WASHROOM AND PLUMBING SOLUTIONS

Installation Guide

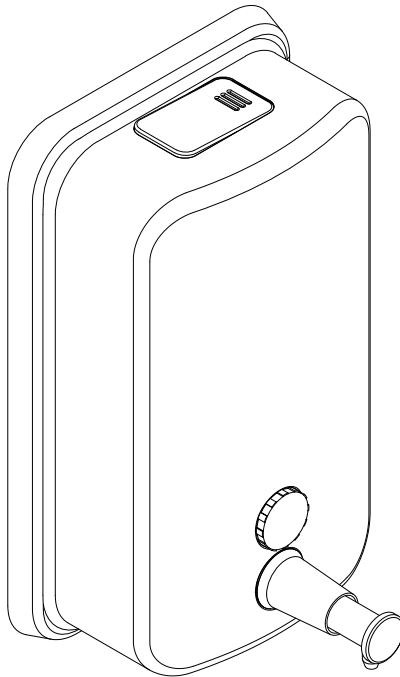

AQP-WBT-220-CP

AQUAECO BATH FILLER MIXER WITH PUSH TYPE WASTE

A member of **SANIPEXGROUP**
www.sanipexgroup.com

IMPORTANT PLEASE READ

All products manufactured and supplied by AQUAECO are fit for purpose as long as they are installed, used correctly, cleaned and receive regular maintenance in accordance with these instructions...

Remove all packaging and check the product for damage or missing parts before commencing with the installation.

Any alterations made to this product and its components may infringe product certification, infringe water regulations and invalidate the guarantee. The Installation must comply with all local/national water supply authority regulations/bylaws and building and plumbing regulations, therefore we strongly recommend that your product be installed by a reputable qualified trade's person.

PRODUCT LIFECYCLE

"The product LiveCyclele is the collective stages that a product goes through from its conception and design through to its ultimate disposal."

DISPOSAL GUIDANCE

The best way to ensure your Product has a long life is to follow the Care and Maintenance guides set by the Manufacture after purchase. This document can be found at www.sanipexgroup.com.

The life cycle of the product is not in correlation to the product Guarantee; the standards the products are manufactured or certified to (e.g. CE & WRAS) can exceed past the Guarantee duration. After the life cycle of the product is deemed complete by the end-user please follow the below to dispose of the items correctly...

Mixers (Taps):

If the mixers are no longer accepted due to mechanical use or aesthetic style, these can be disposed of at a registered Local Authority waste recycling center where the individual components can be sorted.

CLEANING CARE GUIDE

Only use a mild soap and water for cleaning.
Rinse with water to remove the mild soap solution.
We recommend the product is dried using a soft cloth after every use.

Never use any abrasive or strong cleaning products containing, bleaches, acids (hydrochloric, formic, phosphorus, chlorine or acetic), strong detergents, limescale remover, alcohol or dyes etc.

Never use abrasive cleaning pads, wire wool or microfibre cloths.
Never use cleaning equipment that may have been pre-used and contaminated with the above substances.

Never apply the cleaning product directly onto the finished surface.

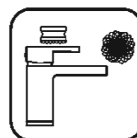

Installation & operation instruction

Installation Notice.

1. Flush pipes to get rid of any debris blocked in pipes before installation.
2. After installation, check all the joints to make sure they are firmly connected. Then turn water on and off repeatedly to ensure there are no leaks around the joints then the product can be used normally at this stage.

Operation Notice.

1. The product is used between water pressure 0.5 to 4bar, water temperature 0-90°C.
2. **The waste and the tap is suitable for being installed in the bathtub which thickness is 5-10 mm(as Figure I).**
3. Regularly clean the tap with soft damp cloth.
4. Read all the instructions completely before proceeding.

III. Installing steps (Figure II).

1. Screw out the both sides of adapter connector 2.
2. Screw out the lock nut 5, pull 4, 3 out in order.
3. Tap body should be plugged in bathtub overflow hole A (Pay attention to use S2.5 wrench adjustment M4 screw length).
4. Put 3, 4 into 1 tap in order, then screw in 5 closely by wrench (Pay attention to adjust the direction and the location of the overflow of 1 Tap),
5. Clic-Clac Bath Waste 7 be installed to bathtub.
6. Put 10, 9, 8 into 6 plastic pipes in order, and put it into 7 at the port of C. At last, use the part 10 plastic nut to lock part 7 bath waste.

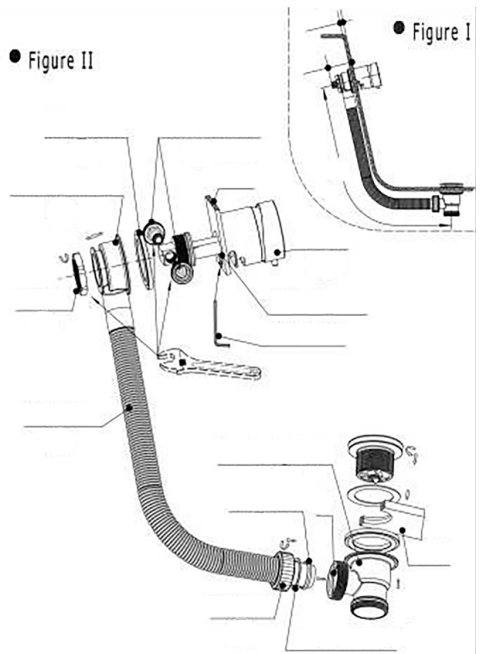

● Figure III

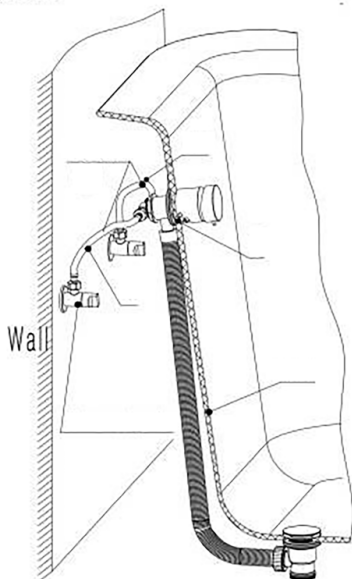

● Figure IV

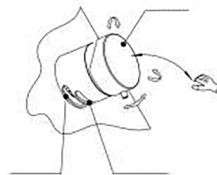

7. Screw two adapter connectors 2 in 1 tap body ,and connect to inlet tube 11 (as Figure III, Pay attention to the direction of the cold and heat water inlet),
8. Turn on water supply value and handle to chock all the joints to make sure there is no leakage and the product can work normally.

V. Using instruction(Figure IV).

1. Adjust the flow rate and the water temperature: move the handle by hand.

Cleaning

All surface should be cleaned using a clean damp cloth. No abrasive cleaning agents or materials should be used.

