

BAGNODESIGN

EXPERTLY CRAFTED BATHROOMS

Installation Guide

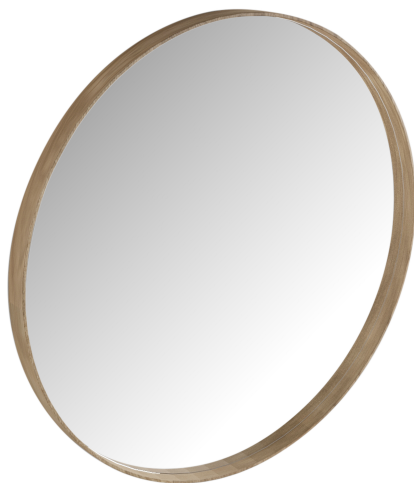

MIRRORS

NON-ILLUMINATED MIRRORS

A member of **SANIPEXGROUP**
www.sanipexgroup.com

GENERAL INSTALLATION:

To the installer, please read and follow these instructions carefully, as the guarantee is only valid if the product is installed as directed.

Don't rush, read the instructions first and run through them before you begin, keep the fittings together to avoid loss, do not overtighten screws or bolts.

If the product is covered with polythene protective film, do not remove until the installation is complete to grant maximum protection. However, remove film where any two surfaces will be in permanent contact. If tools are required to be used on a 'finished' surface, please place a cloth or similar over the area to protect the item from unnecessary scratching.

Verify that the dimensions on the plan are the same as the ones of the product.

Please note this product can require 2 or more persons to lift and manoeuvre into position.



In some cases, where the multiple products are combined all products must still be considered individual and should be installed individually.

Additional products may be required for the installation, please check the Technical data sheet or current Price guide for information.

TOOLS REQUIRED (Not Supplied)



Drill and Drill bits:

Required when securing the bracket to the wall. Use an appropriate size bit to match the wall fixing chosen (screws and fixings may not be supplied with the product).

- * Screwdriver
- * Electrical Screwdriver
- * Tape measure
- * Pencil
- * Spirit Level
- * Hammer

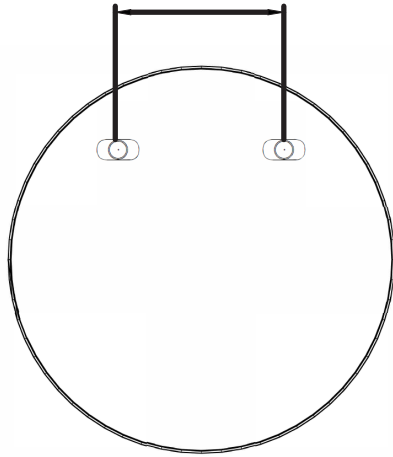

To use the measure tape to measure the distance between the two holes.

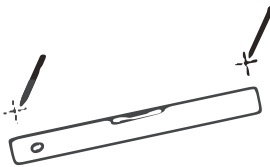

Horizontal the leveling instrument
Mark the distance between two holes on the wall with a pen

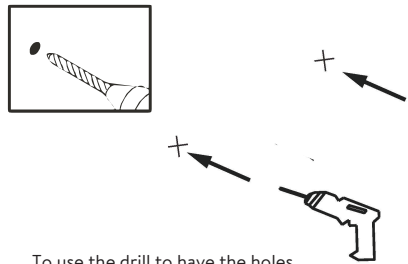

To use the drill to have the holes

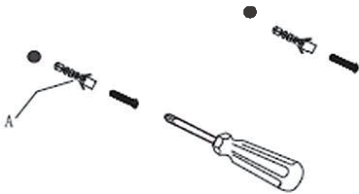

(Apply to the solid wall)
Put the expansion plug into the wall hole, both the wall holes and the hanging holes are match.
To use the screwdriver to make the screw tightly.

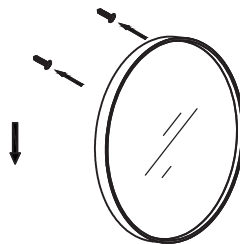

Hang up the mirror, shake left and right to see if it is stable.

