

TUBES

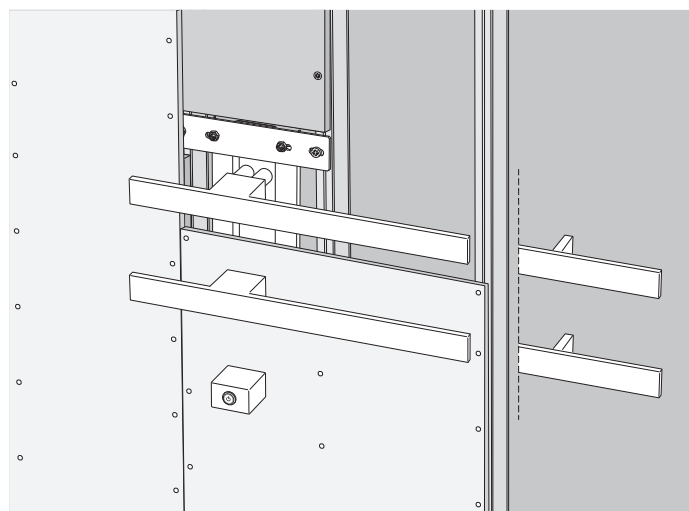

VIDEO TUTORIAL

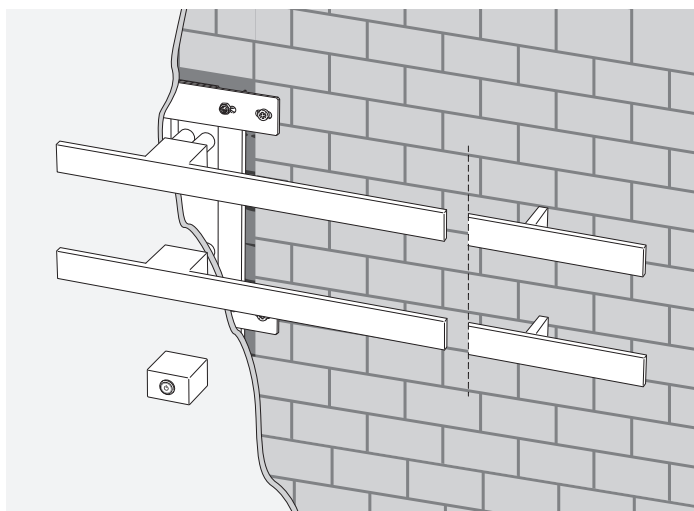

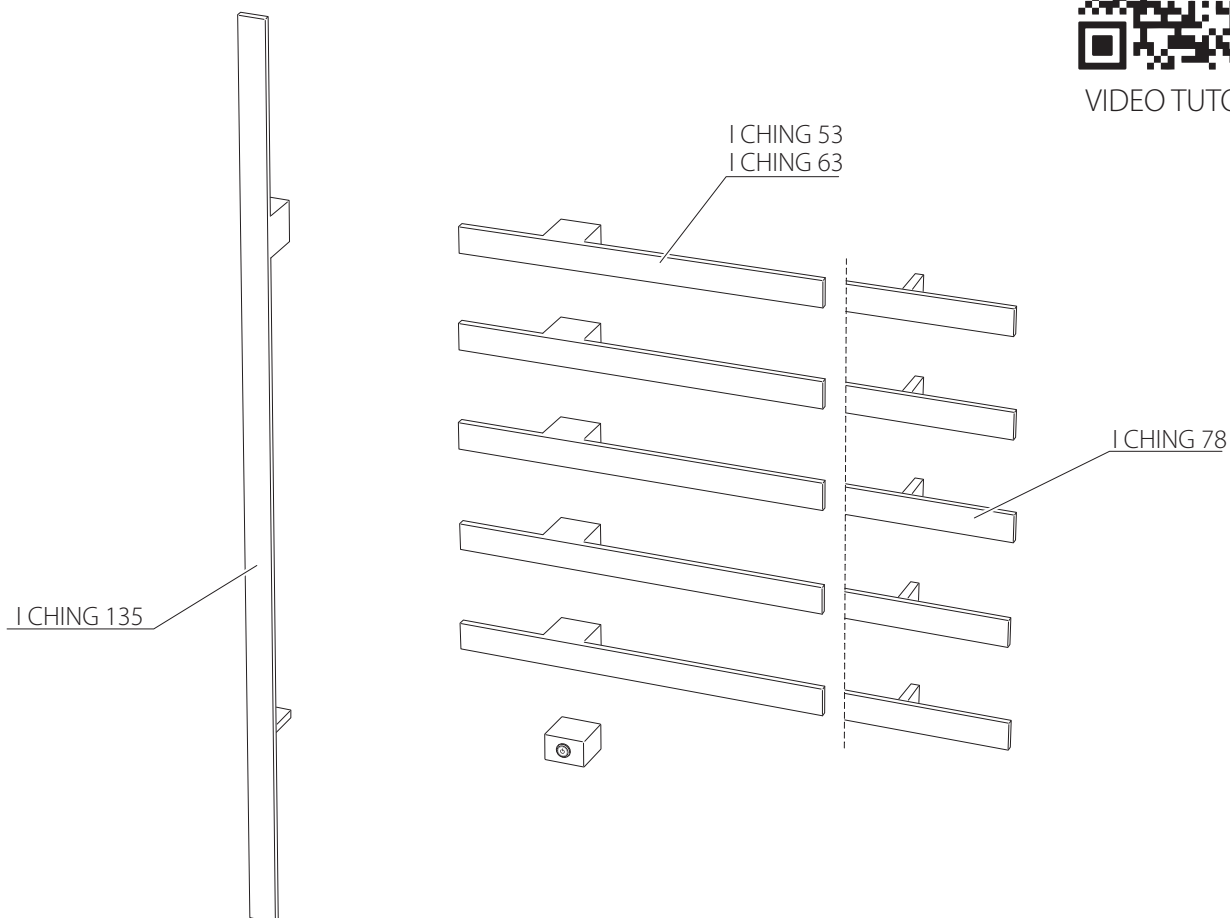
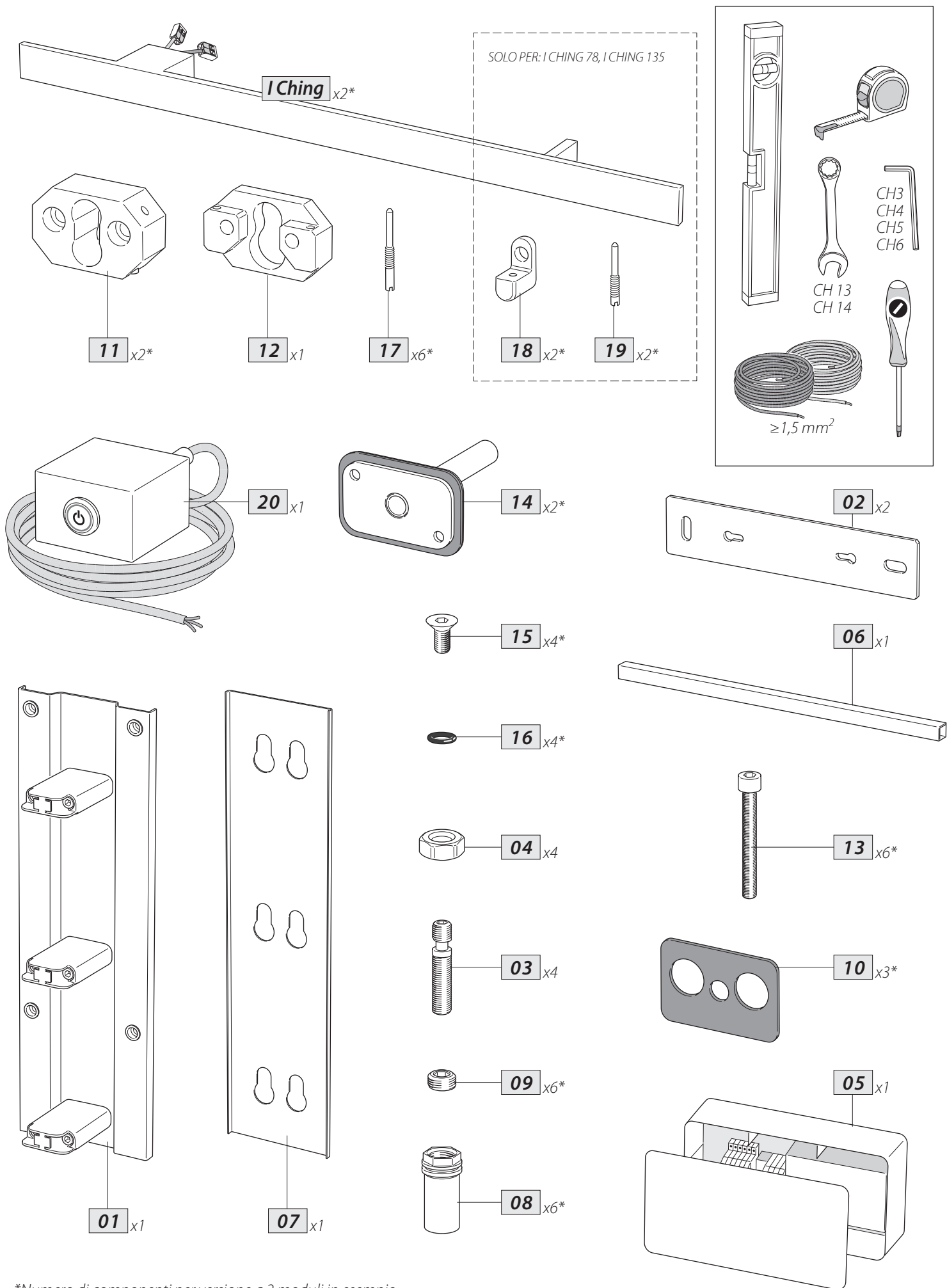

*Numero di componenti per versione a 2 moduli in esempio

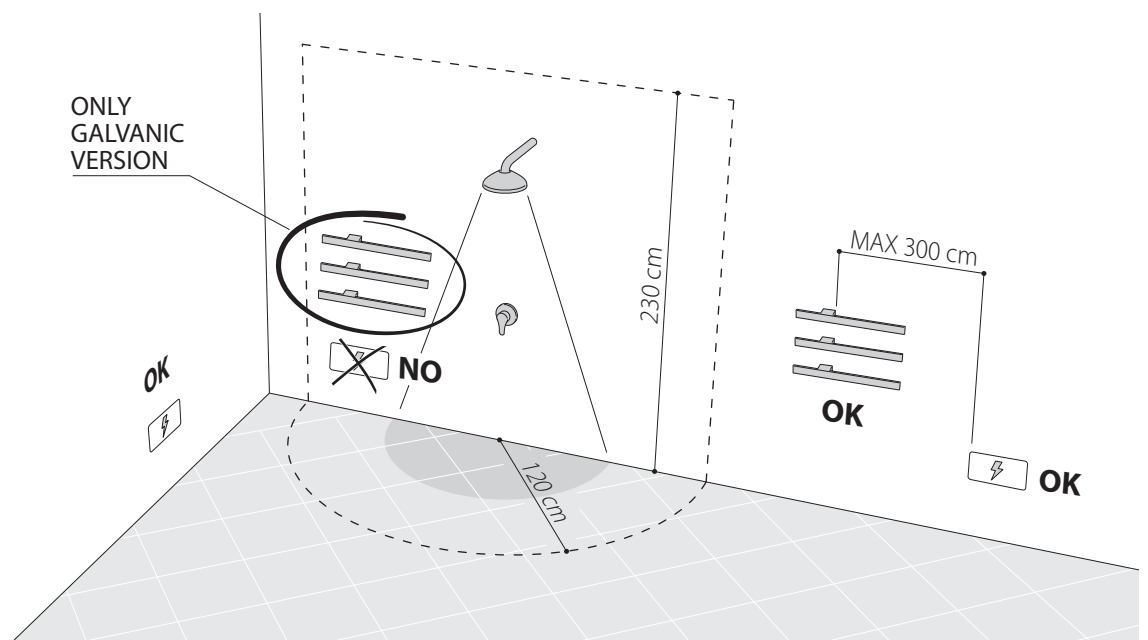
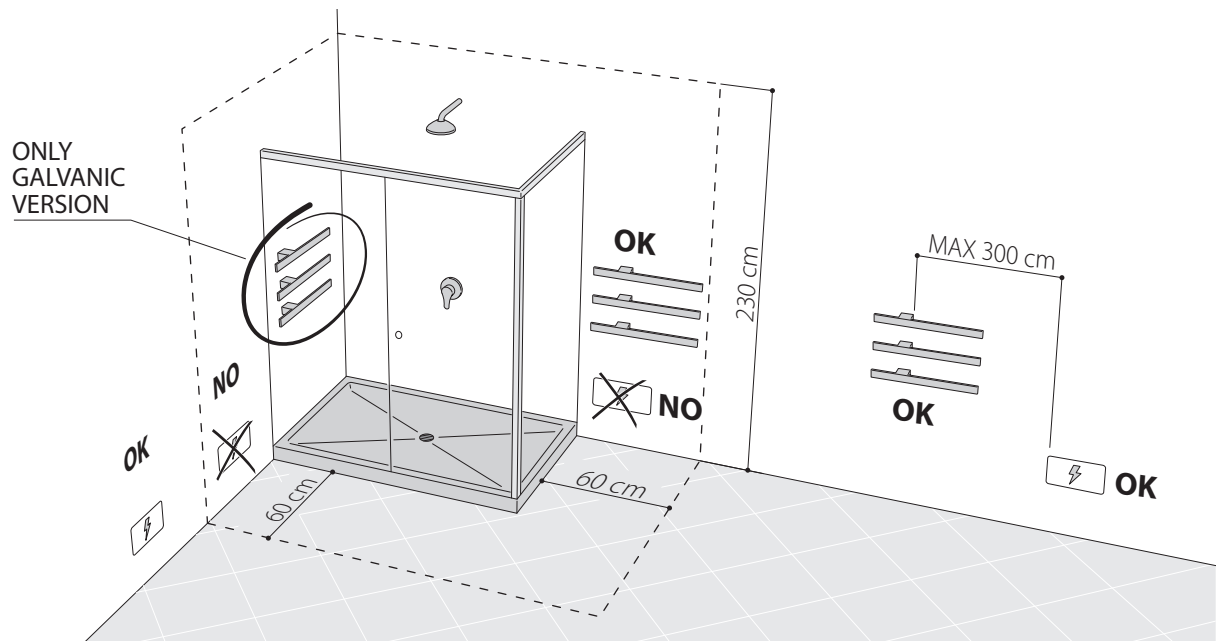
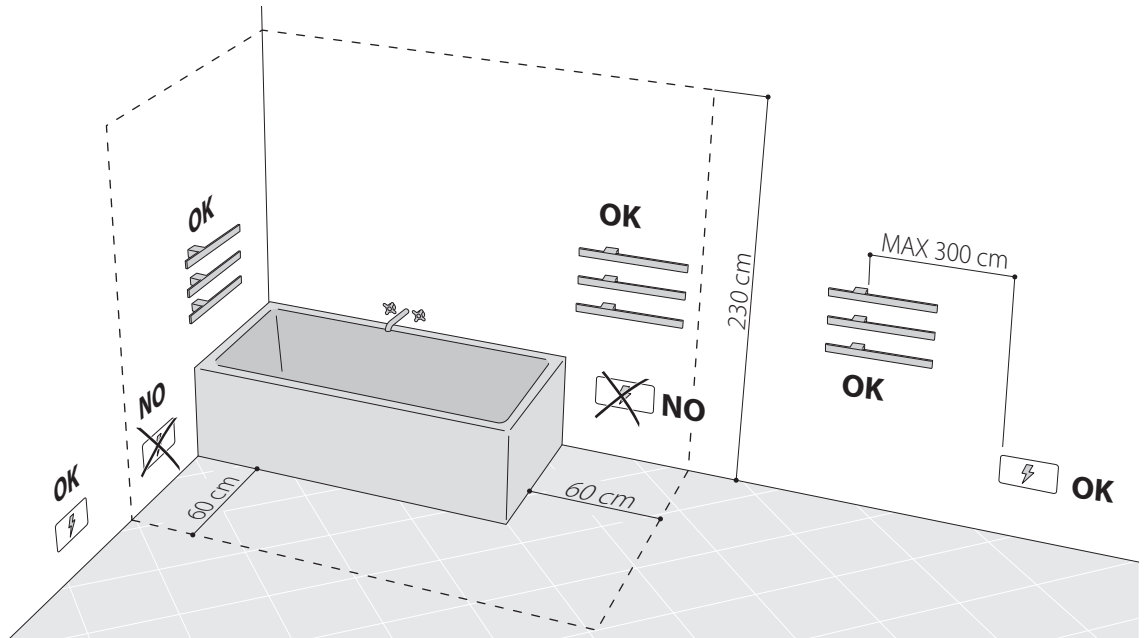

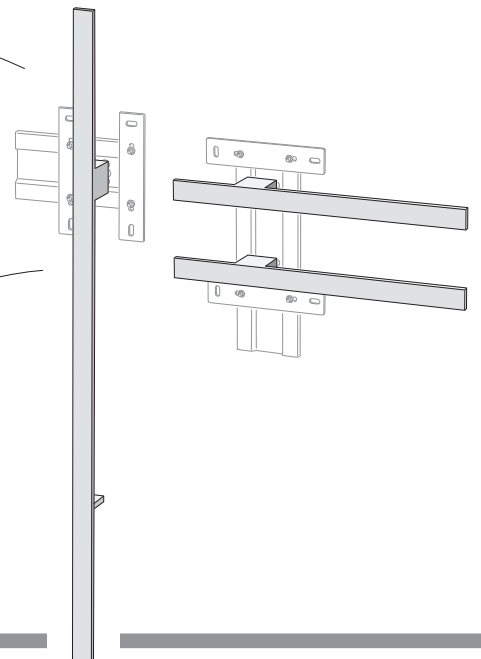
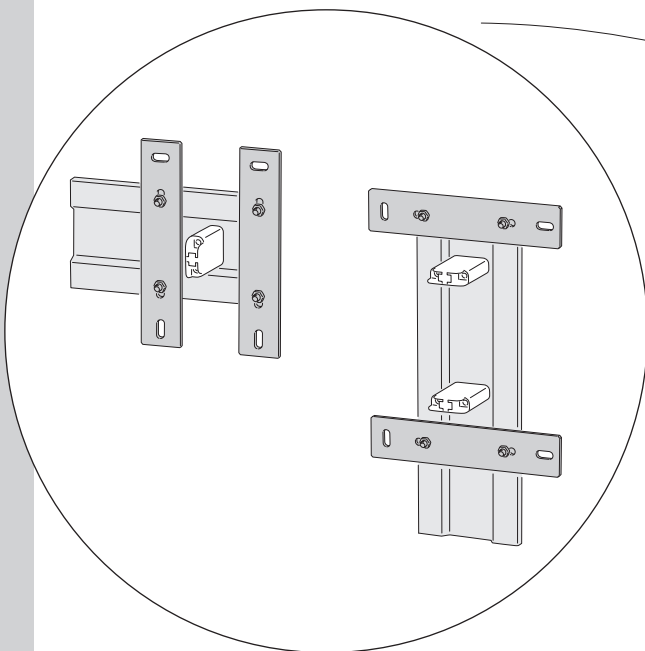
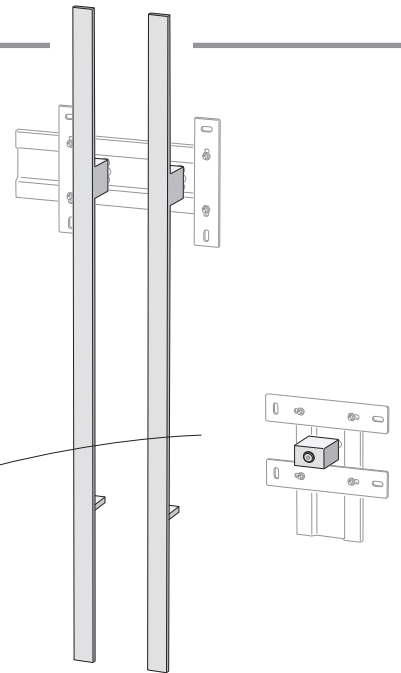
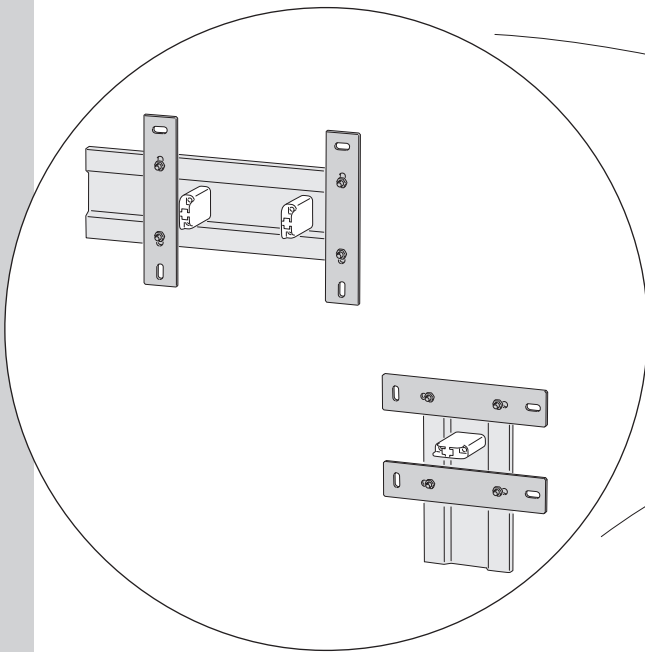
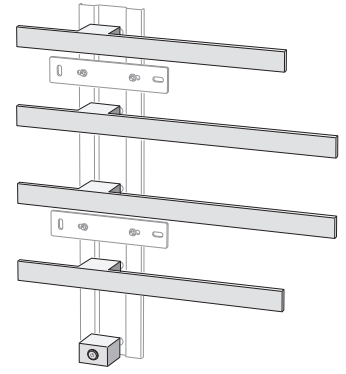
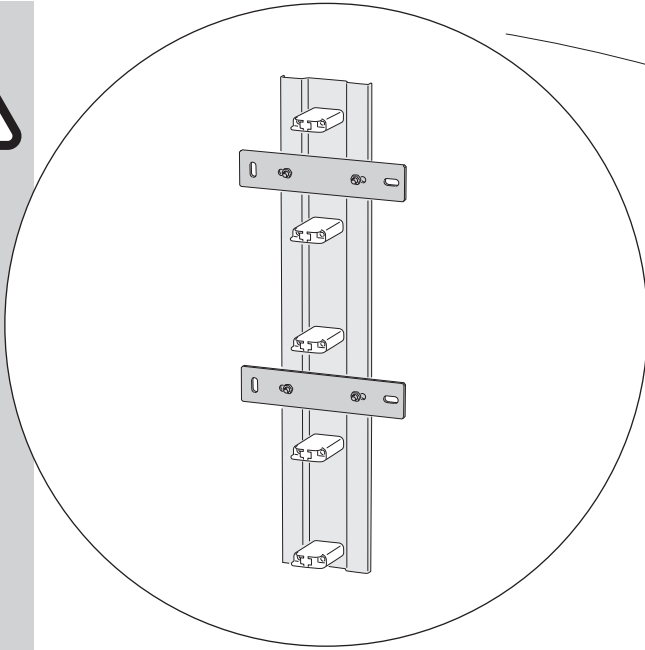

1

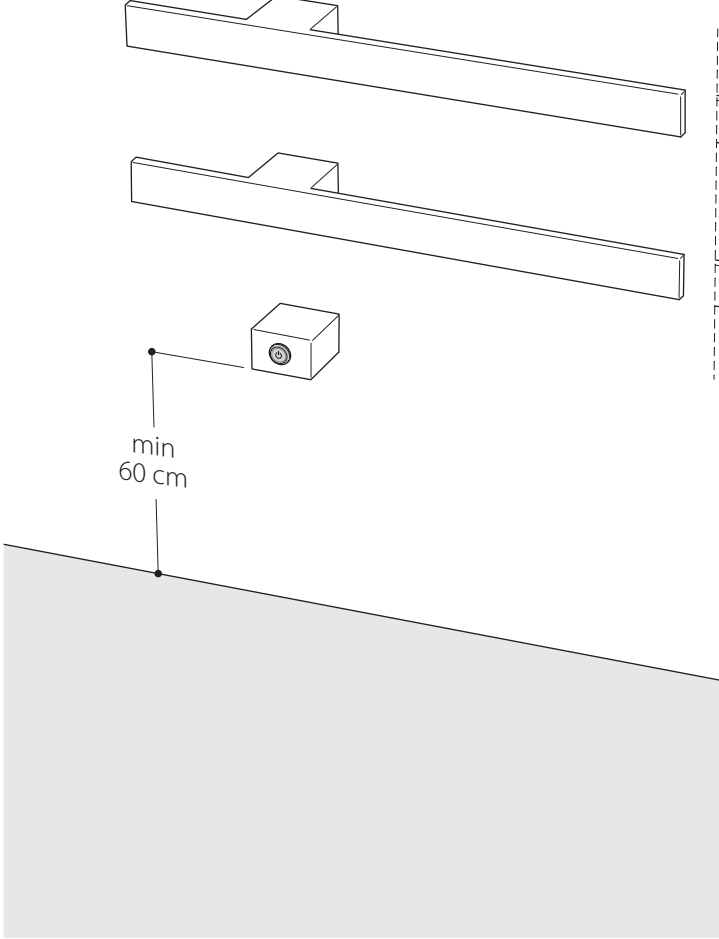

	I CHING 53
	I CHING 63
	I CHING 78
	I CHING 135

2

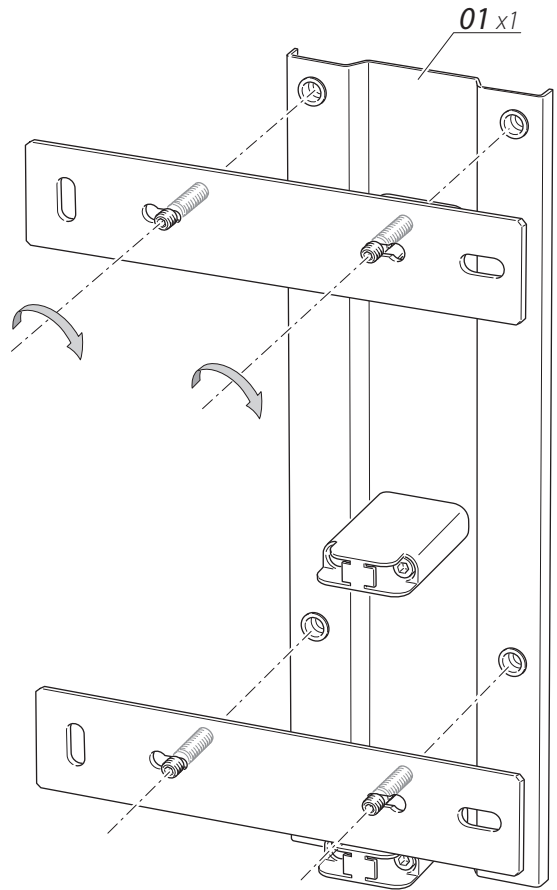
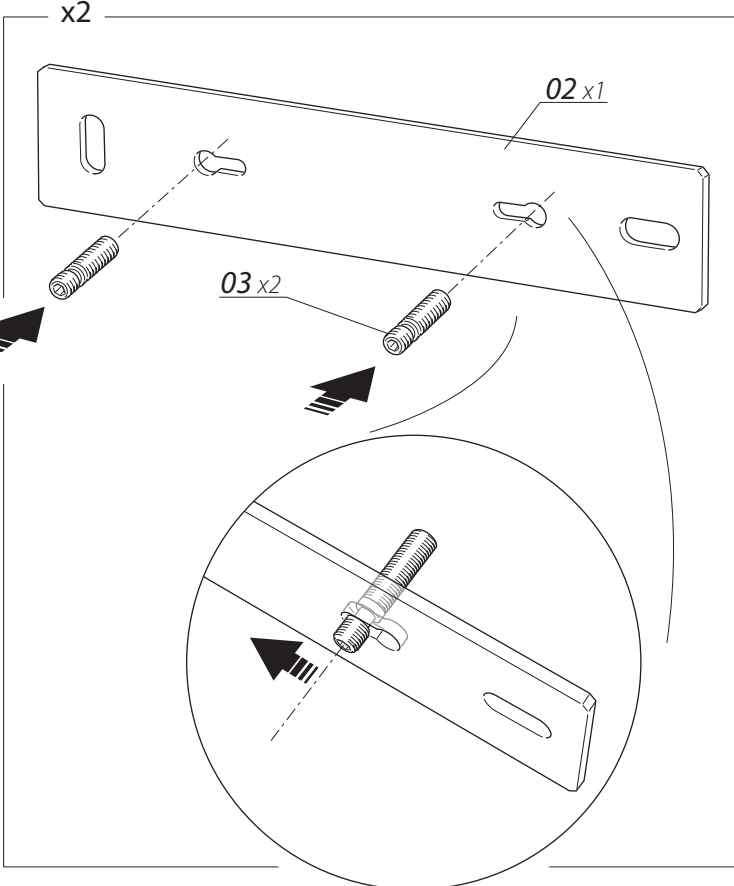

3

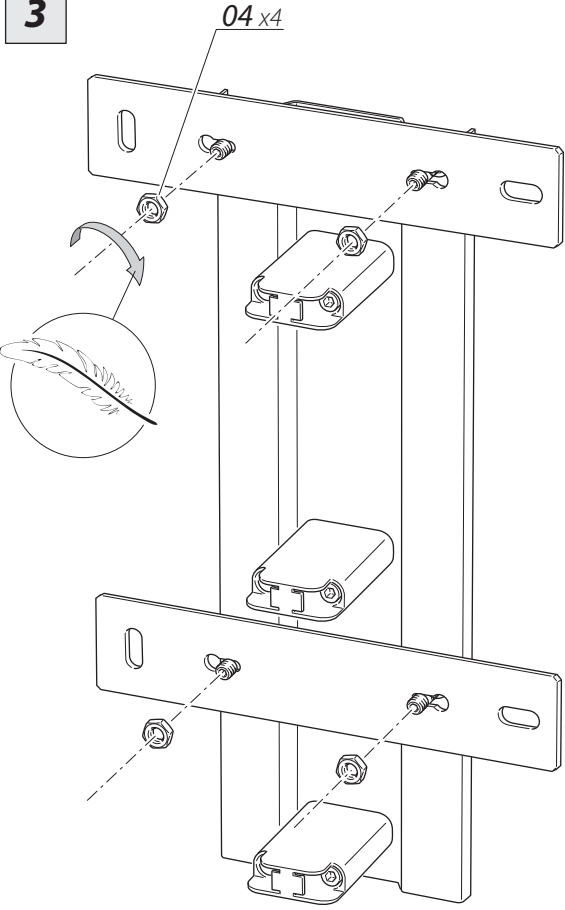

4

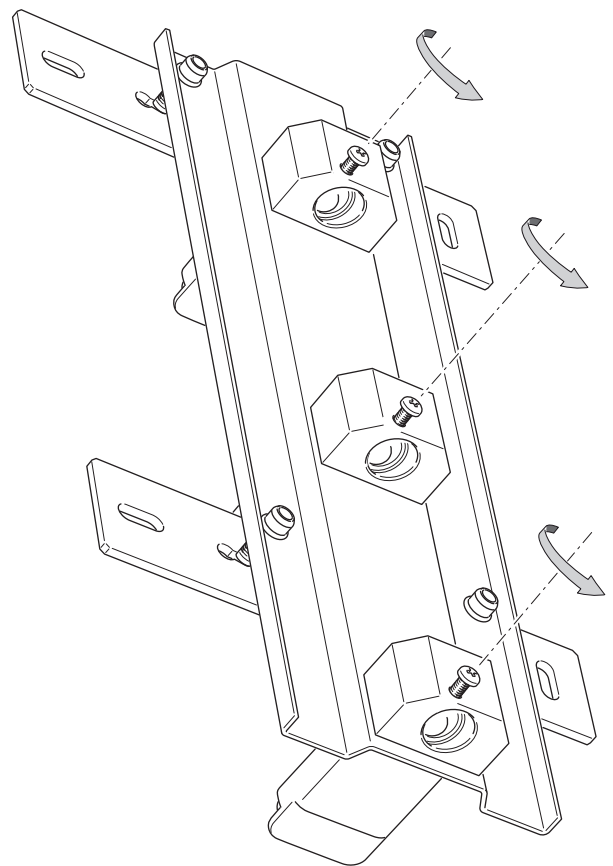

5

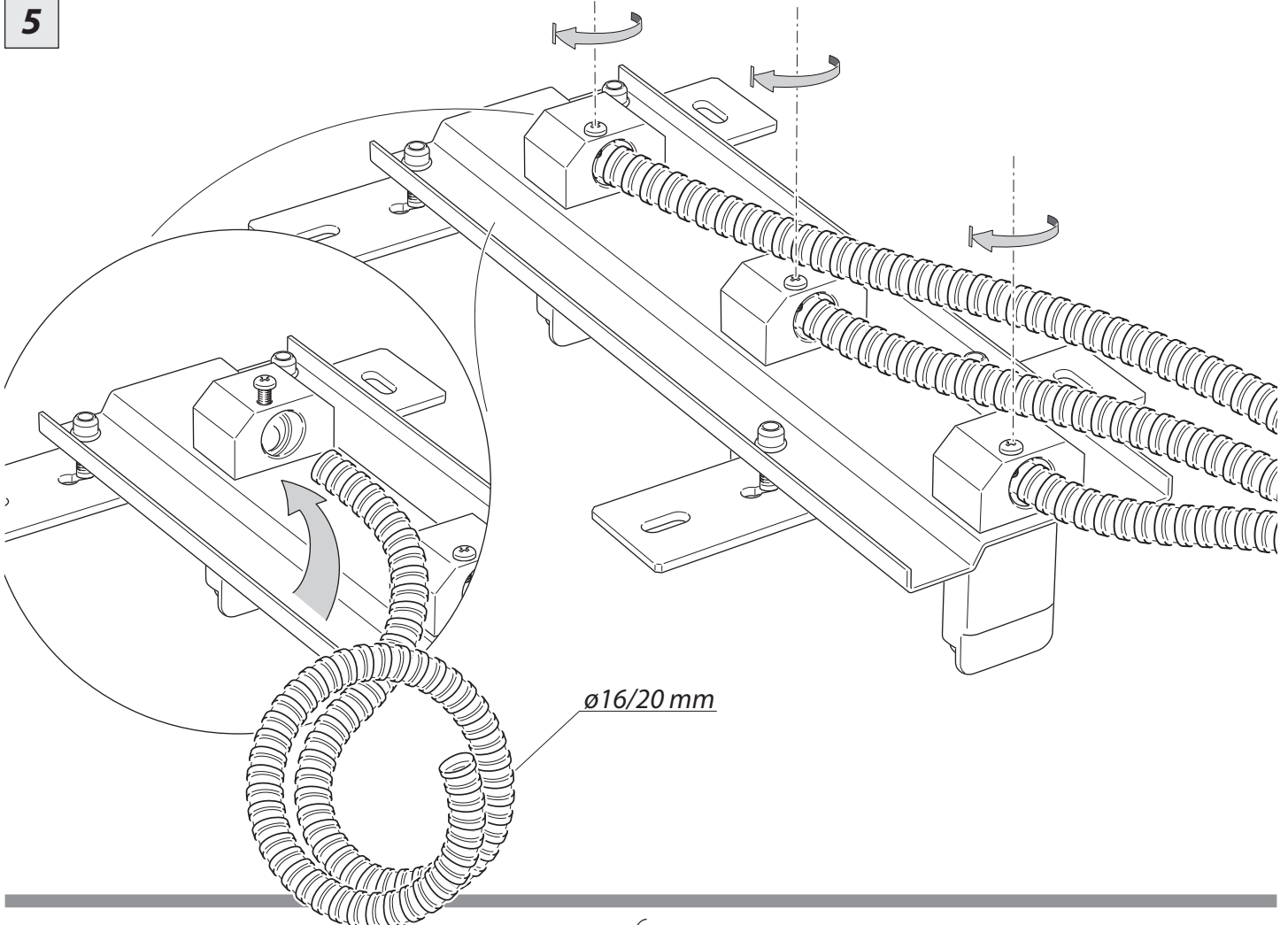



▶▶ pag 8 7

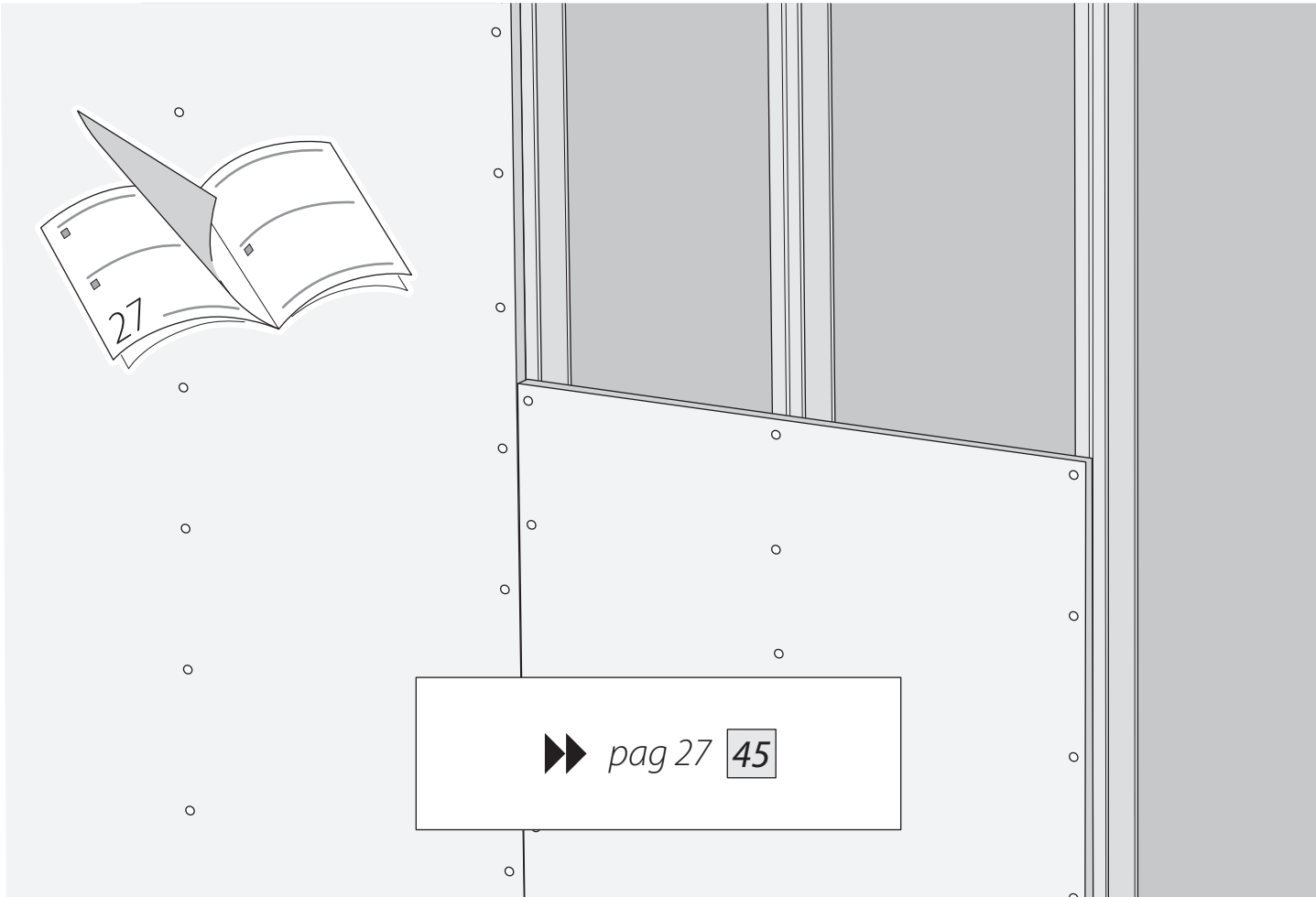

▶▶ pag 27 45

7

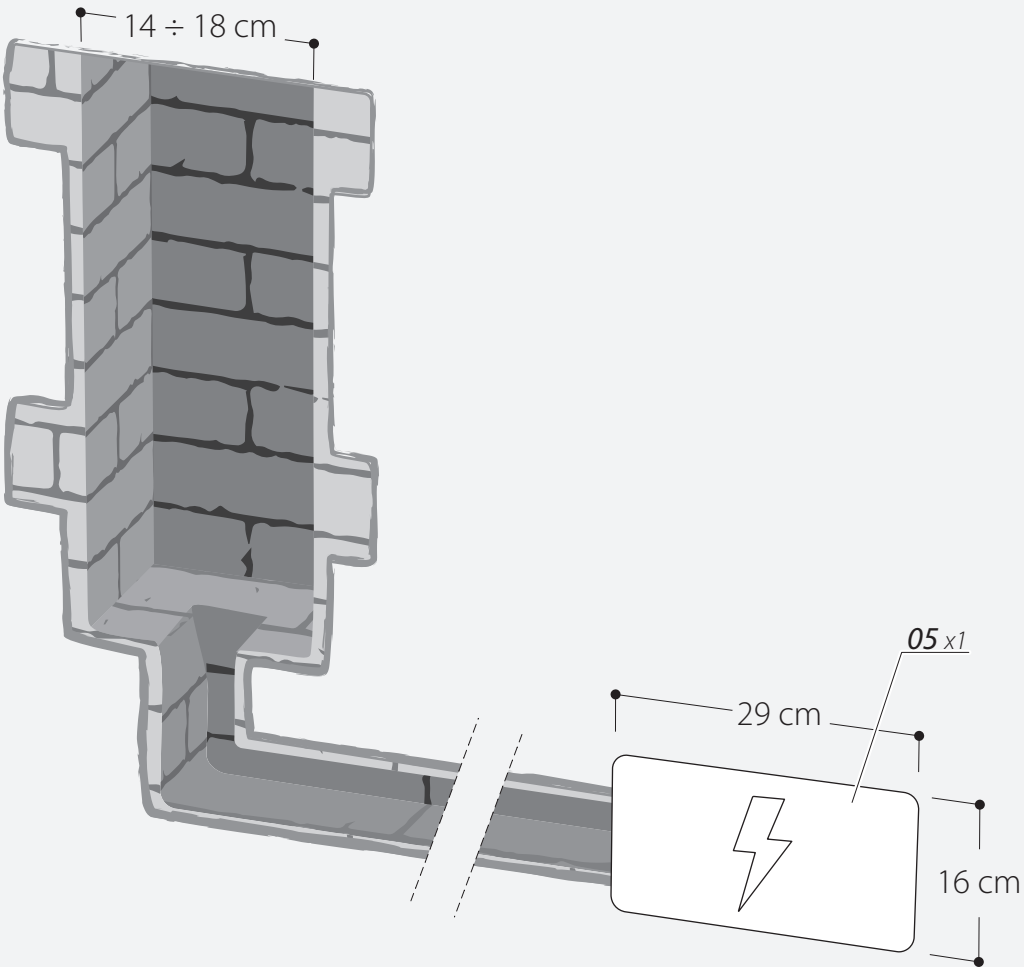

8

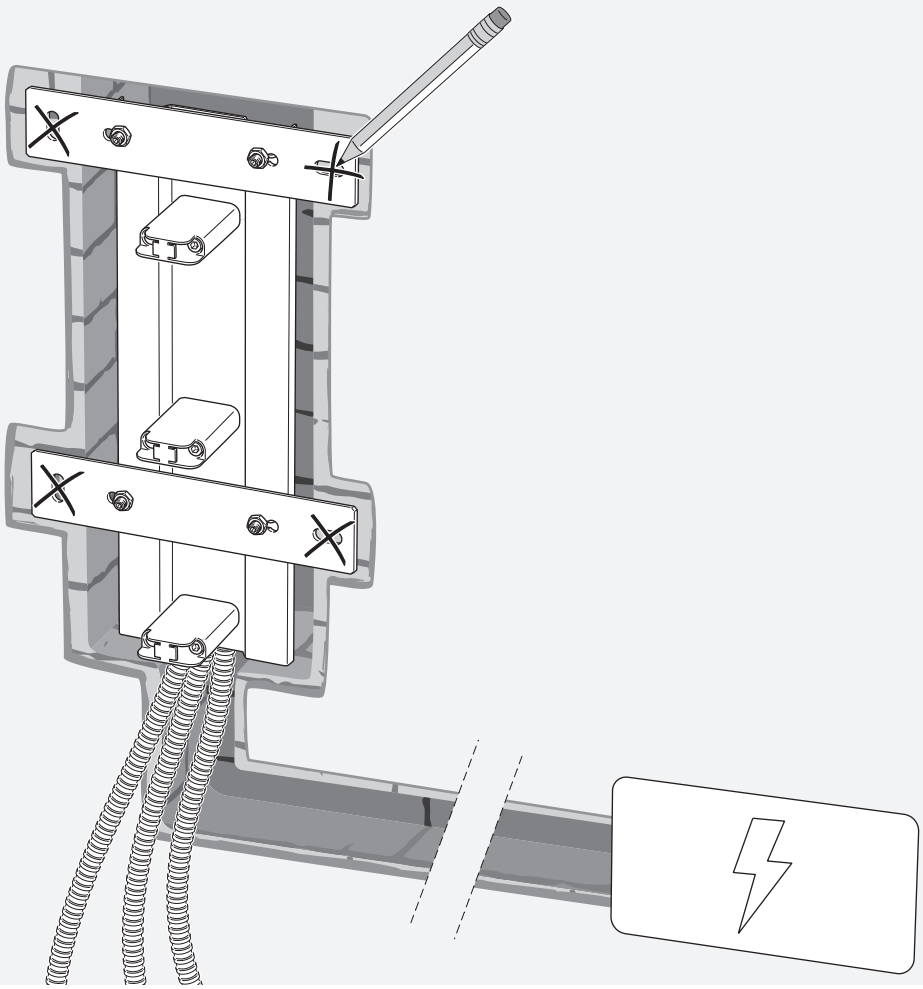

9

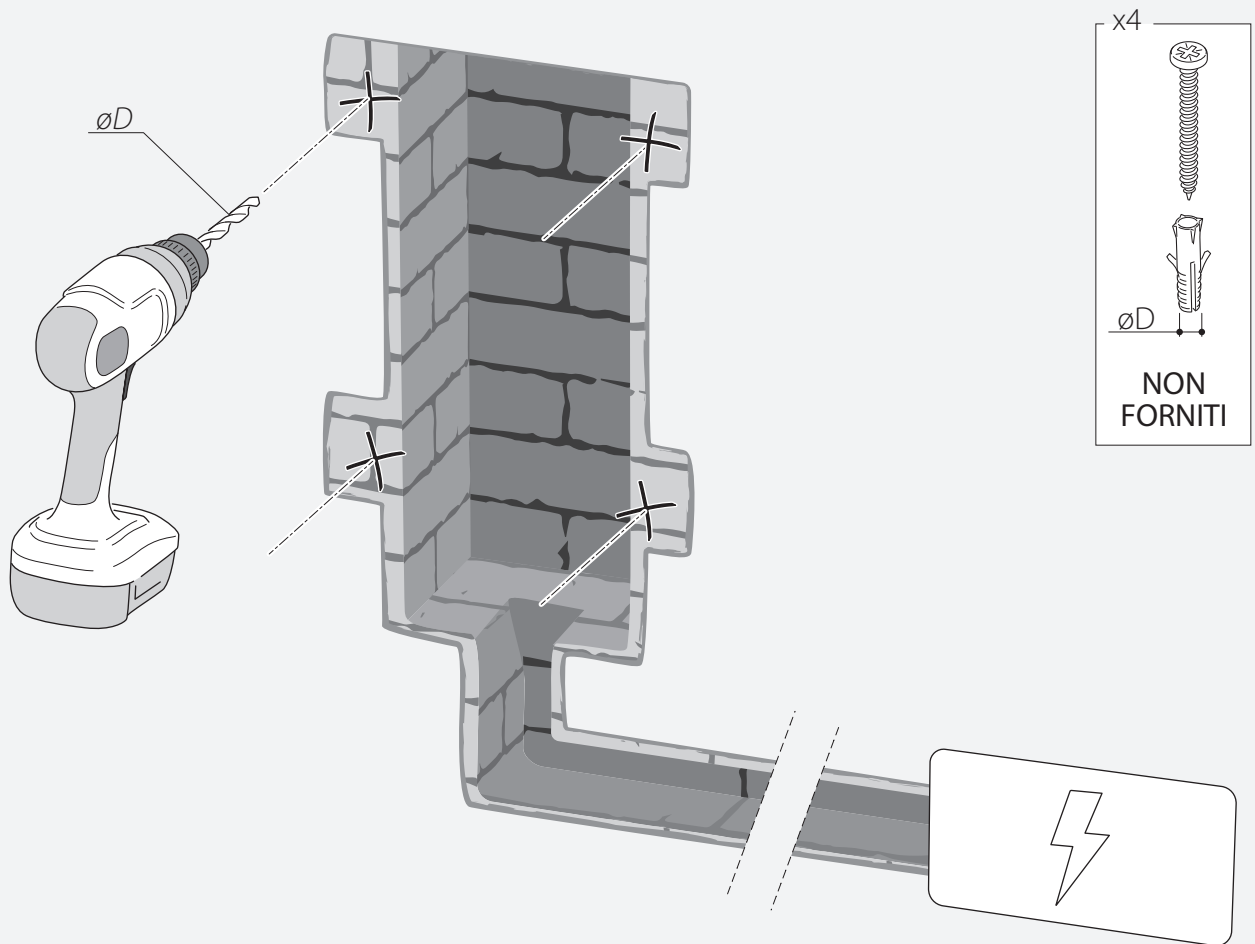

10

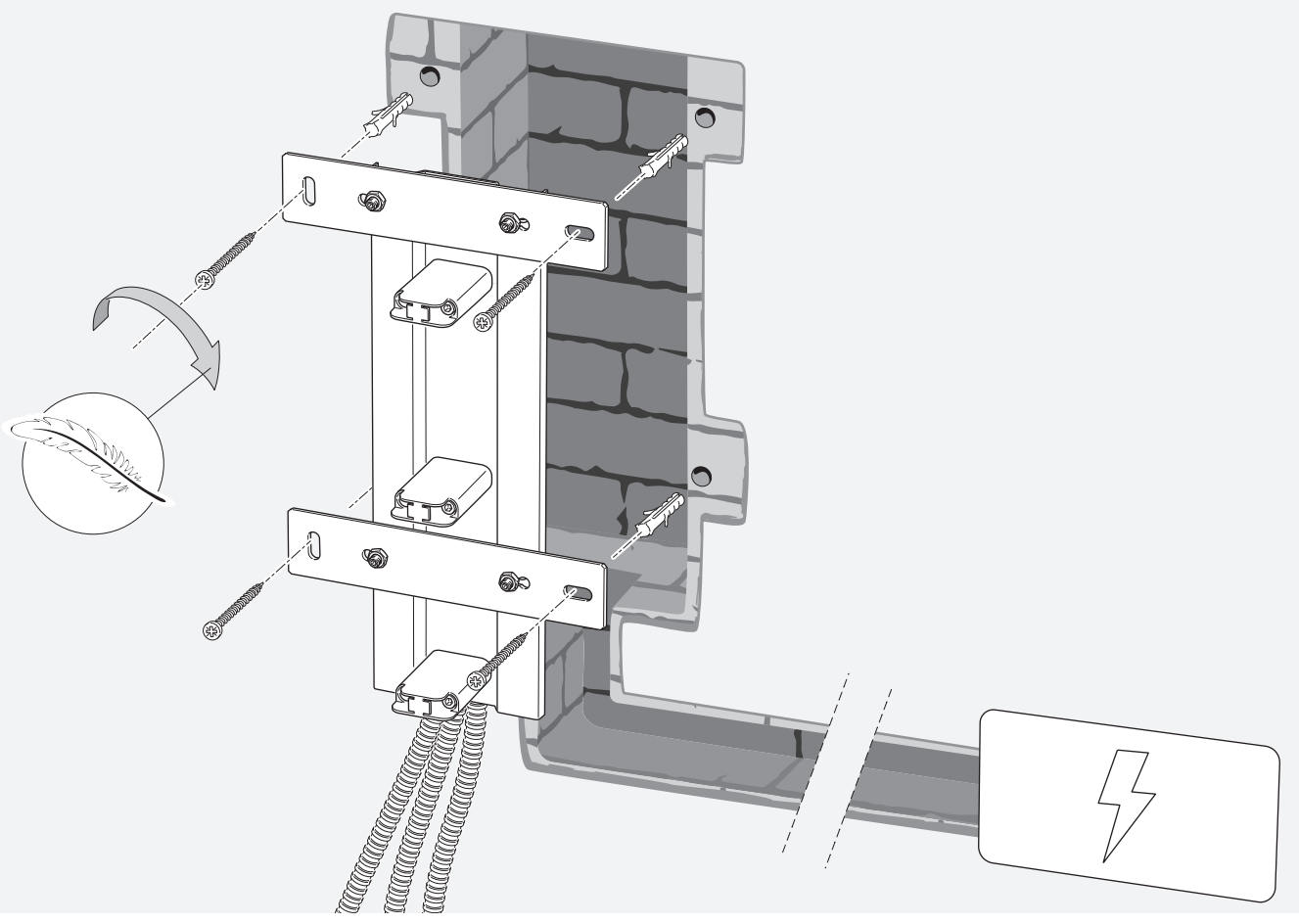

11

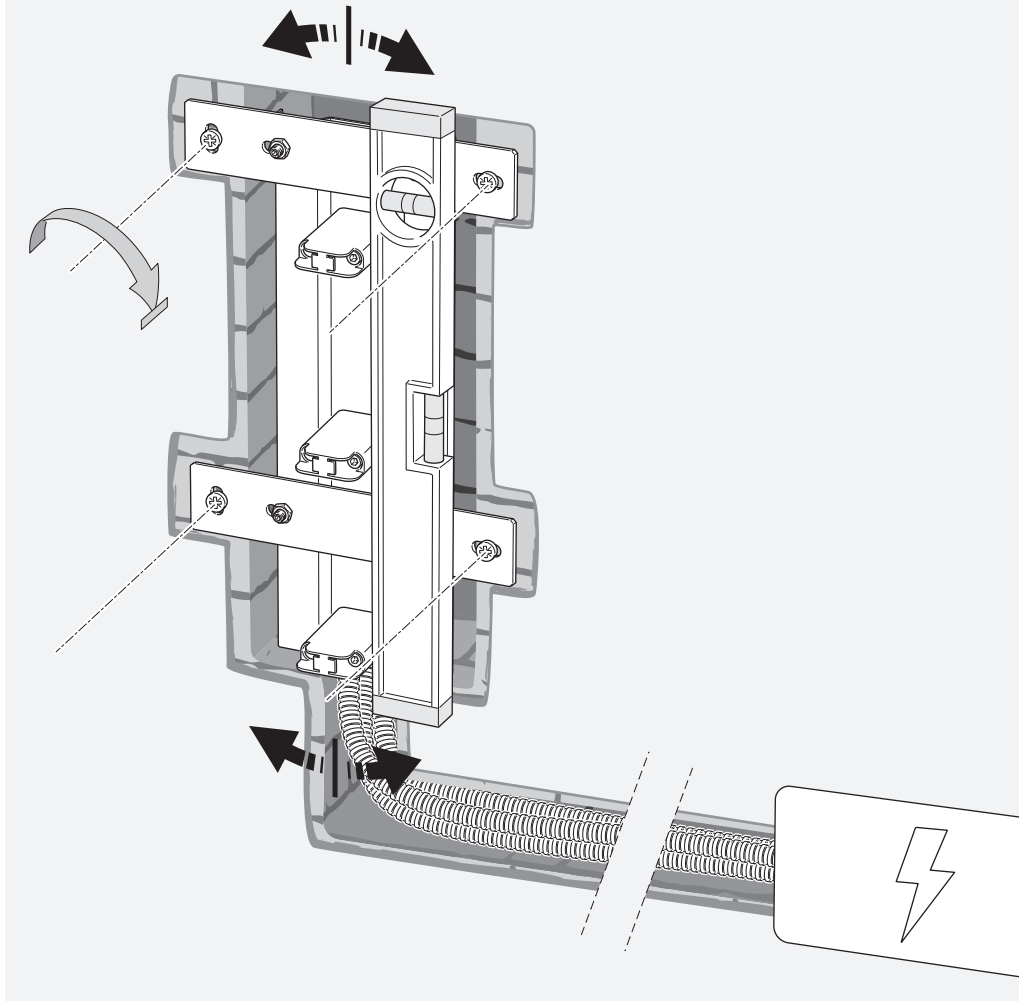
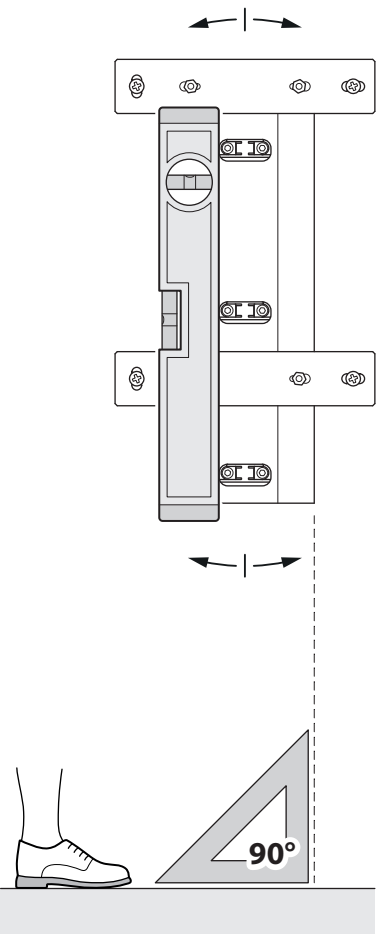

12

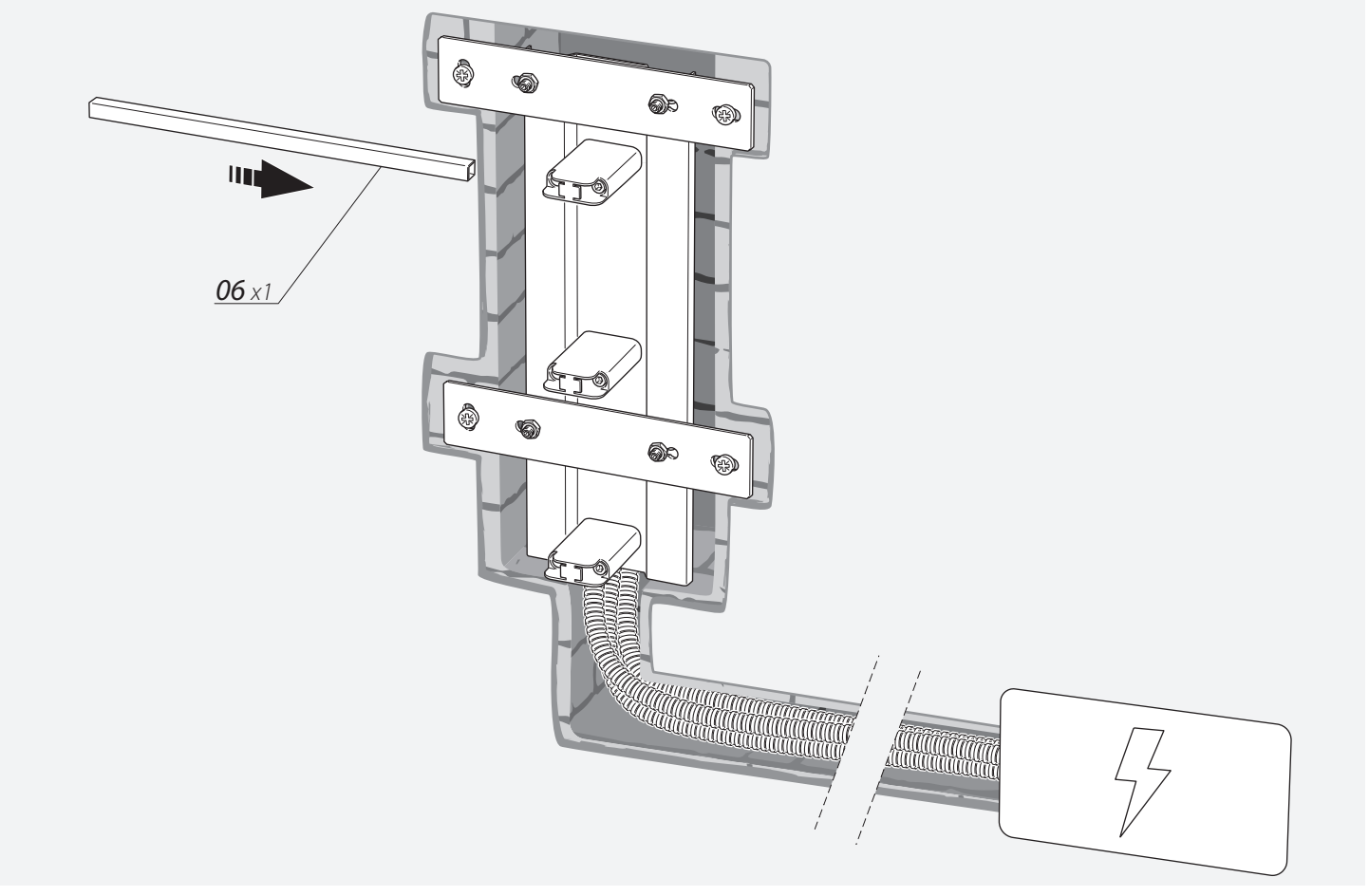

13

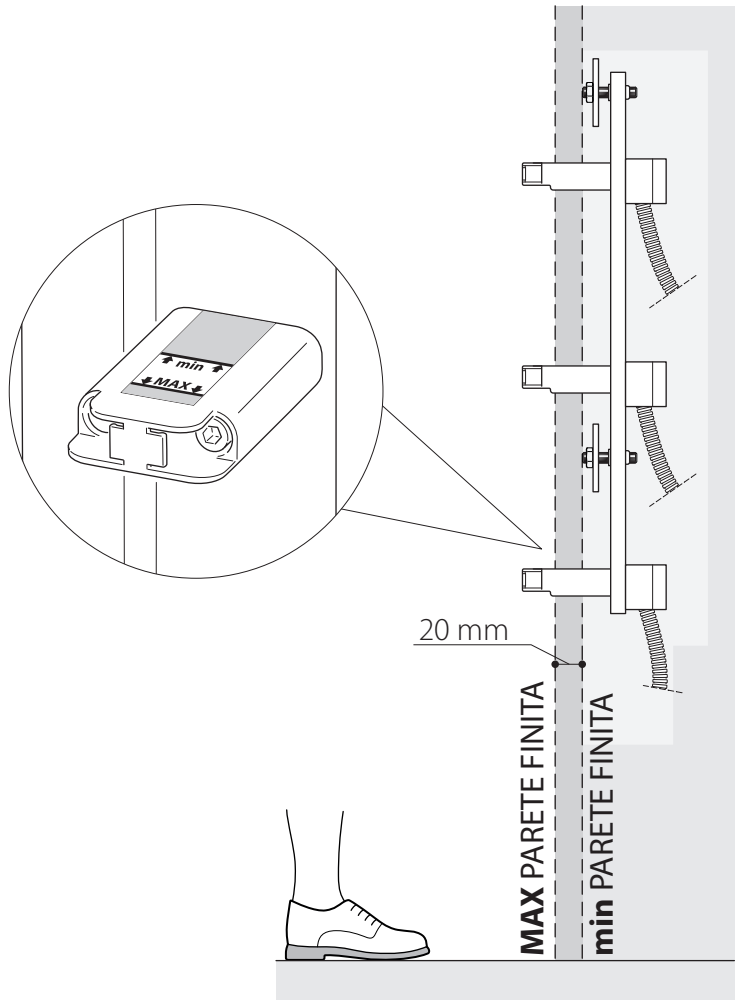
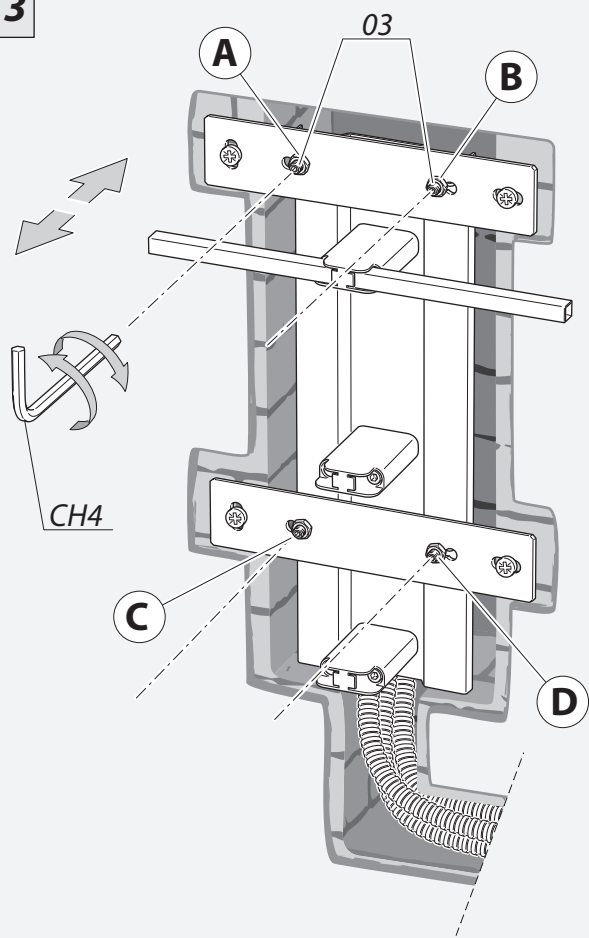

14

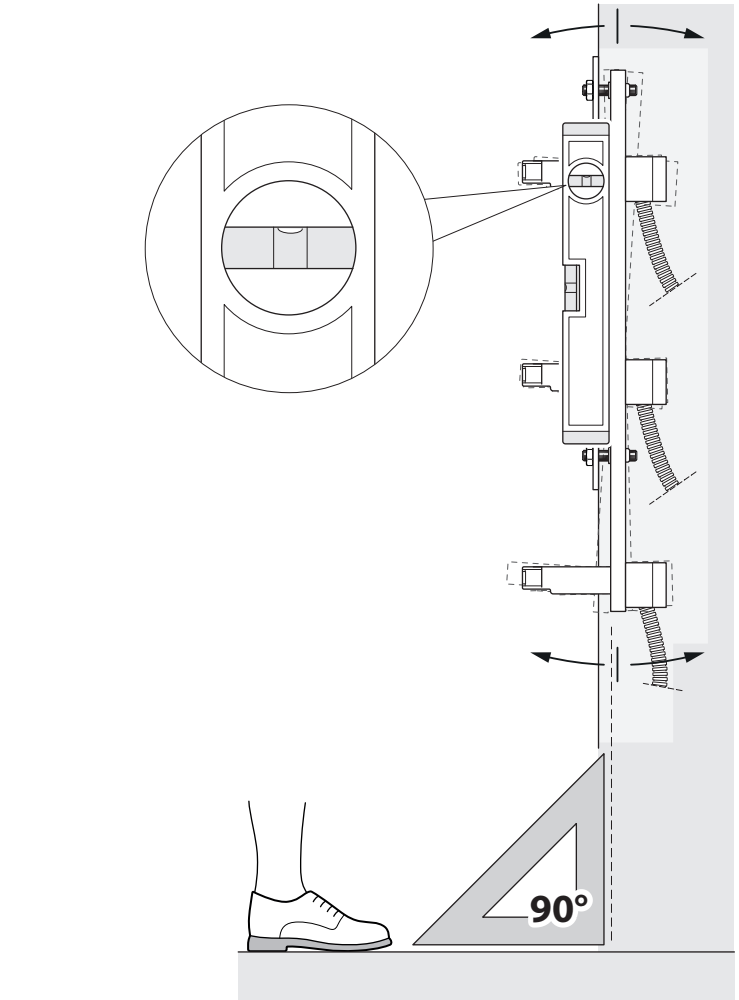
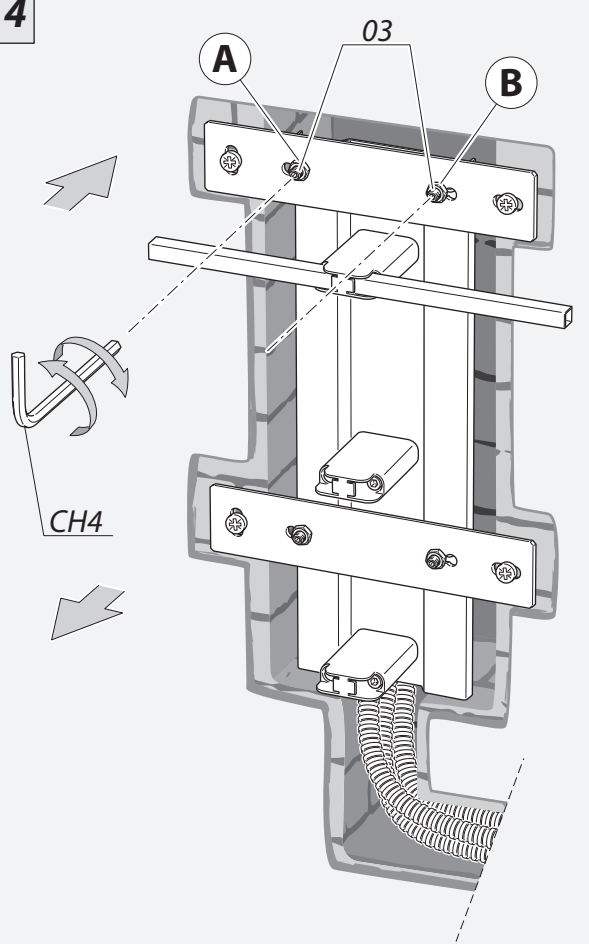

15

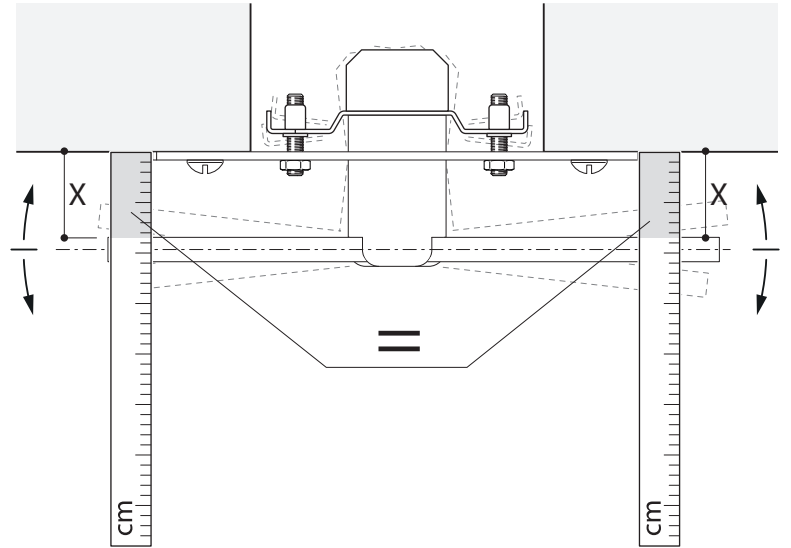
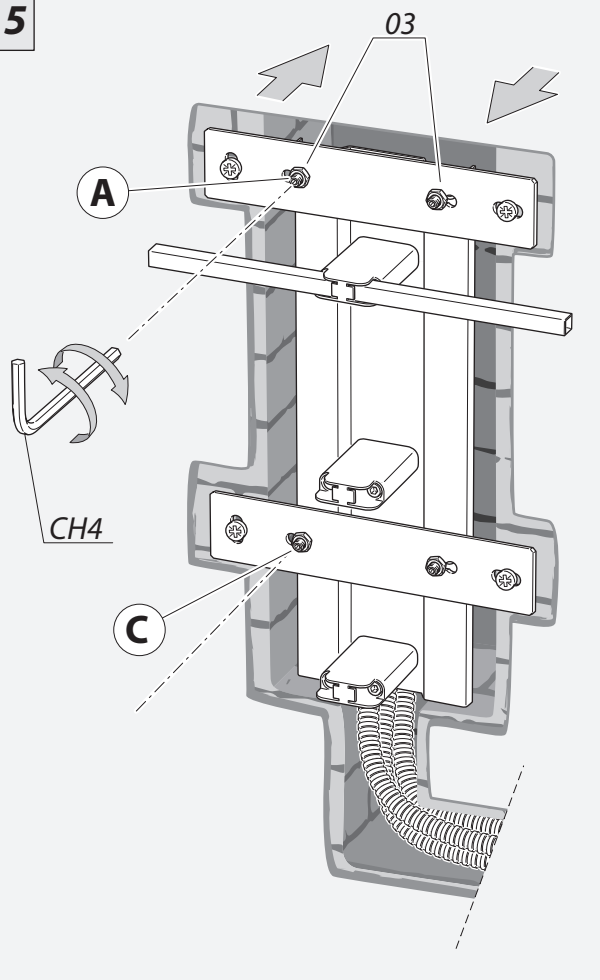

16

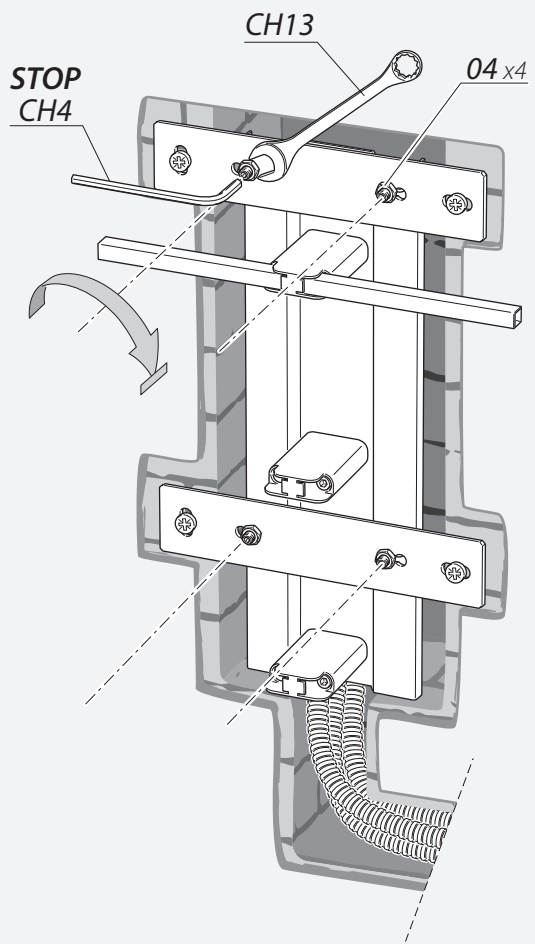

17

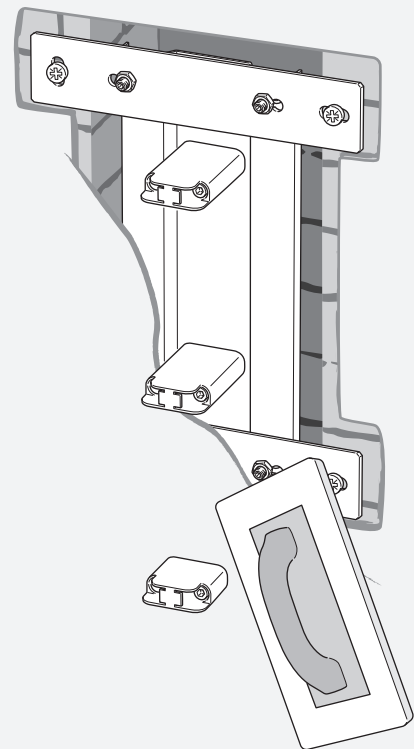

18

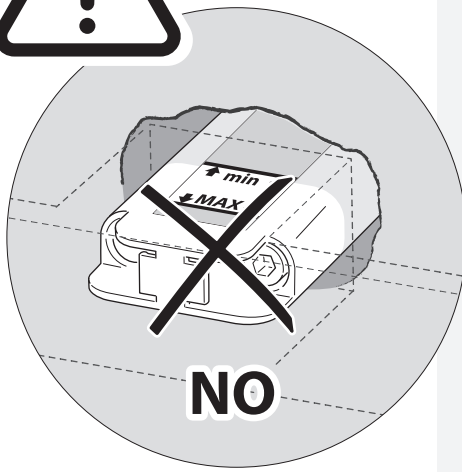
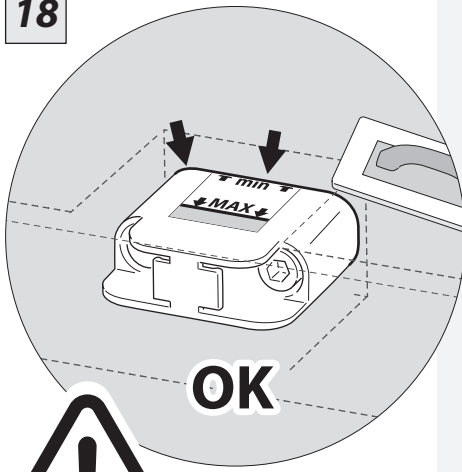

19

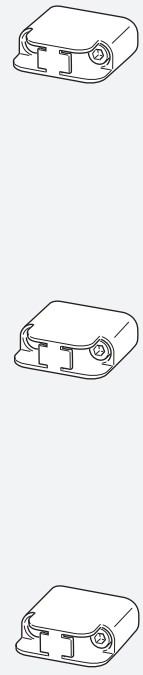
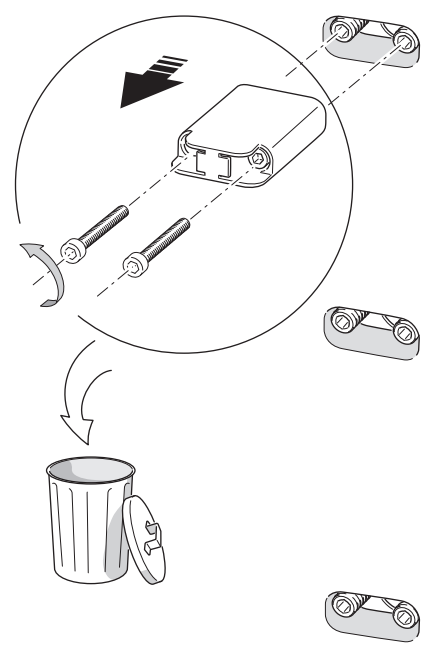

20

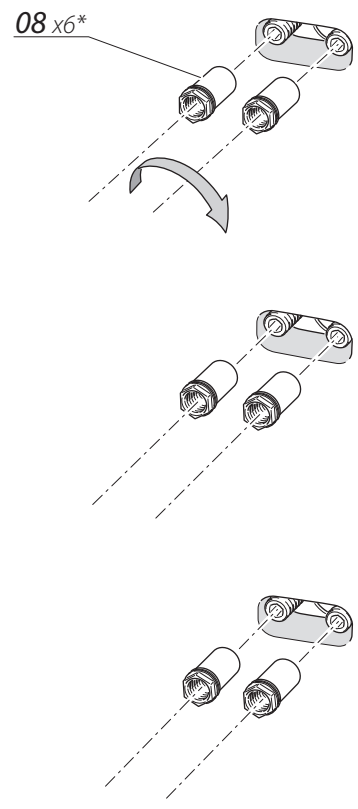

21

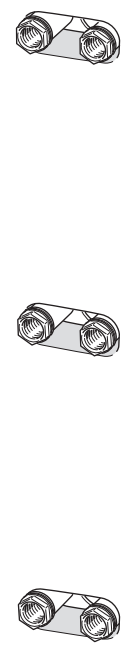

22

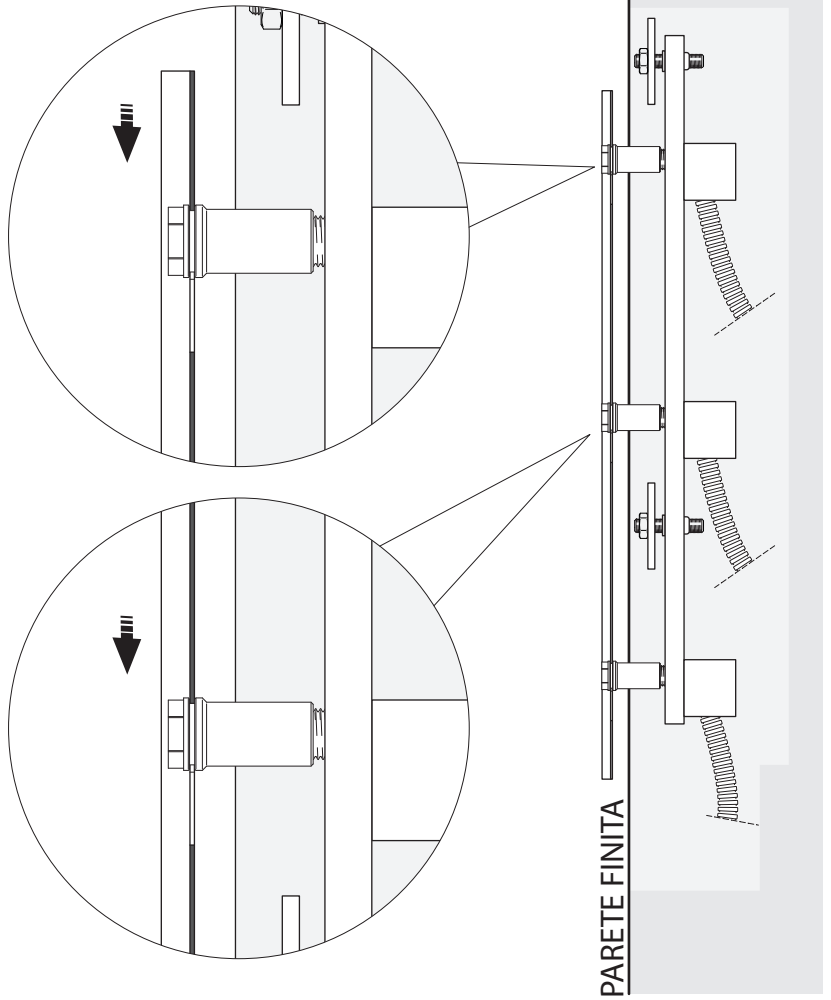
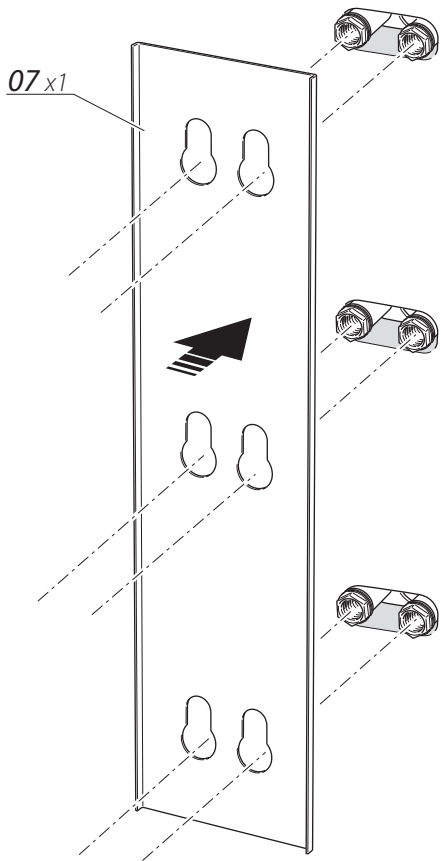

23

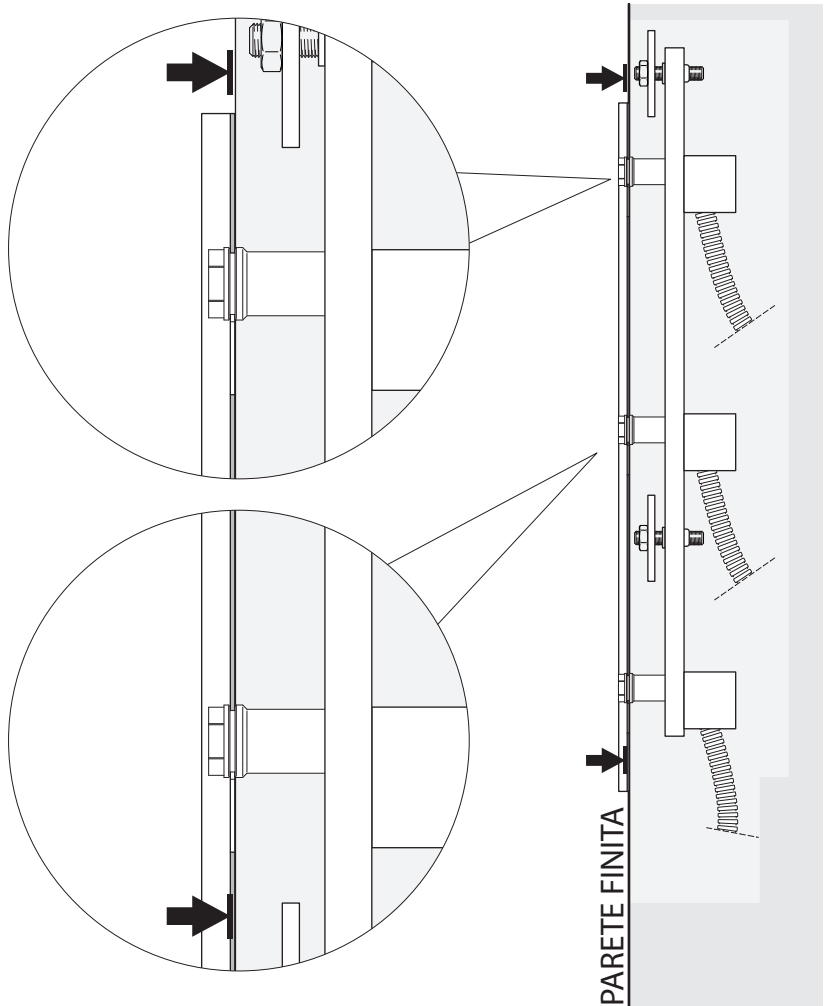
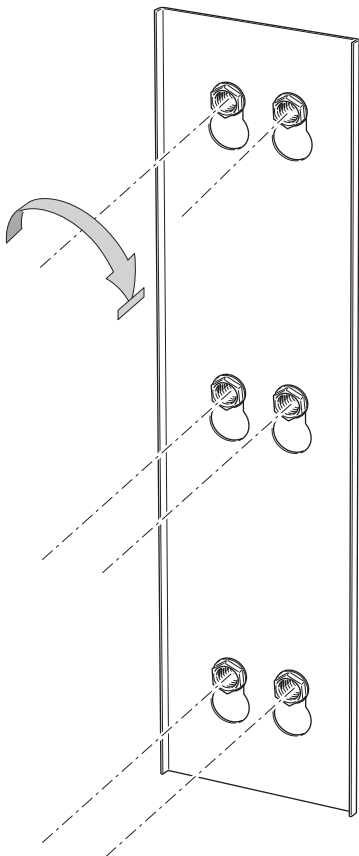

24

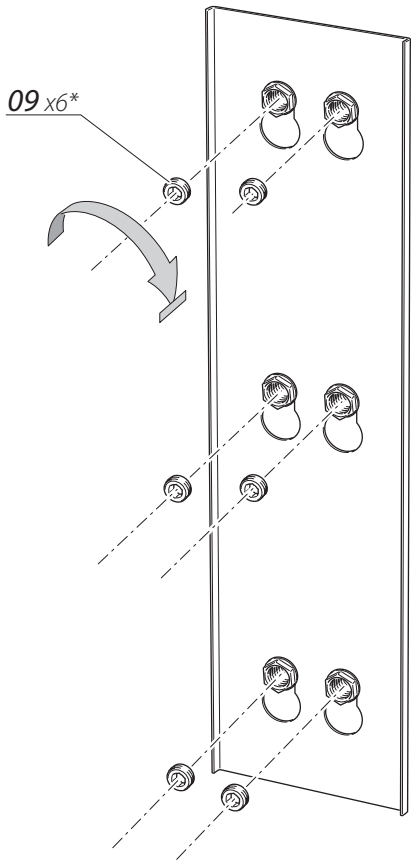

25

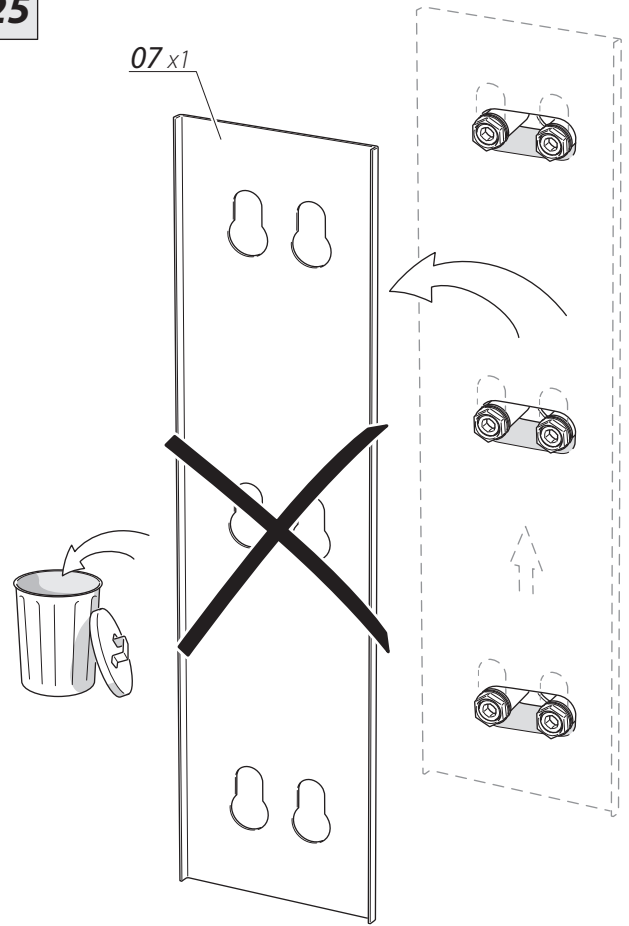

26

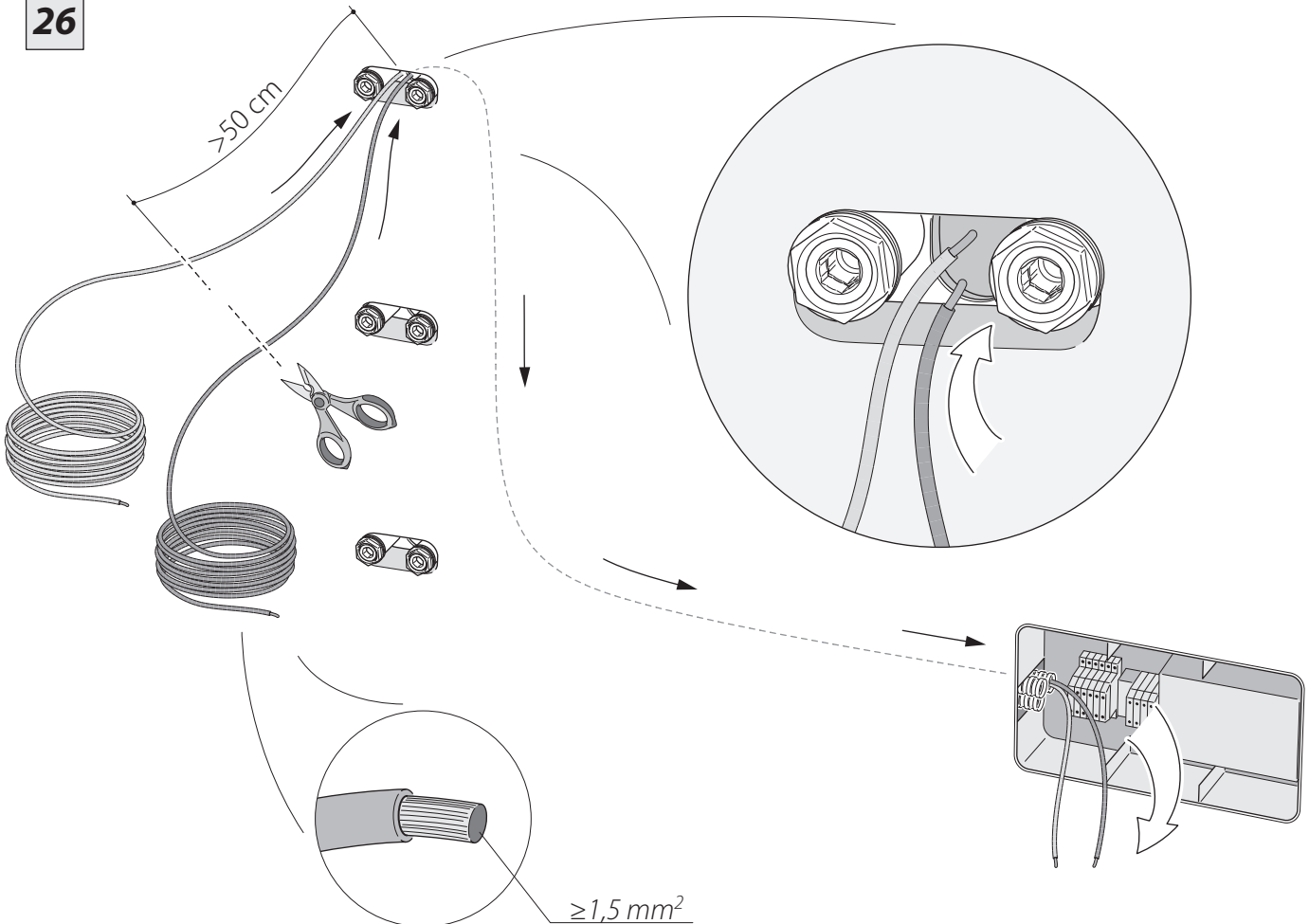

27

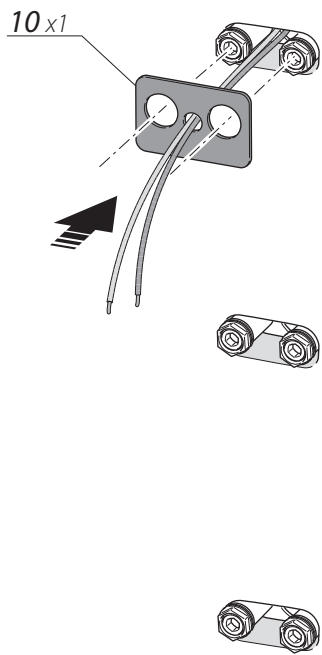

28

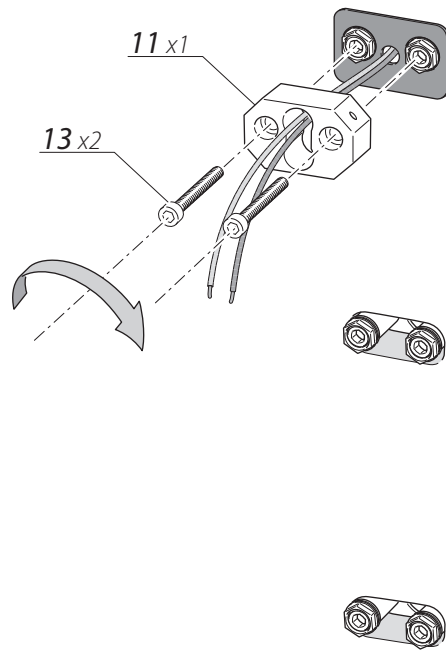

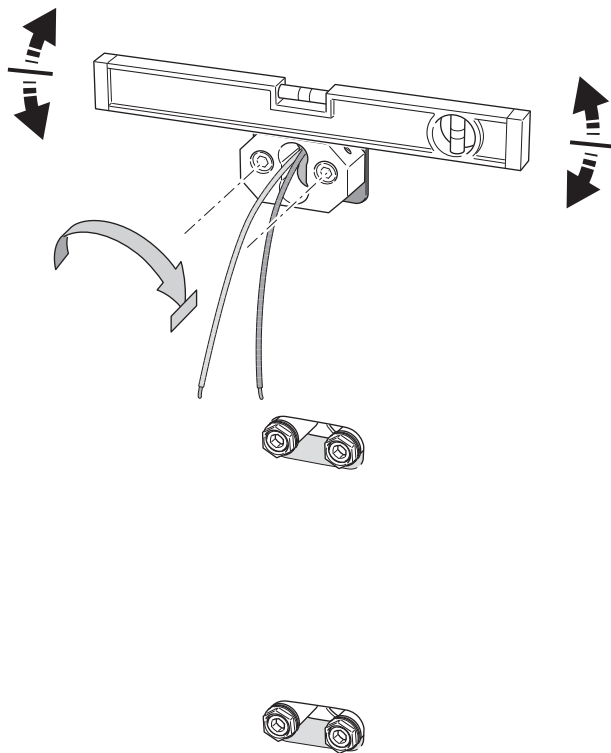

29

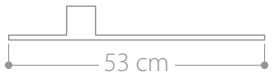

30

X [cm]

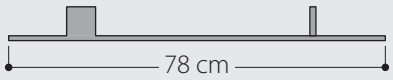
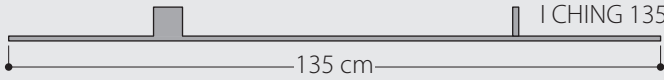
	I CHING 53	-
	I CHING 63	-
	I CHING 78	48,3
	I CHING 135	72,3

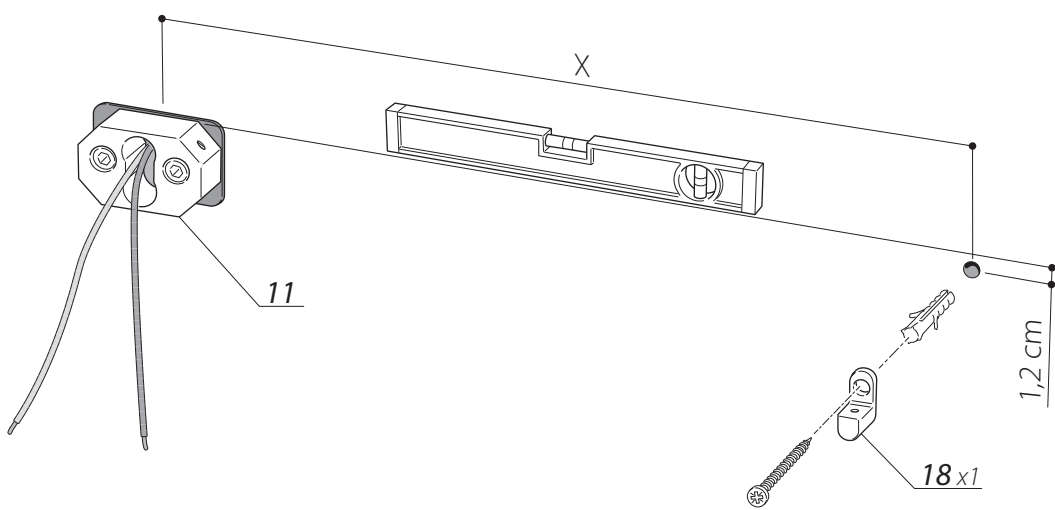
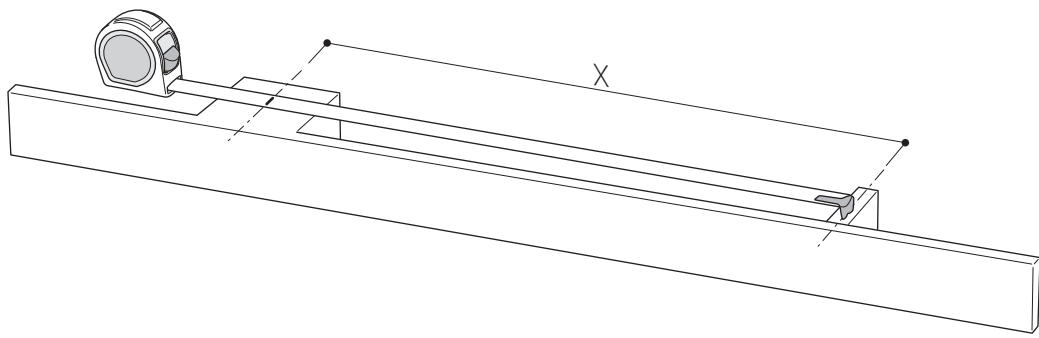

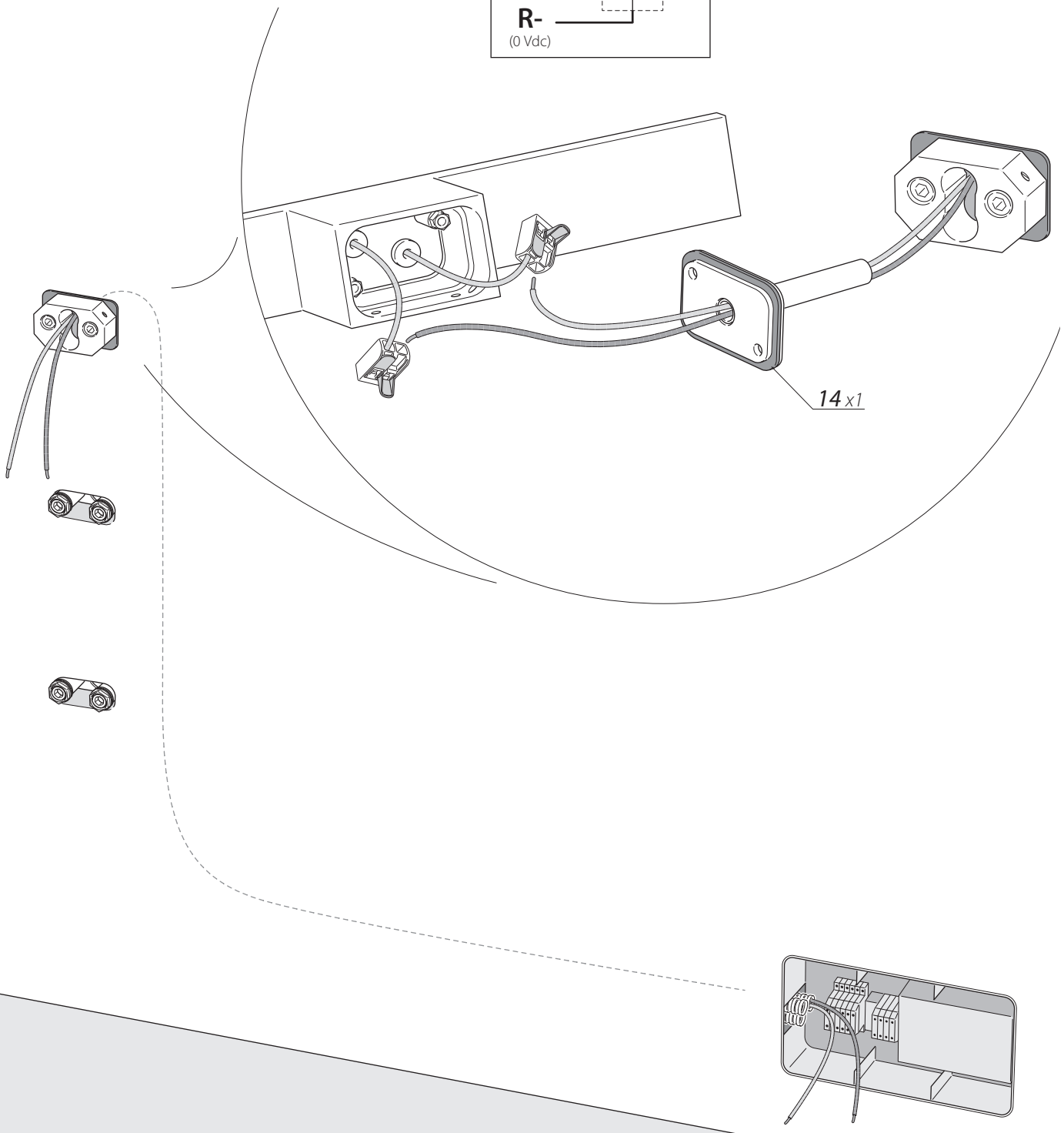
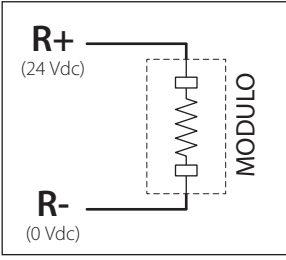

32

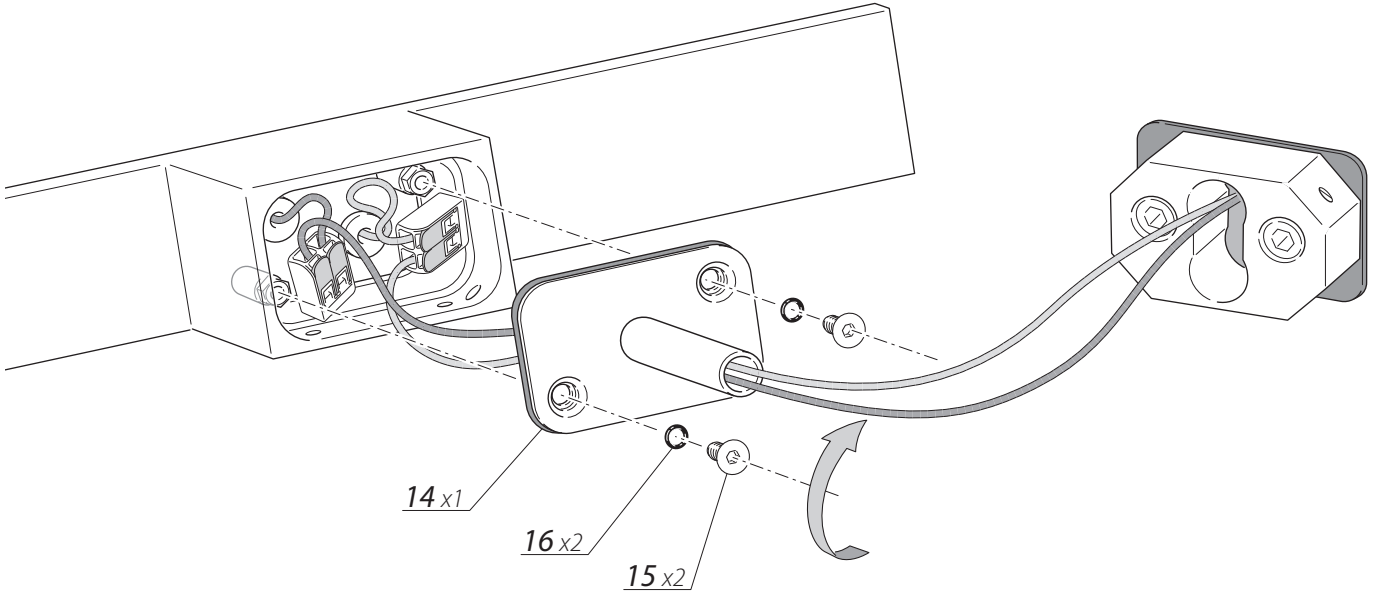

33

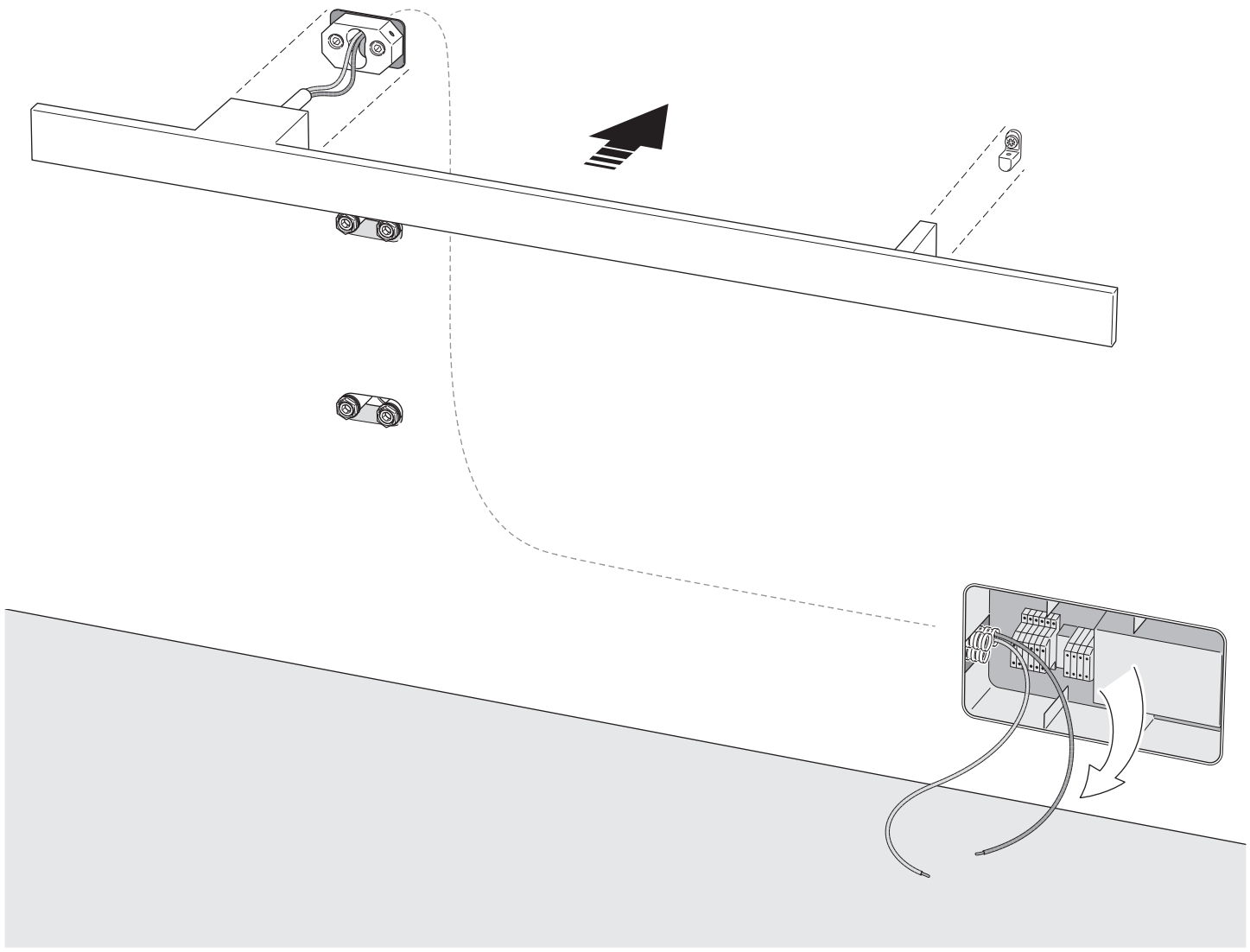

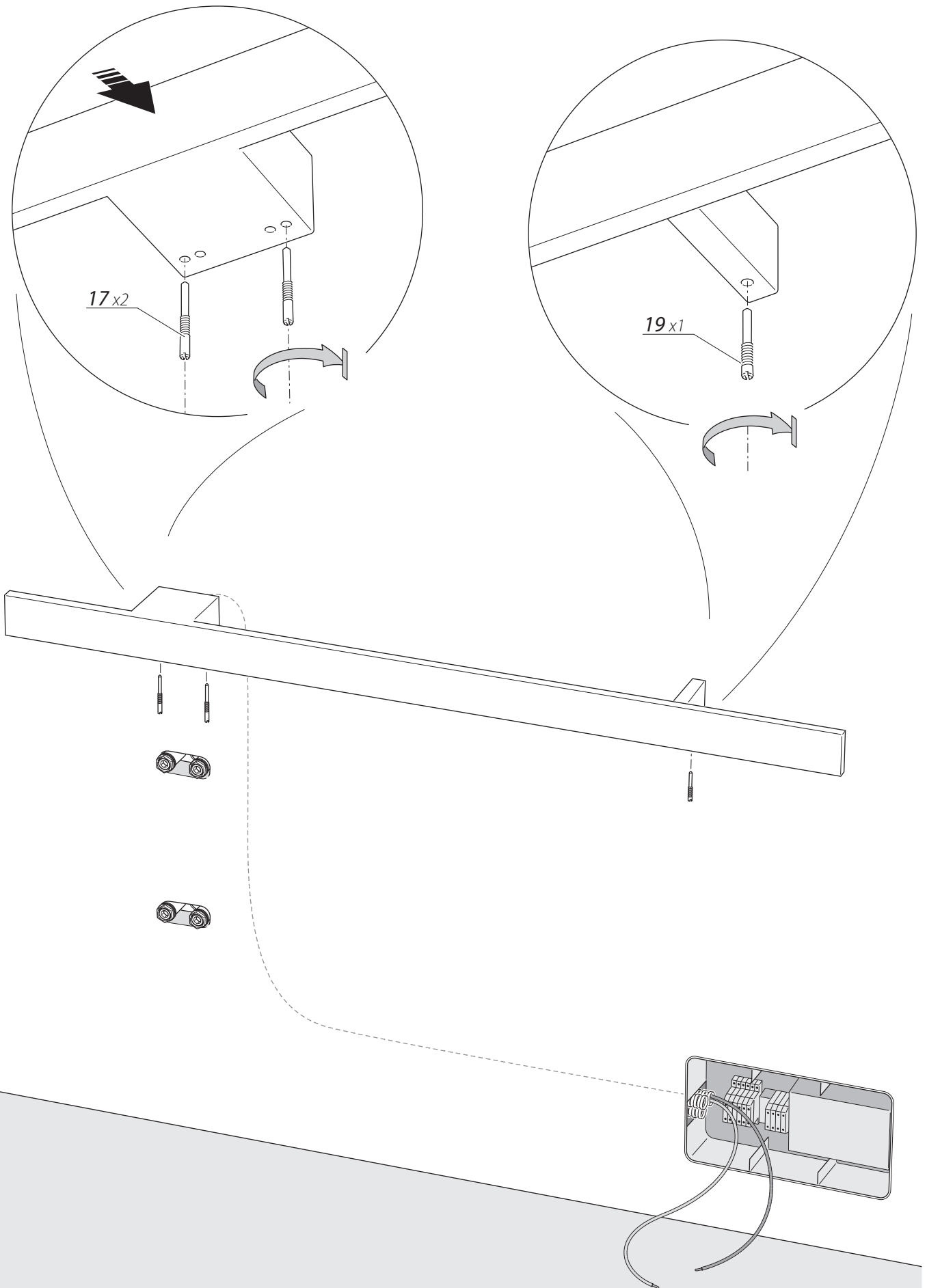

35

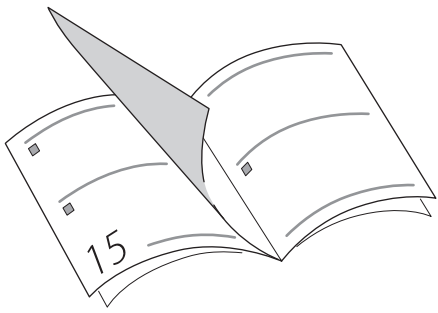

◀ pag 15 26 ÷ 34

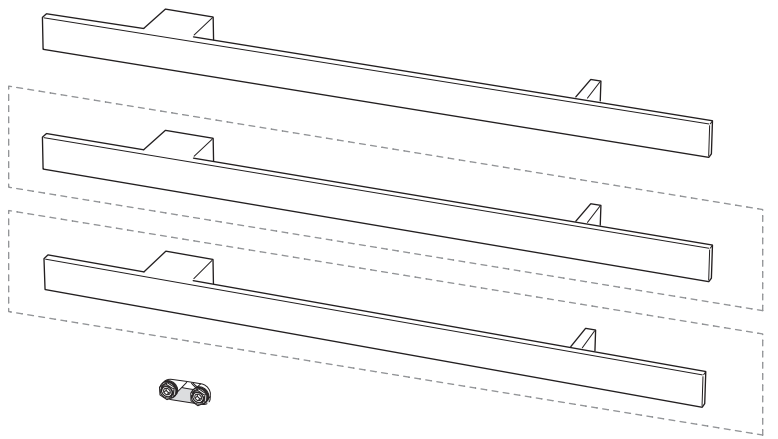

36

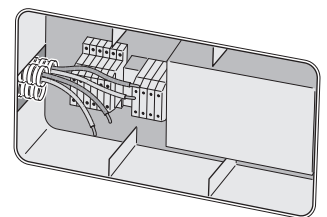
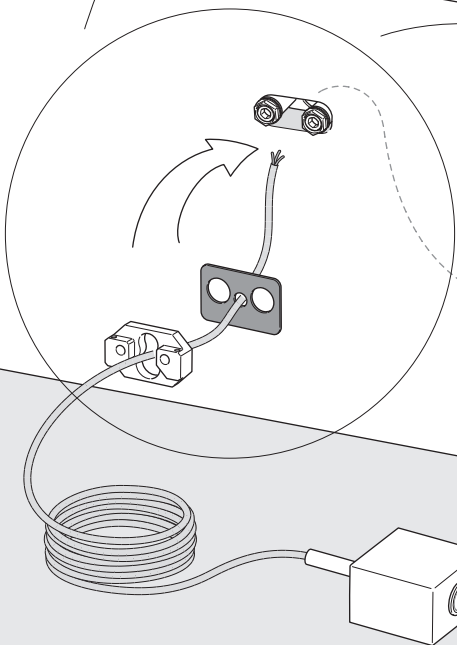
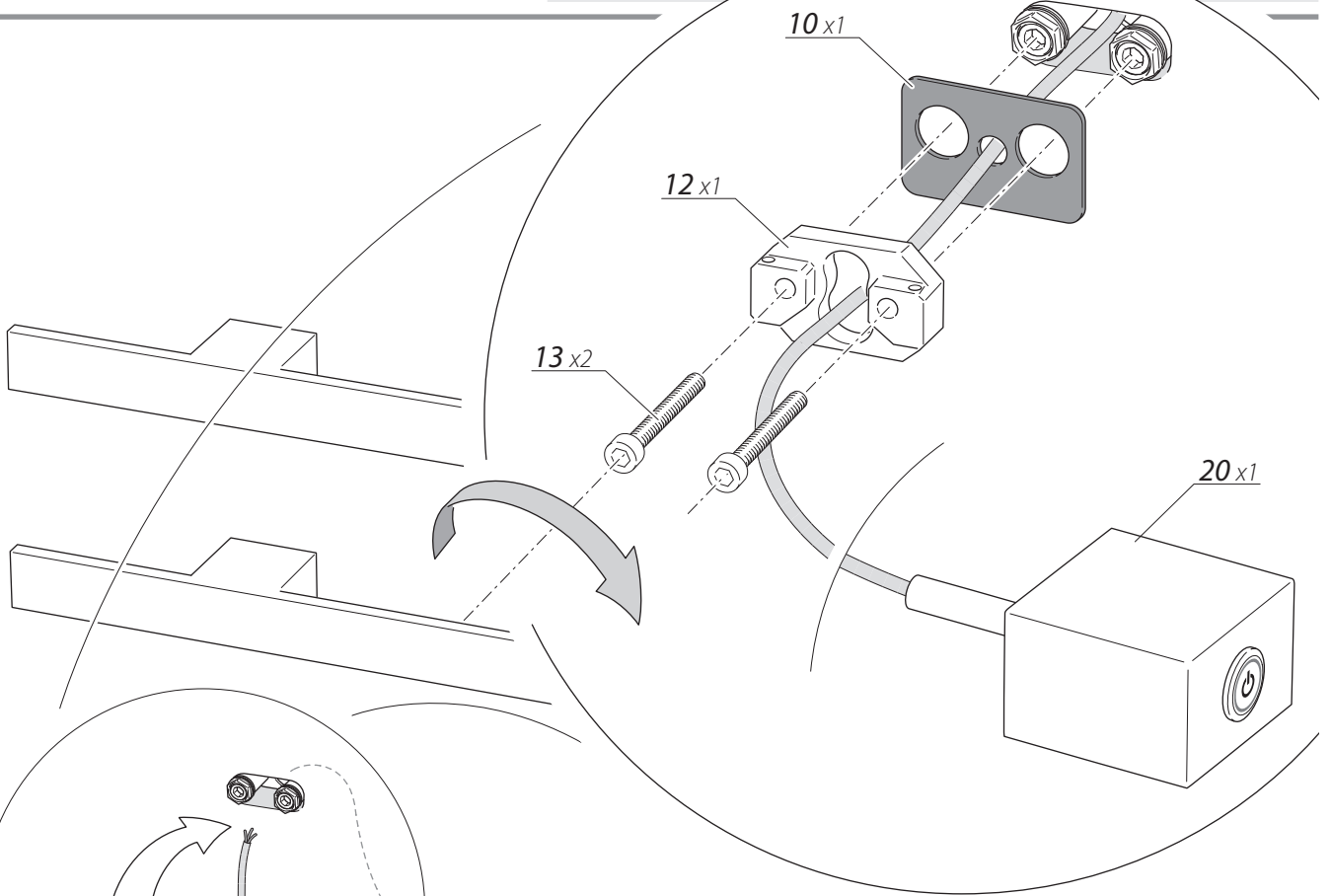

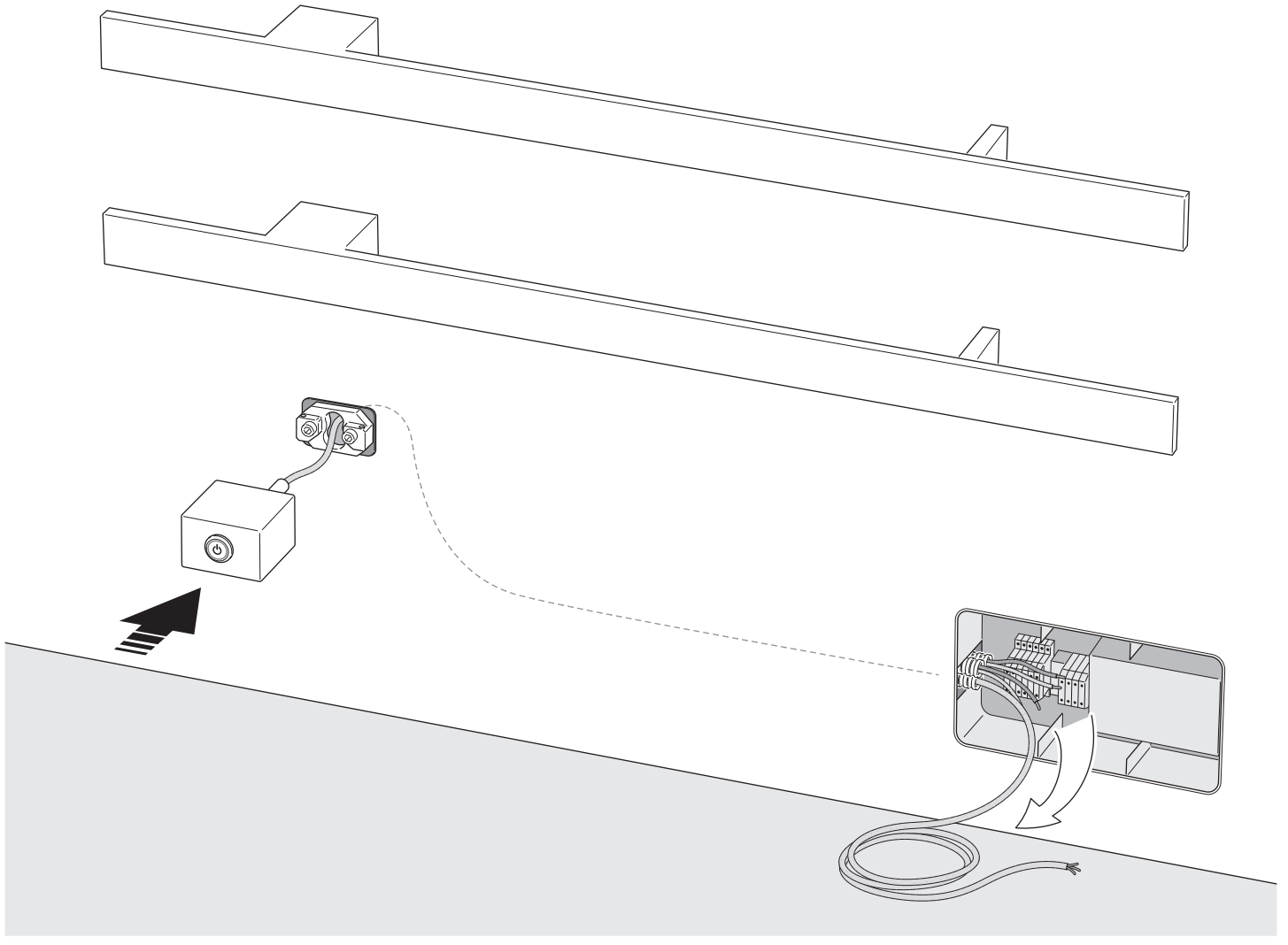

37

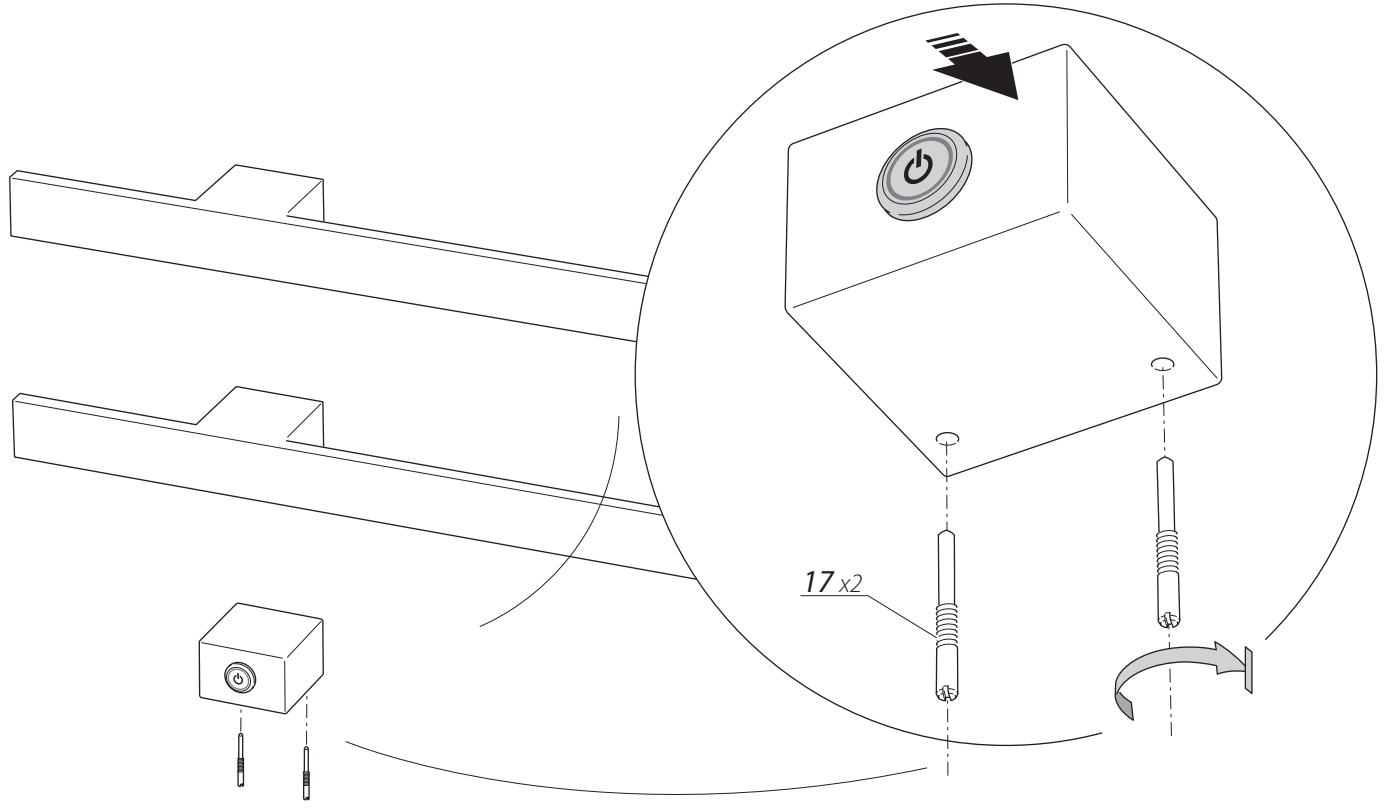

38

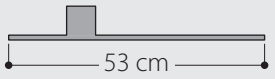
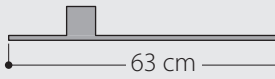

39

	I CHING 53
	I CHING 63
	I CHING 78
	I CHING 135

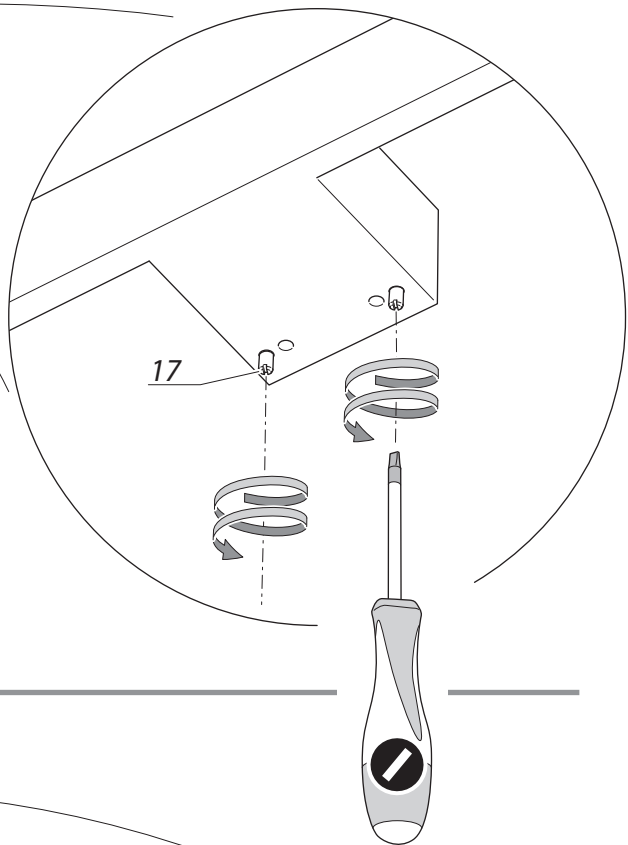
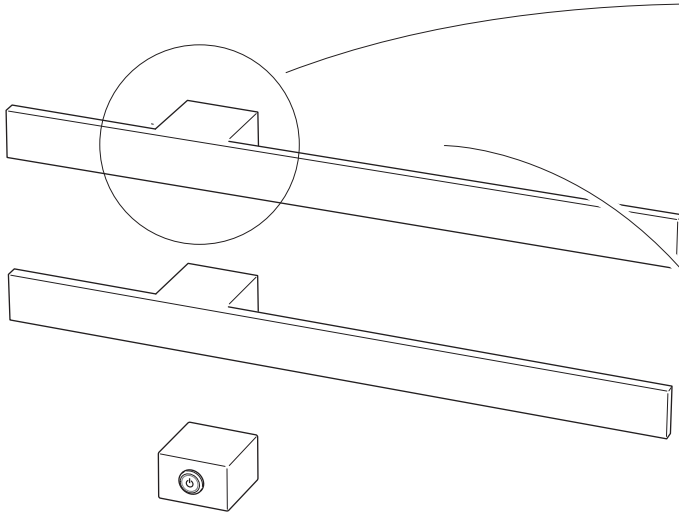
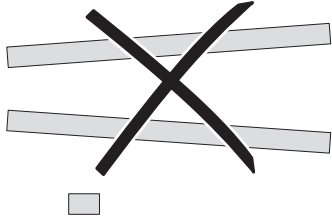

40 I CHING 53, I CHING 63

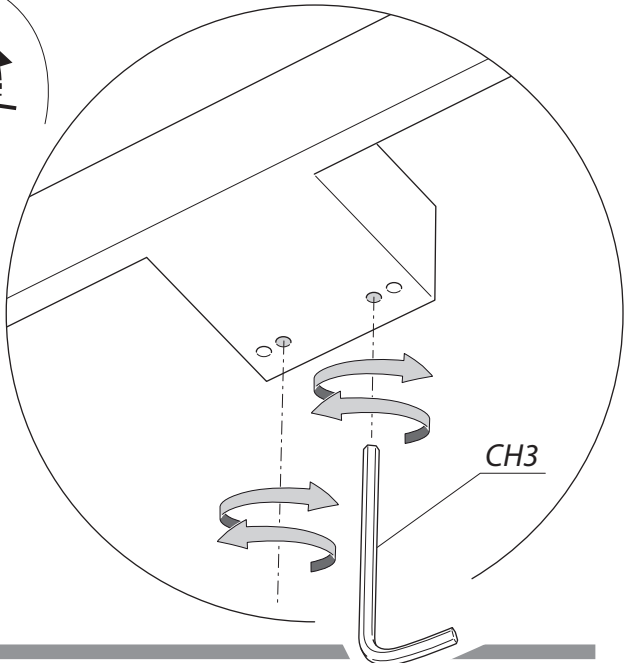
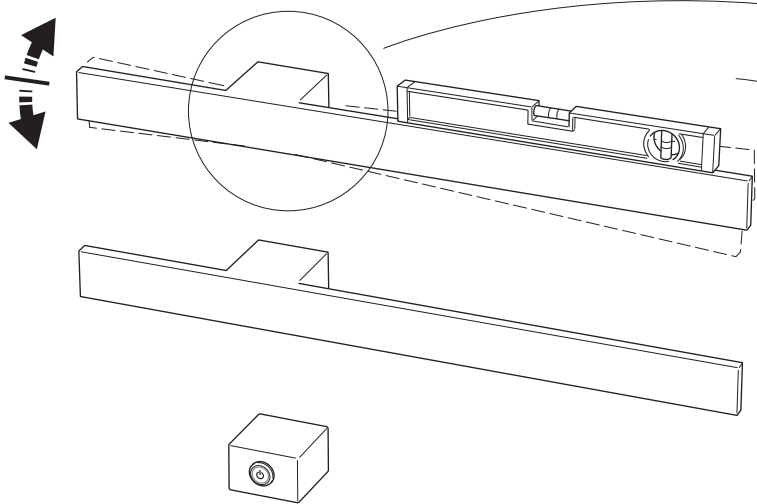

41 | CHING 53, I CHING 63

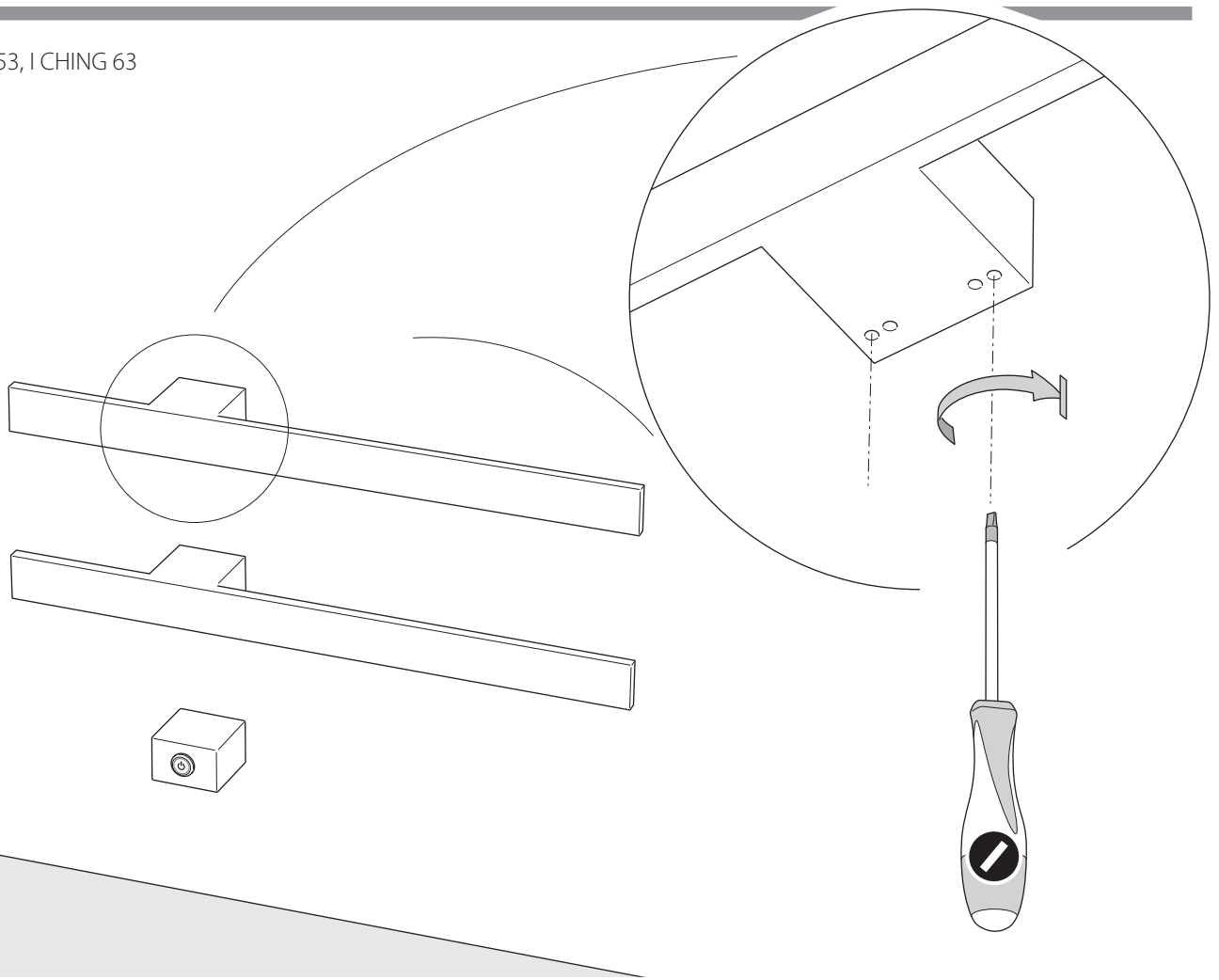

42 | CHING 53, I CHING 63

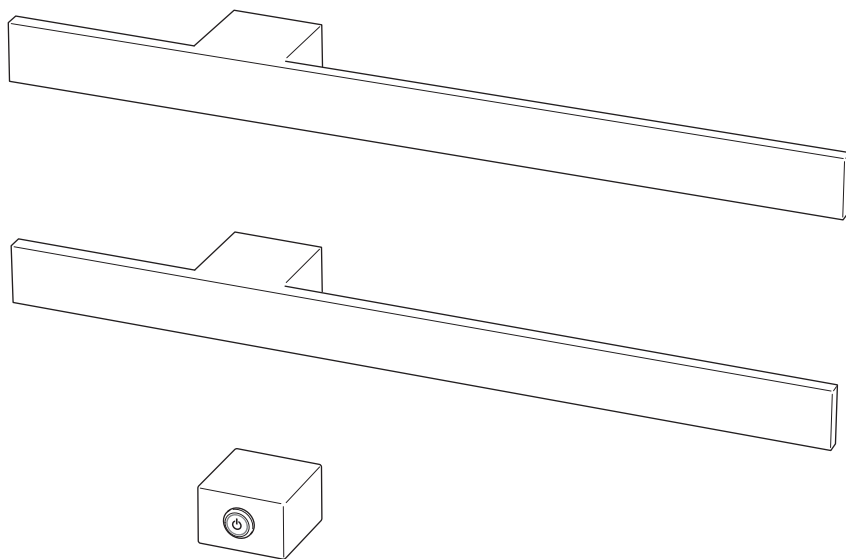

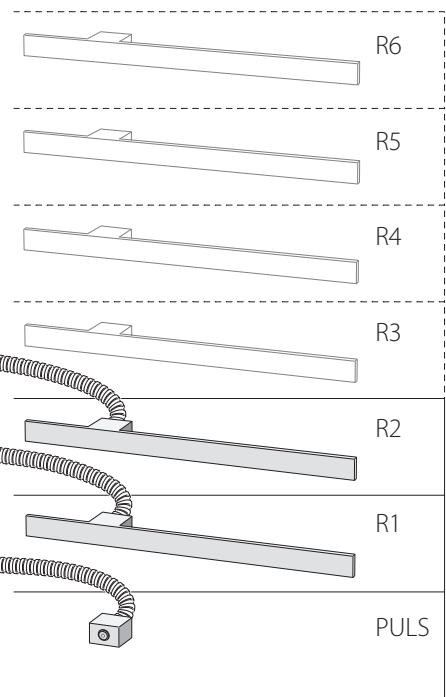
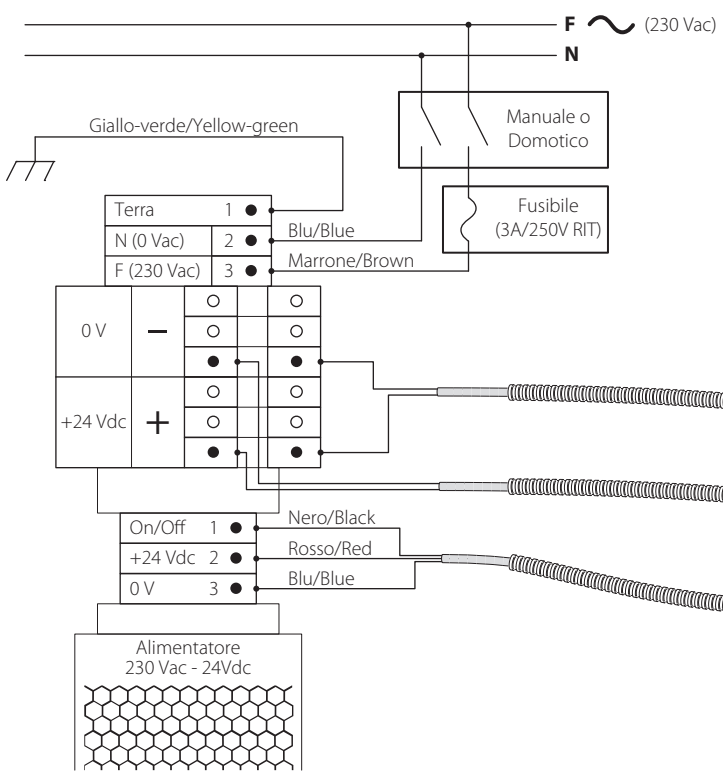
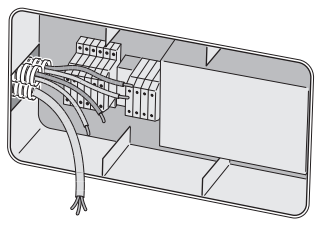
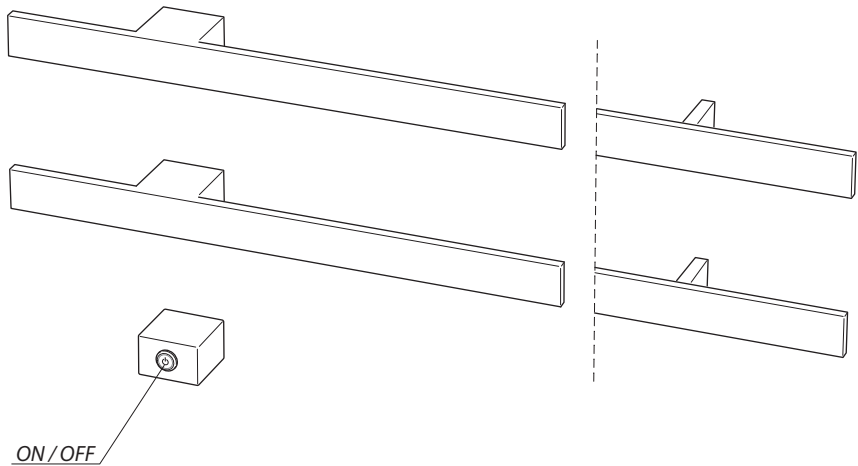

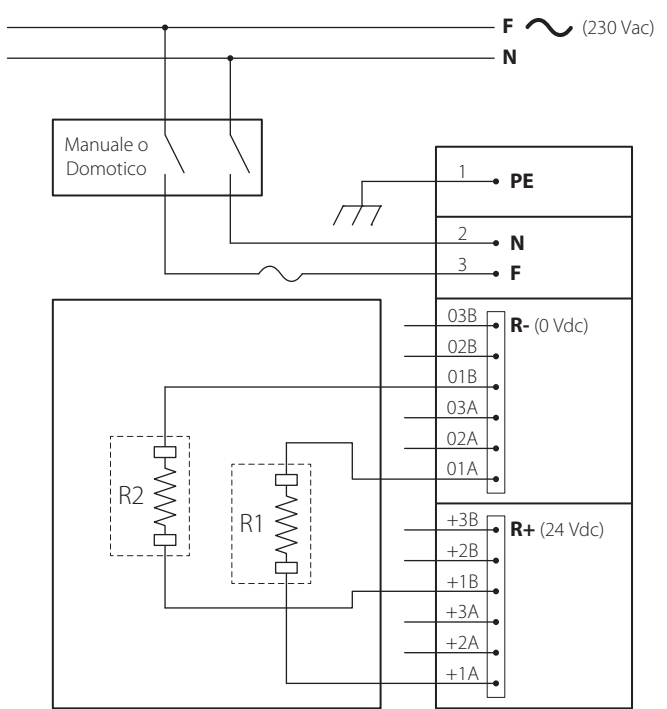
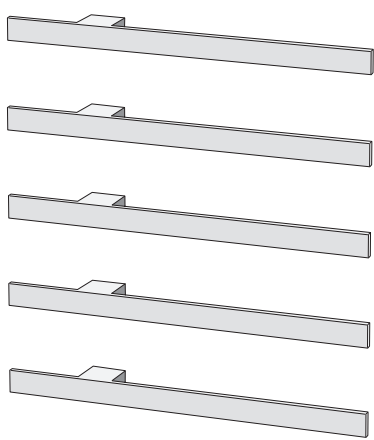
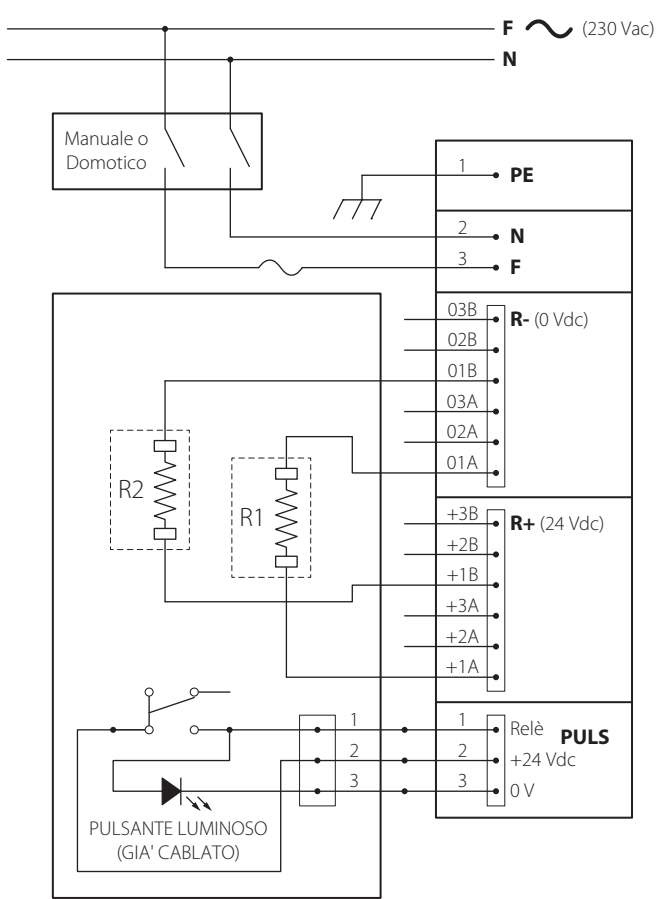
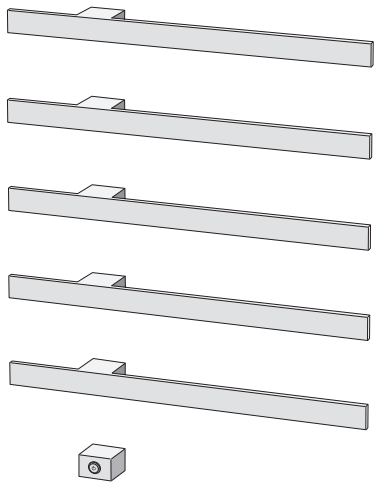

45

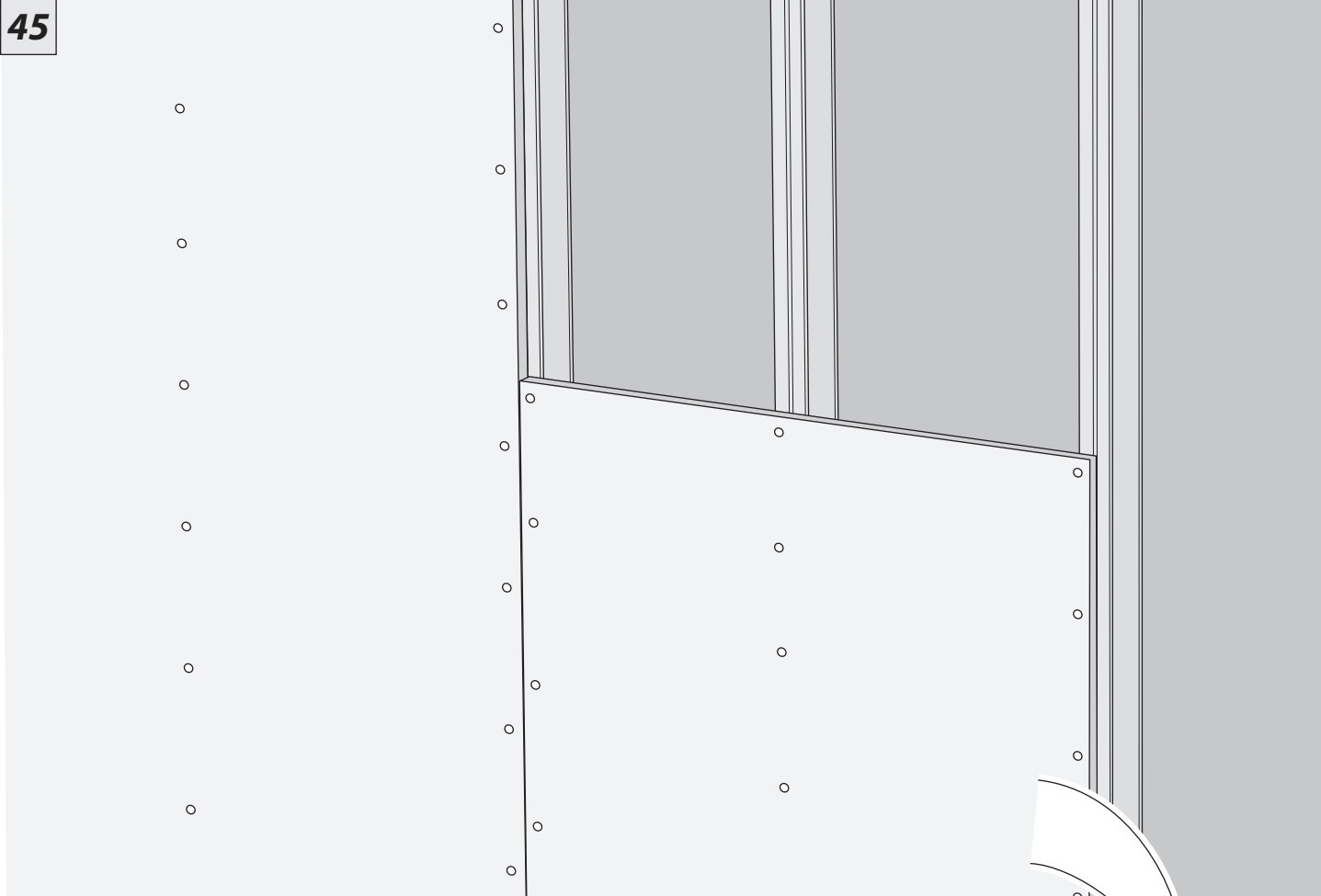

46

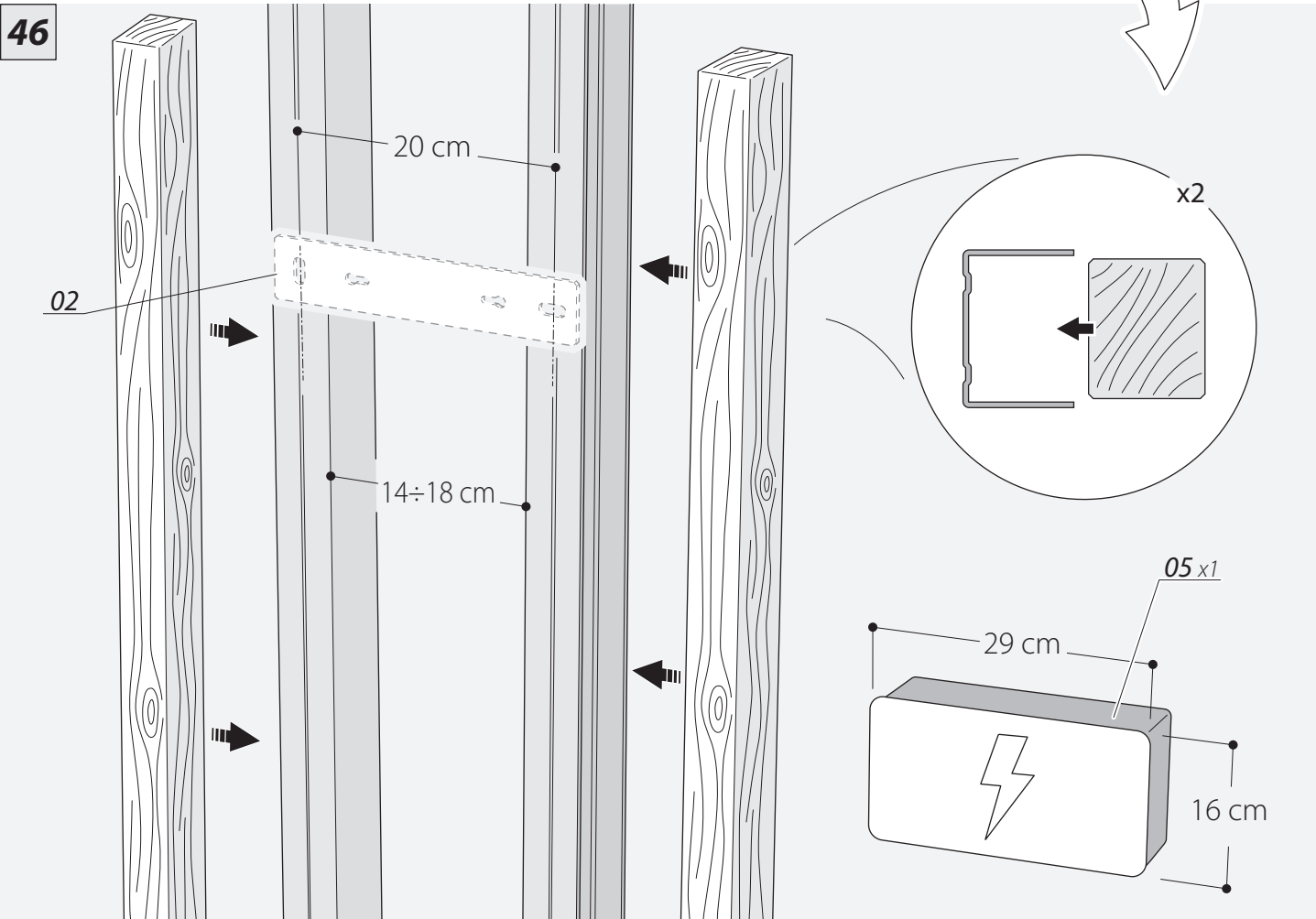

47

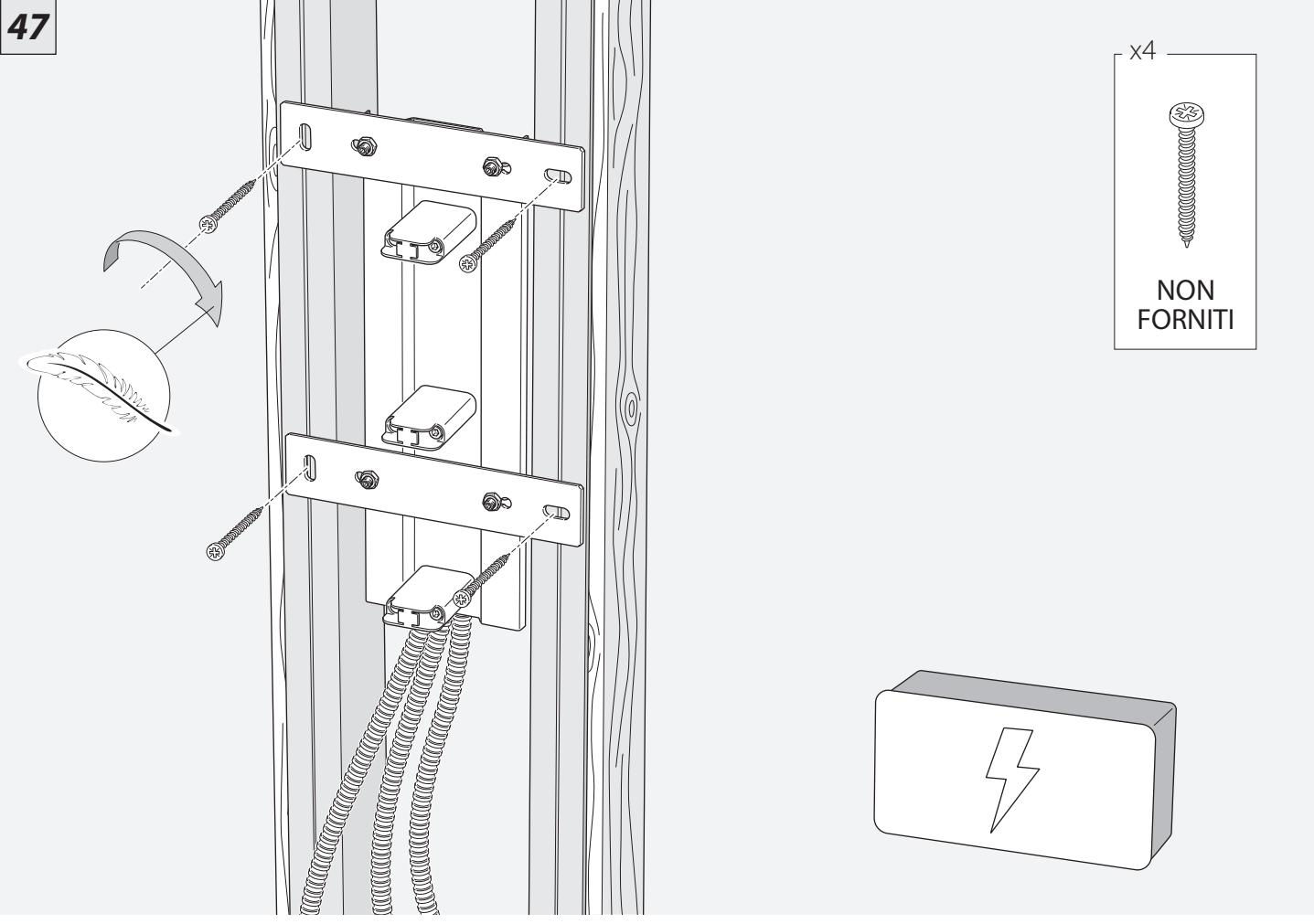

48

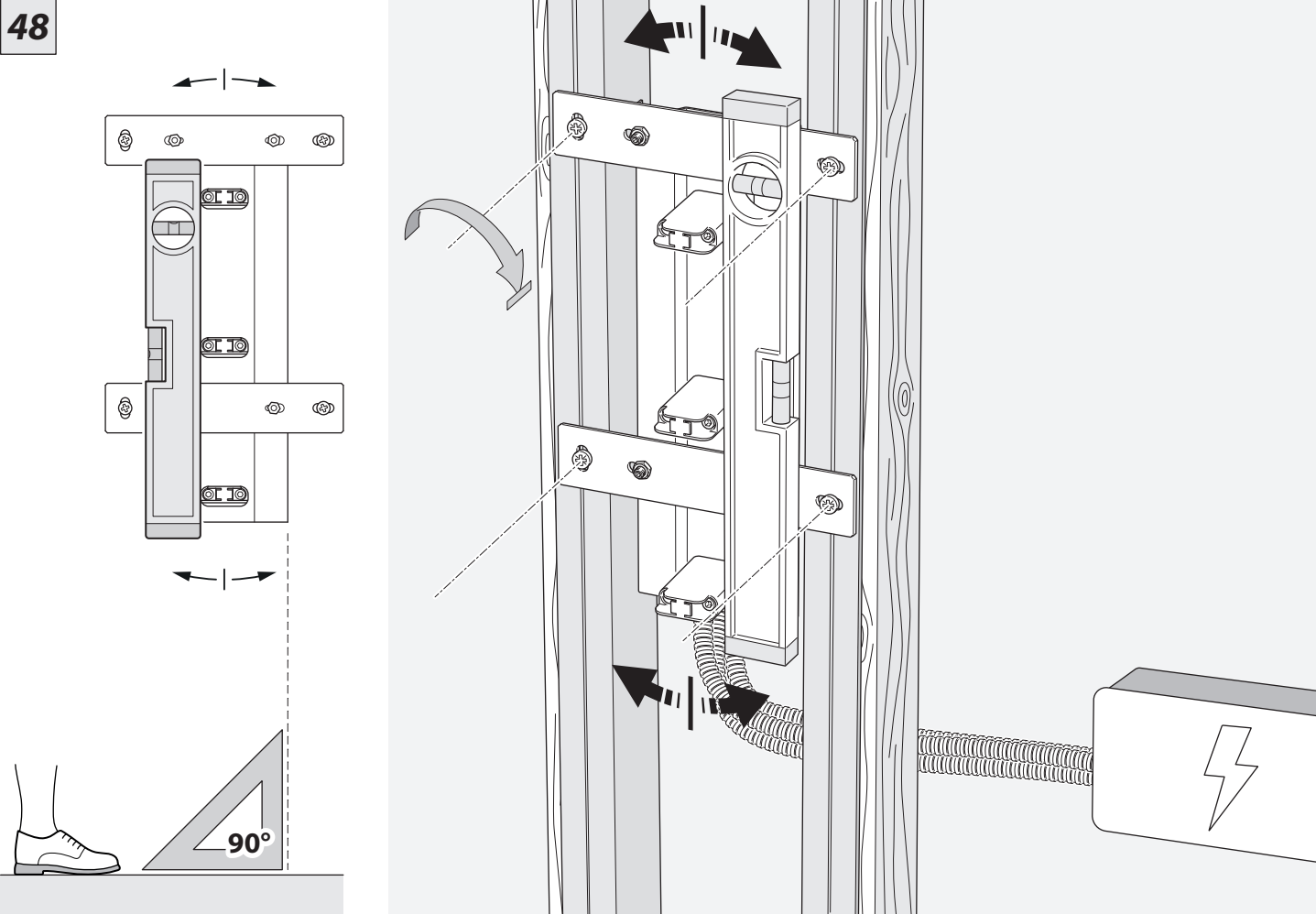

49

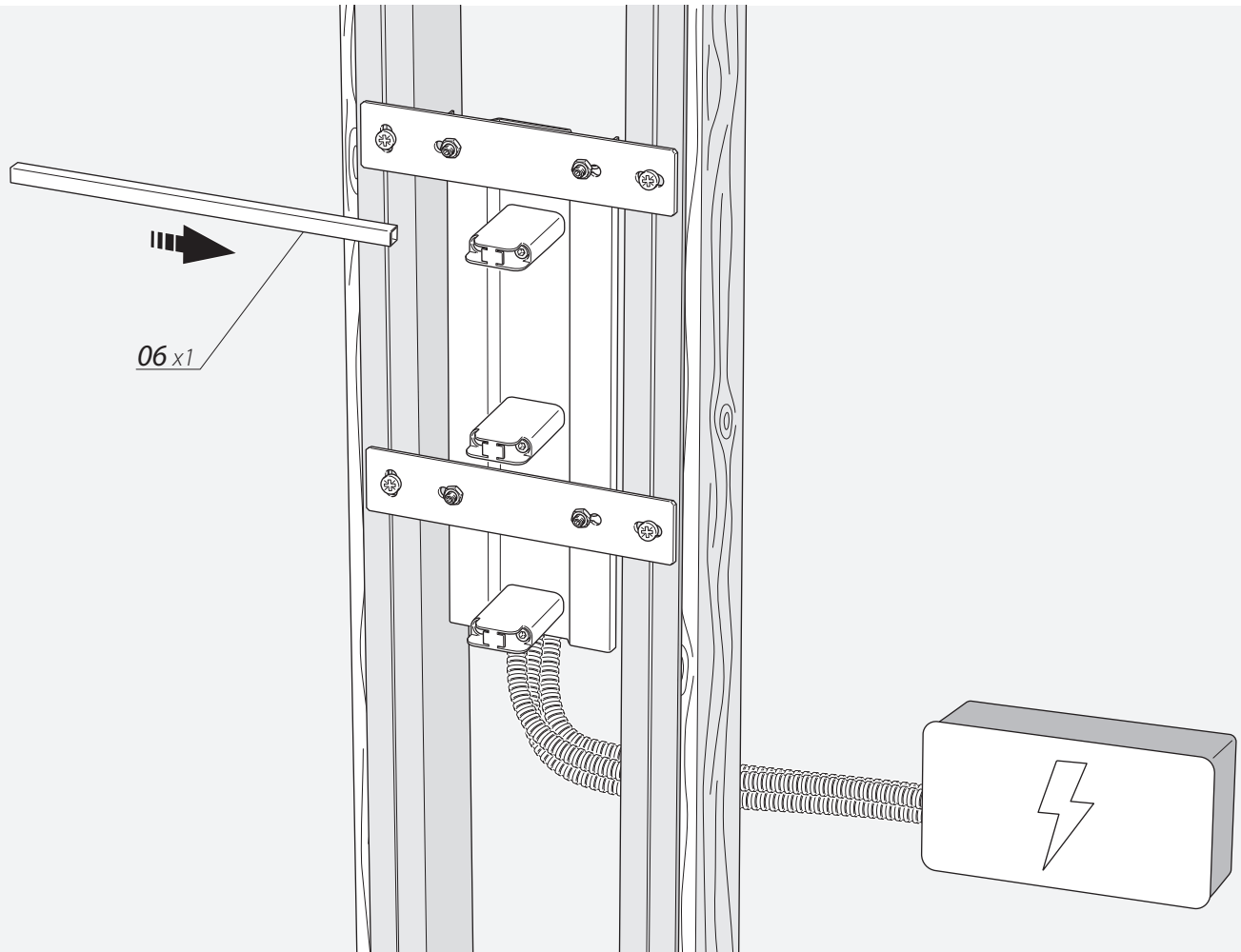

50

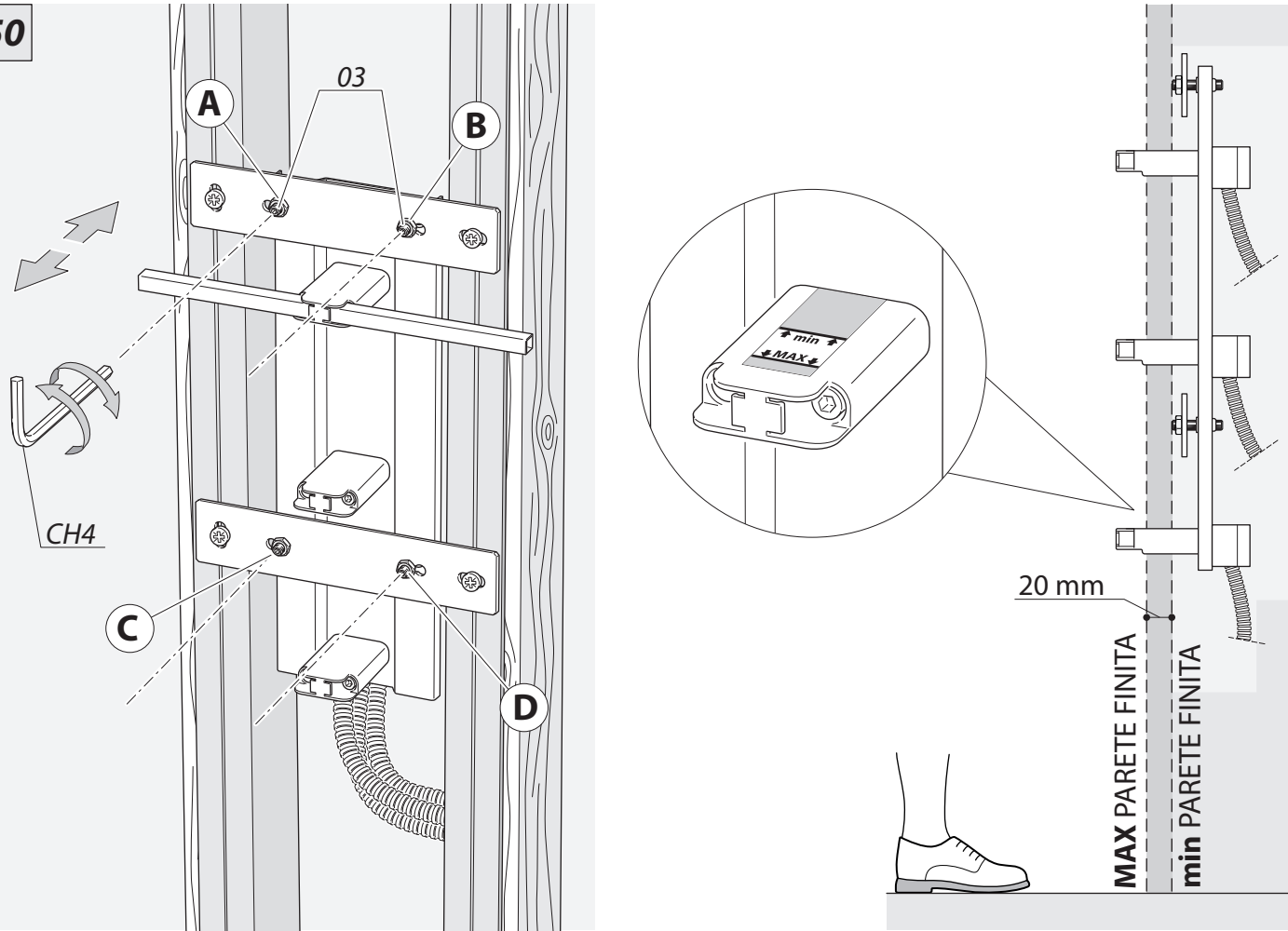

51

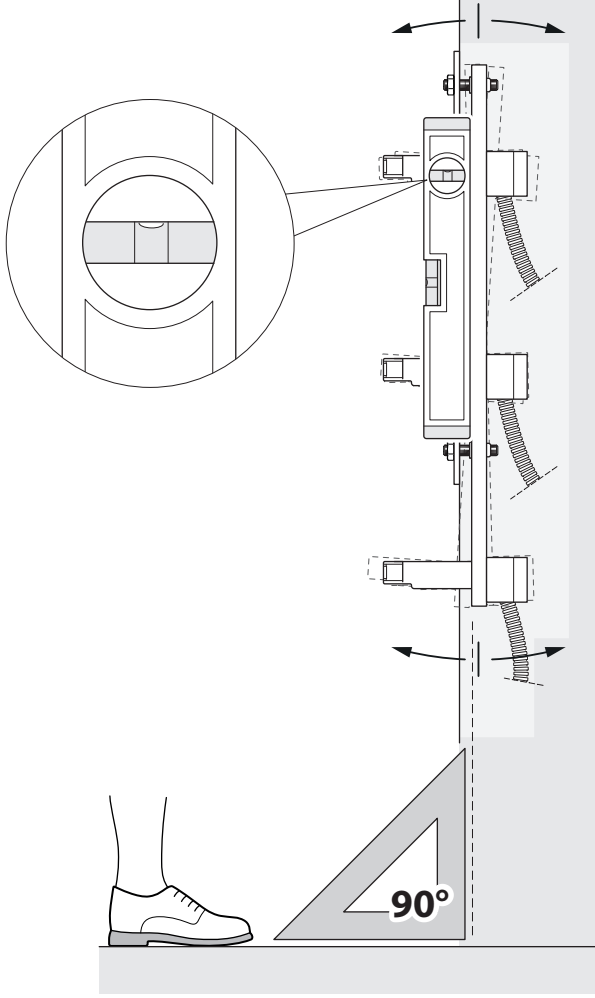
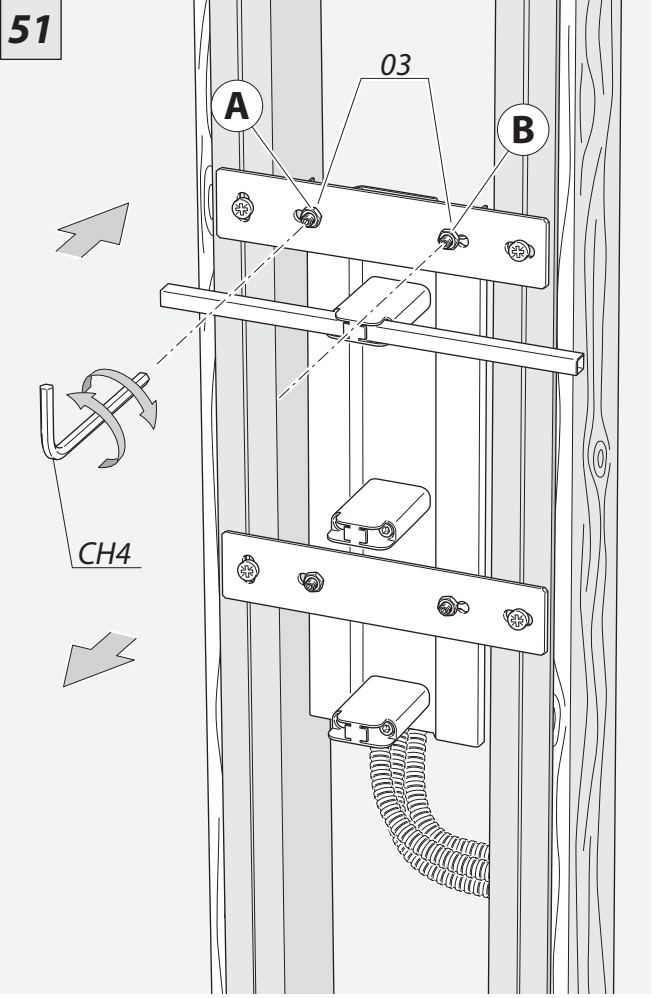

52

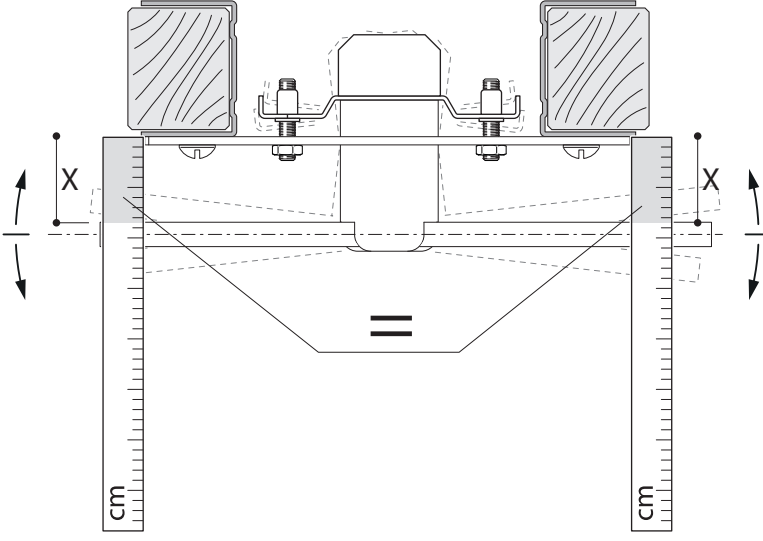
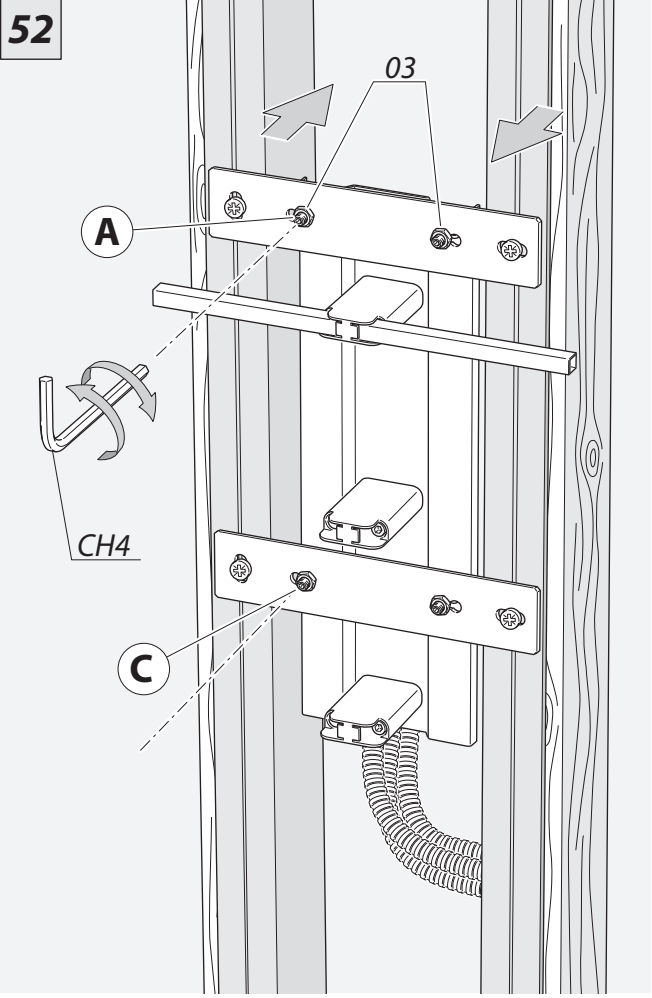

53

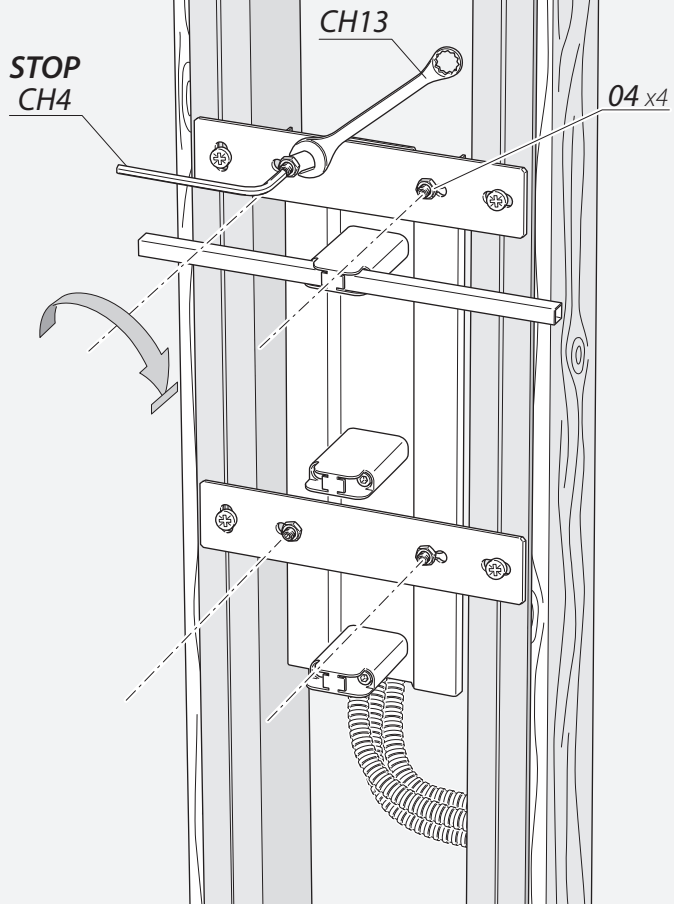

54

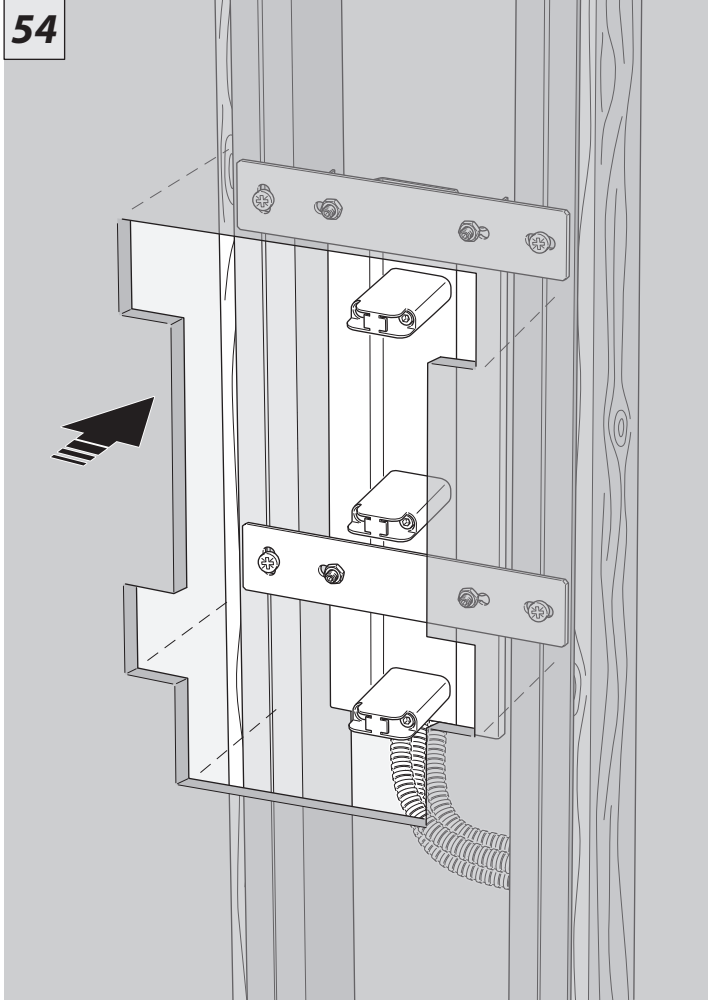

55

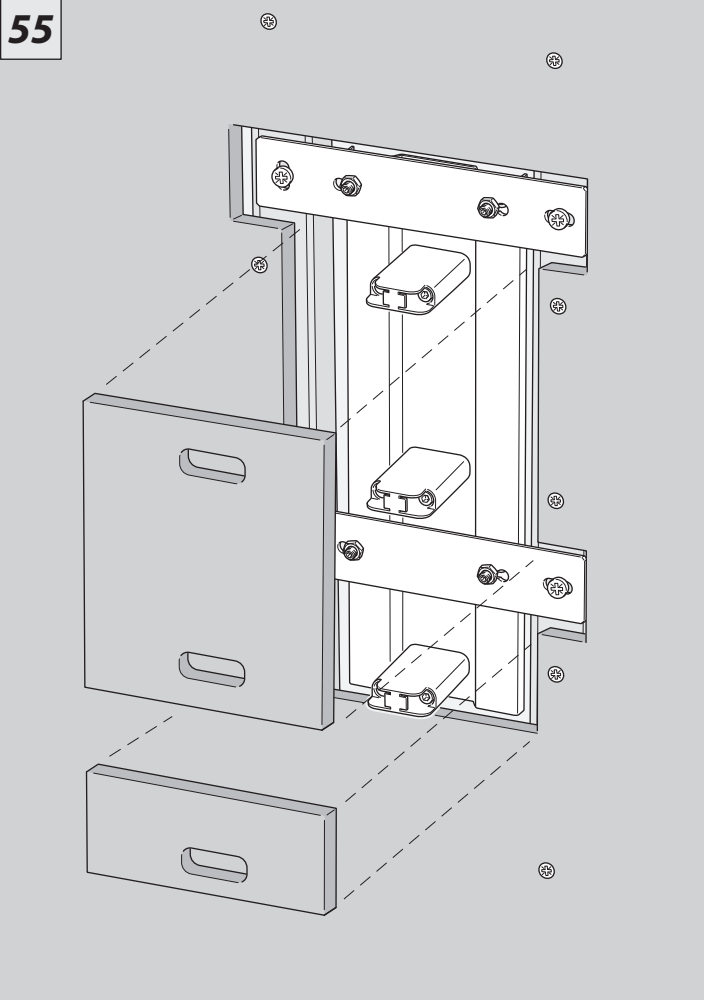

56

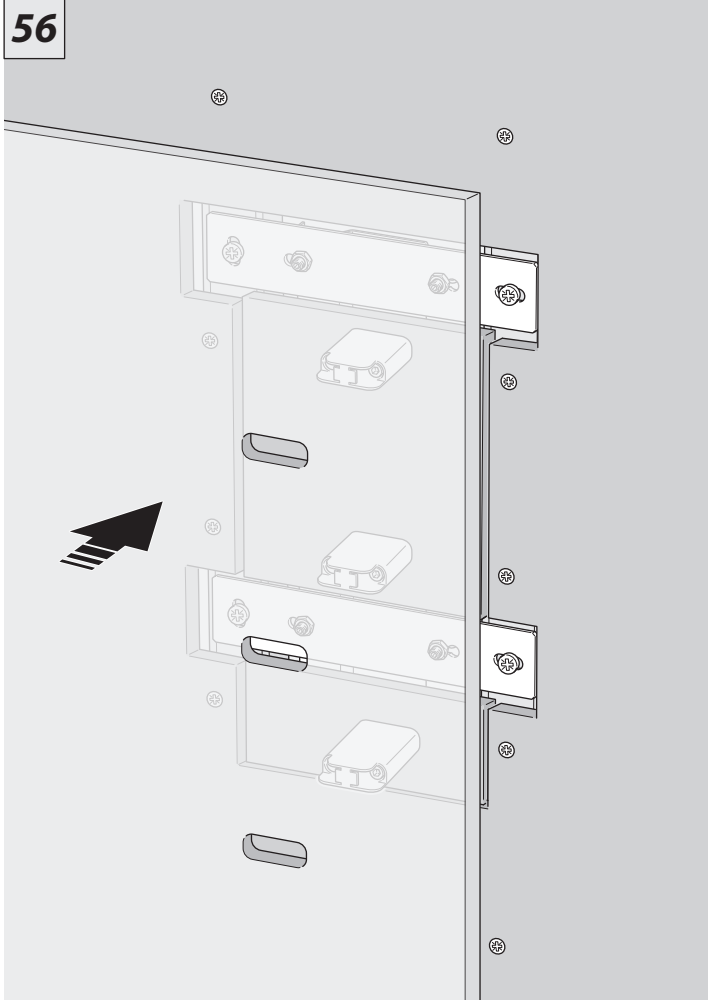

57

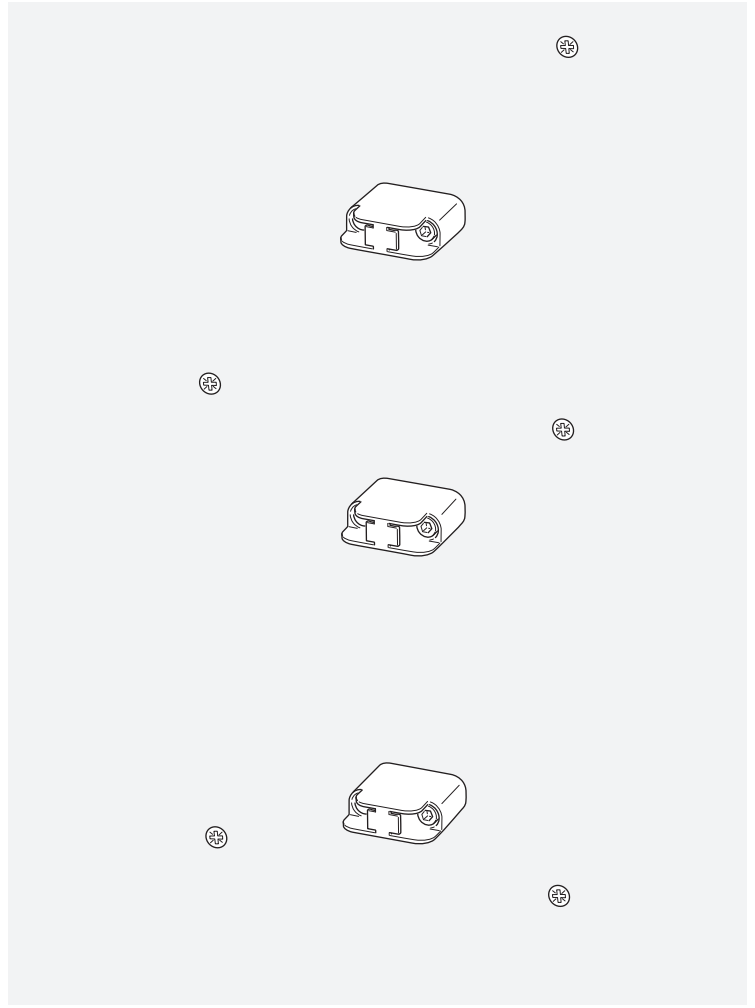
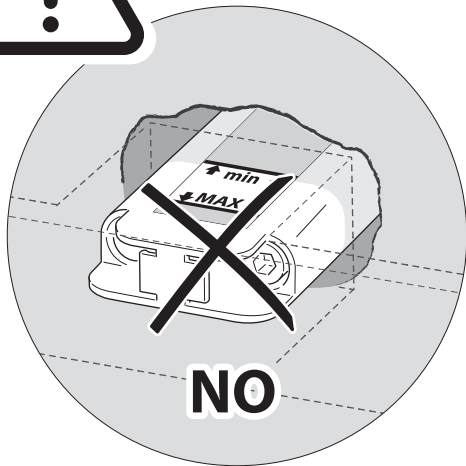
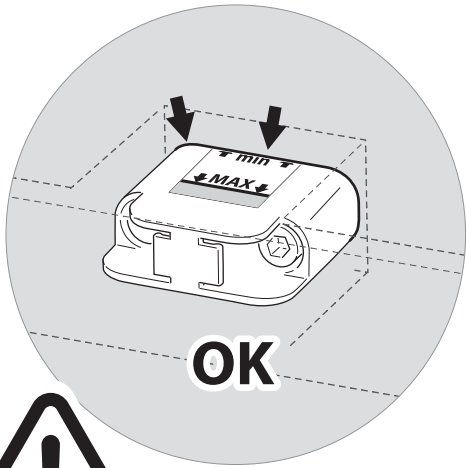

58

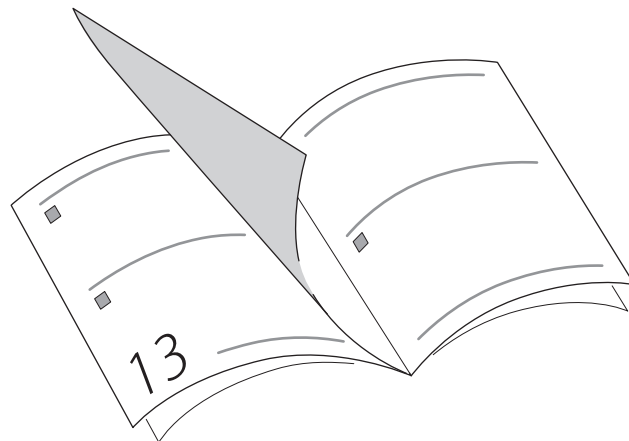

◀ pag 13 19

IT_CONSIGLI PER LA PULIZIA DI I-CHING

Le garanzie sugli articoli TUBES RADIATORI decadono se i prodotti sono danneggiati a causa di uso o manutenzione non corretti o impropri. È necessaria e sufficiente una pulizia quotidiana con un panno umido. La pulizia può essere effettuata con acqua, sapone neutro o detergente a PH neutro. Particolari finiture galvaniche, soggette a impronte, possono essere pulite con un panno in microfibra umido. Non spruzzare mai detersivi direttamente sulle superfici, spruzzare sempre il detersivo su un panno o altro materiale idoneo. Dopo aver utilizzato i detersivi, risciacquare abbondantemente la superficie con acqua. Residui di detersivo non risciacquati con acqua potrebbero danneggiare la superficie.

Non utilizzare mai detersivi aggressivi, polvere abrasiva, lana d'acciaio, spazzole d'acciaio o altri abrasivi. Si sconsiglia l'uso di detersivi come alcool e candeggina, in quanto potrebbero causare scolorimento della superficie. I detersivi clorurati possono causare corrosione. Non utilizzare polvere abrasiva o altri prodotti abrasivi poiché potrebbero influire sulla struttura della superficie.

EN_TIPS FOR CLEANING I-CHING

TUBES RADIATORI warranties are invalidated if the products are damaged due to incorrect or improper use or maintenance.

Daily cleaning with a damp cloth is sufficient. The cleaning can be carried out with water, neutral soap or PH neutral detergent. Any special galvanised finishes, subject to fingerprints, can be cleaned with a damp microfibre cloth.

Never spray detergents straight onto surfaces; always spray the detergent onto a cloth or other suitable material. After using detergents, rinse the surface with plenty of water. Residual detergent not rinsed with water could damage the surface.

Never use aggressive detergents, abrasive powder, steel wool, steel brushes or other abrasives. It is not recommended to use alcohol or bleach as detergents as they could cause the surface to fade. Chlorinated detergents can cause corrosion. Do not use abrasive powder or other abrasive products as they could affect the structure of the surface.

FR_conseils d'entretien POUR I-CHING

Les garanties sur les articles TUBES RADIATORI sont annulées si les produits sont endommagés en raison d'une utilisation ou d'un entretien incorrect ou non approprié.

Un essuyage quotidien avec un chiffon humide est nécessaire et suffisant. Le nettoyage peut être fait avec de l'eau, du savon doux ou détergent au PH neutre. Les finitions spéciales galvaniques, sujettes aux empreintes digitales, peuvent être nettoyées avec un chiffon humide en microfibre.

Ne vaporisez jamais de détergents directement sur les surfaces, vaporisez toujours le détergent sur un chiffon ou autre tissu approprié. Après l'utilisation des détergents, rincer la surface abondamment avec de l'eau. Les résidus de détergents qui ne sont pas rincés avec de l'eau peuvent causer des dommages à la surface.

N'utilisez jamais de détergents agressifs, de poudre à récurer, de laine d'acier, de brosse en acier ou autres abrasifs. Nous ne recommandons pas l'utilisation de détergents comme l'alcool et l'eau de Javel, car ils peuvent provoquer une décoloration de la surface. Les détergents chlorés peuvent causer une corrosion. La poudre à récurer ou autres produits abrasifs ne doivent pas être utilisés car elles affecteront la structure de la surface.

DE_TIPPS ZUR REINIGUNG VON I-CHING

Die Garantie für TUBES RADIATORI-Artikel verfällt, wenn die Produkte aufgrund eines unkorrekten Gebrauchs oder unsachgemäßer Wartung beschädigt werden.

Zur täglichen Reinigung ist ein feuchtes Tuch erforderlich und ausreichend. Die Reinigung kann mit Wasser, Neutralseife oder einem PH-neutralen Reinigungsmittel erfolgen. Spezielle galvanisierte Oberflächen, auf denen Fingerabdrücke zurückbleiben, können mit einem feuchten Mikrofaser Tuch gereinigt werden.

Sprühen Sie Reinigungsmittel nie direkt auf die Oberfläche. Das Reinigungsmittel ist stets auf ein Tuch oder auf anderes geeignetes Material zu sprühen. Nachdem Reinigungsmittel verwendet wurden, ist die Oberfläche mit reichlich Wasser abzuwischen. Nicht mit Wasser entfernte Reinigungsmittelreste könnten die Oberfläche beschädigen.

Verwenden Sie keine aggressiven Reinigungsmittel, Scheuerpulver, Stahlwolle, Stahlbürsten oder andere Scheuermittel. Von der Verwendung mit Reinigungsmitteln, wie Alkohol und Bleichmitteln, wird abgeraten, da sie das Verblässen der Oberfläche verursachen könnten. Chlorhaltige Reinigungsmittel können Korrosion verursachen. Verwenden Sie kein Scheuerpulver oder andere Scheuermittel, da sie die Oberflächenstruktur beeinträchtigen können.

FR_CONSEJOS DE LIMPIEZA PARA I-CHING

Las garantías de los artículos TUBES RADIATORI caducan si los productos se deterioran debido a un uso o un mantenimiento incorrecto o inadecuado.

La limpieza diaria con un paño húmedo es necesaria y suficiente. La limpieza se puede realizar con agua, jabón neutro o detergente con pH neutro. Los acabados galvánicos especiales, sujetos a huellas dactilares, se pueden limpiar con un paño de microfibra húmedo.

No pulverizar nunca detergentes directamente sobre las superficies, pulverizar primero el detergente sobre un paño u otro material adecuado. Después de usar los detergentes, enjuagar bien la superficie con abundante agua. Los residuos de detergente que no se enjuaguen con agua podrían dañar la superficie.

No utilizar nunca detergentes agresivos, polvos abrasivos, estropajos de acero, cepillos de acero u otros abrasivos. No recomendamos el uso de detergentes como alcohol y lejía, ya que podrían decolorar la superficie. Los detergentes clorados pueden provocar corrosión. No utilizar polvo abrasivo u otros productos abrasivos ya que podrían influir sobre la estructura de la superficie.

Security areas

Elements and the Basics collections are in CLASS 2 with a double insulation.

Requirements:

- Out of shower volume
- Out of tub volume

What are the bathroom zones?

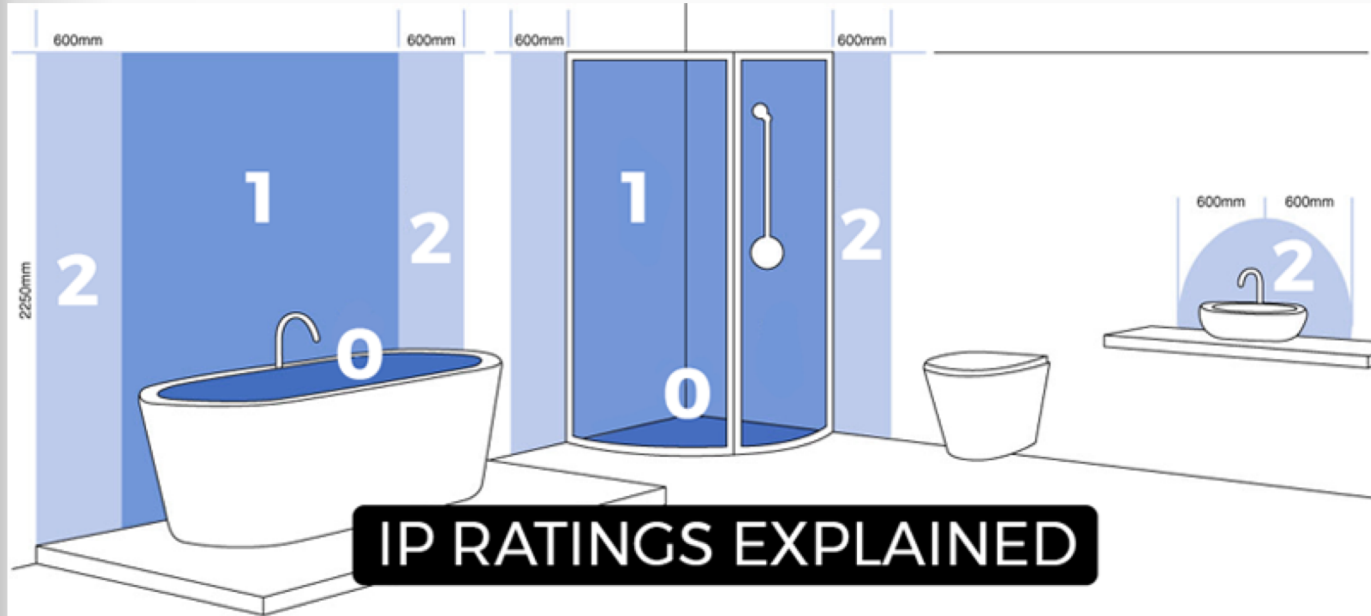

IP RATINGS EXPLAINED

ZONE 0

Requires a minimum of IPX7.
(Only 12v SELV can be used)
Area: Inside bath & tray

ZONE 1

Requires a minimum of IPX4.
Area: Above bath & inside enclosure

ZONE 2

Requires a minimum of IPX4.
Area: Outside of bath and shower zone

Zone 3 is anywhere outside of those limits away from water use

Security areas

Examples of proper placement of electrical products inside the bathroom



Speronari Suites, Milano, di Angus Fiori Architects



La Mourra Hotel, Francia, di Beatrice Cerboneschi

All resistances models from Tubes' Basics and Elements collections are in Class 2

Security areas

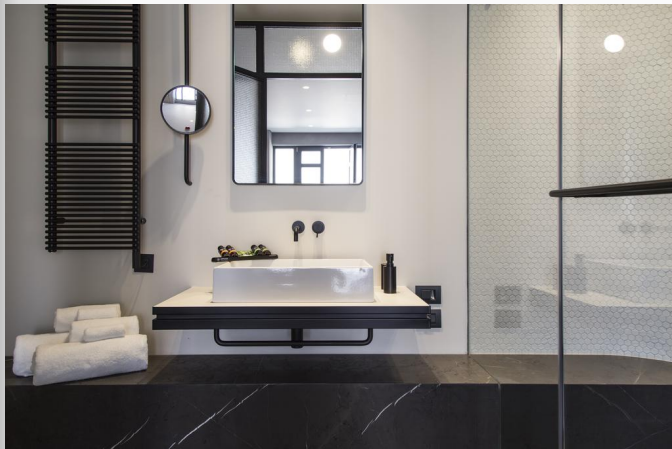

Hotel Perianth, Atene, di K-Studio



Elegia della Luce, Bari, di Laboratorio di Architettura e Design



Palazzo di Varignana, Bologna



Villetta privata, Brescia, di Studio Prince

Examples of proper placement of electrical products inside the bathroom